

REV.	ECN. NO.	APPD.
A		

NOTES:  
 Current Rating:3.0AMP  
 Contact Resistance:20mΩ max  
 Withstand Voltage:500V AC/DC  
 Insulation Resistance:1000MΩ min  
 Operation Temperature:-40°C to +105°C

Contact Material:Brass  
 Contact plating:Au or Sn Over Ni  
 Insulator Material:PBT or PA6T+30%GF(UL94V-0)

Recommended P.C.B Layout(Top Side)  
 (PCB BOARD TOLERANCE±0.05)

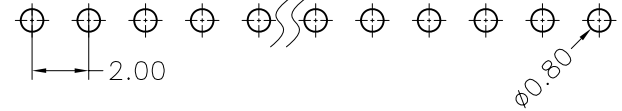
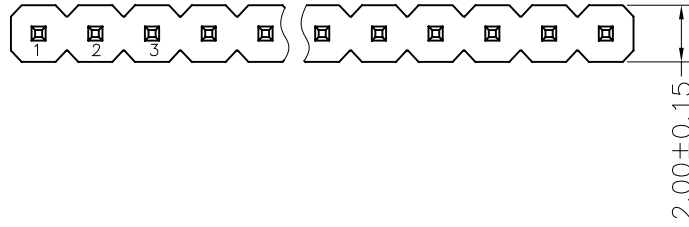

**MTP220-11XXS1**

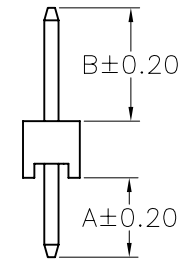
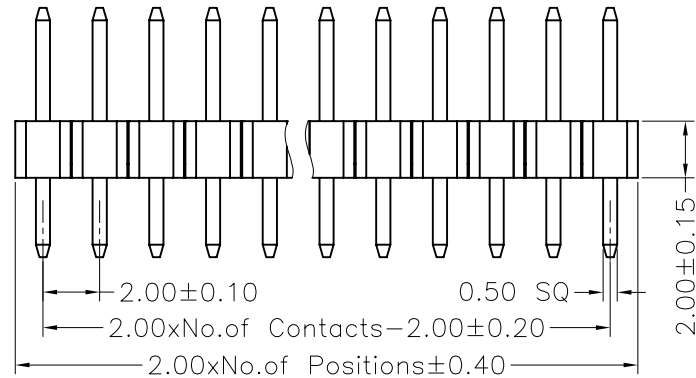
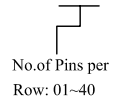

Dimension antitheses list		
ITEM	A	B
Standard	2.80	4.00
Alternate		

X. ± 0.30	X.° ± 5°	UNITS mm	NAME(INTENDED USE)	MINTRON CO.,LTD.		
.X ± 0.20	.X° ± 2°				MAT'L	TITLE: MTP220-11XXS1
.XX ± 0.10	.XX° ± 1°				FINISH	
.XXX ± 0.05	.XXX° ± 0.5°				Q'TY	
PIN HEADER CONNECTOR			APPD: SUNNY	DWG NO.:		
			CHKD: LISA			
			DR: ZOE 2006-11-28		SCALE 1/1	
					SHEET 1/1	
				REV. A		