

REV.	ECN. NO.	APPD.
A		

NOTES:  
 Current Rating:3.0AMP  
 Contact Resistance:20mΩ max  
 Withstand Voltage:500V AC/DC  
 Insulation Resistance:1000MΩ min  
 Operation Temperature:-40°C to +105°C

Contact Material:Brass  
 Contact plating:Au or Sn Over Ni  
 Insulator Material:PBT or PA6T+30%GF(UL94V-0)

Recommended P.C.B Layout(Top Side)  
 (PCB BOARD TOLERANCE±0.05)

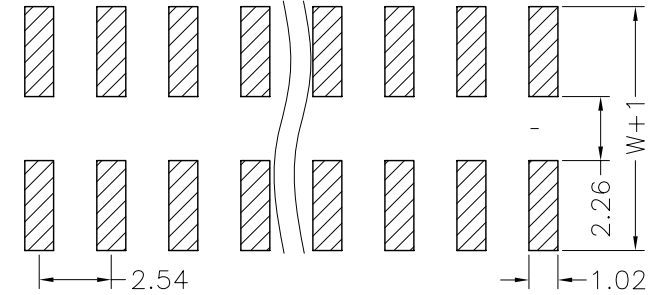
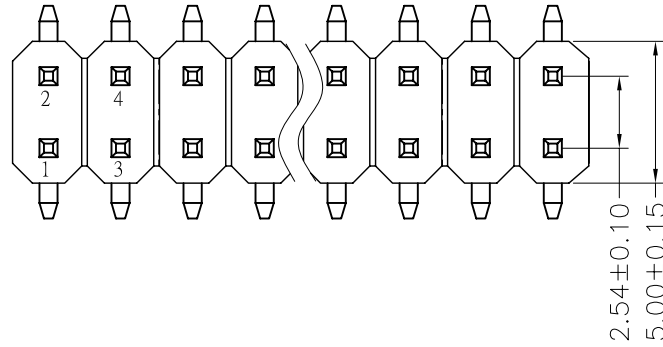

### Ordering Information

MTP125-12XXM1

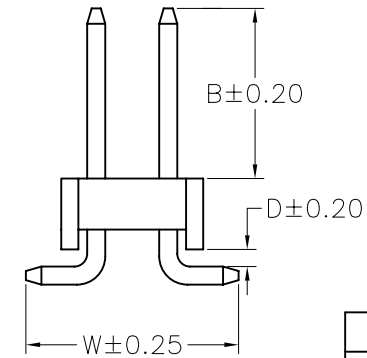
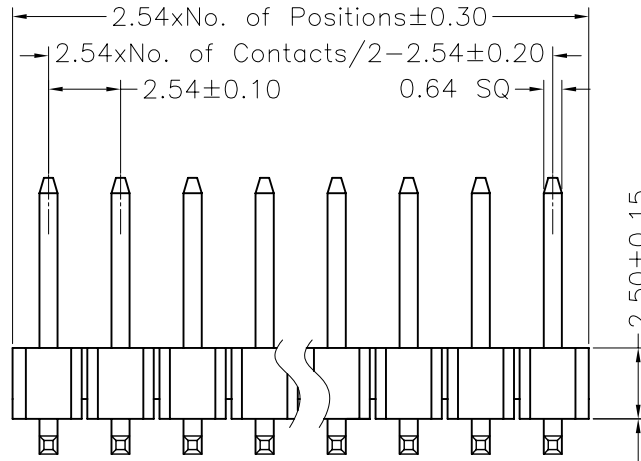

Dimension antitheses list			
ITEM	D	B	W
Standard	0.60	6.00	7.50
Alternate			

X. ± 0.30	X.° ± 5°	UNITS mm	NAME(INTENDED USE)	MINTRON CO.,LTD.
.X ± 0.20	.X° ± 2°	MAT'L		
.XX ± 0.10	.XX° ± 1°	FINISH	APPD: SUNNY	DWG NO.:
.XXX ± 0.05	.XXX° ± 0.5°	Q'TY	CHKD: LISA	
PIN HEADER CONNECTOR			DR: ZOE 2006-11-28	SCALE 1/1
				SHEET 1/1
				REV. A