

Ordering Information:

A2541HWV-XP - **** - *** - * - ***
 1 2 3 4 5

1. Part No.
2. Size(H):
 (blank): 8.50mm
 H71: 7.10mm
 H57: 5.70mm
 H50: 5.00mm
 H35: 3.50mm(B:B-0.50mm)
 H110: 11.00mm
3. Size(D):
 (blank): 3.20mm(H85,H71,H57,H50,H110)
 D26: 2.60mm(H35)
 D21: 2.10mm(H50)
4. Finish:
 (blank): Gold over Nickel
 T: Tin over Nickel
5. Material:
 (blank): PBT,UL94V-0
 6T: Nylon 6T,UL94V-0
 GWT: Nylon 6T,UL94V-0,GWT 750°C

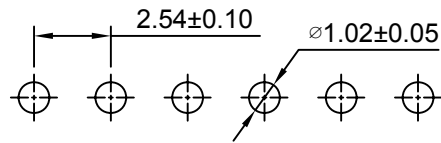
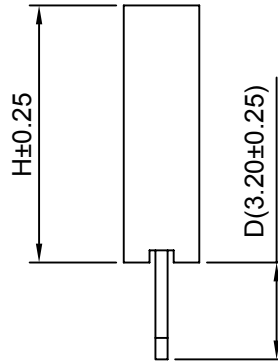
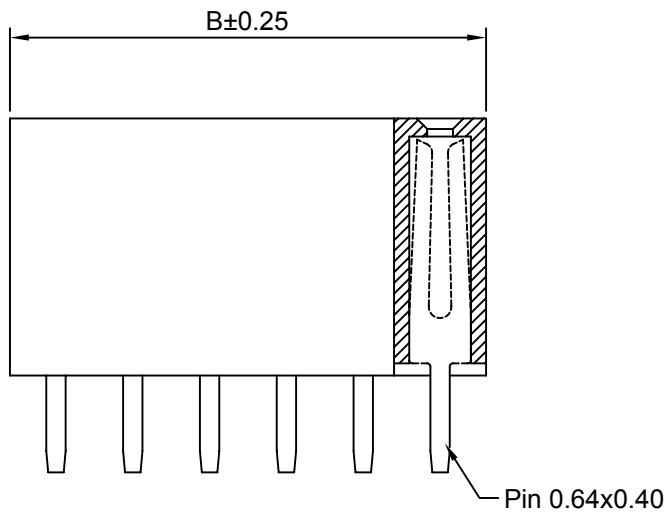
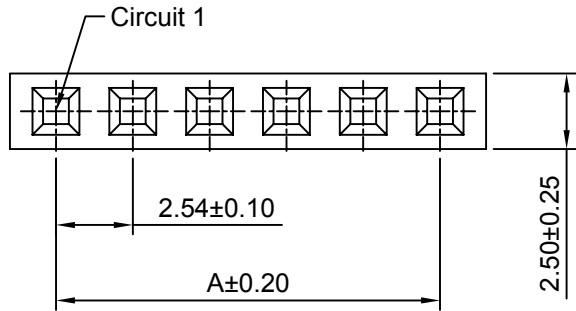

P.C.B LAYOUT

SPECIFICATIONS:

Current Rating: 3A AC,DC
 Voltage Rating: 250V AC,DC
 Temperature Range: -40°C ~ +105°C
 Contact Resistance: 20mΩ Max
 Insulation Resistance: 1000MΩ Min
 Withstanding Voltage: 1500V AC/minute
 Pin Material: Brass/Gold over Nickel
 Material: PBT,UL94V-0(Black)

Ordering Information & Dimensions

| Circuits | Dim(mm) | | Circuits | Dim(mm) | | Circuits | Dim(mm) | |
|----------|---------|-------|----------|---------|-------|----------|---------|--------|
| | A | B | | A | B | | A | B |
| 2P | 2.54 | 5.58 | 15P | 35.56 | 38.60 | 28P | 68.58 | 71.62 |
| 3P | 5.08 | 8.12 | 16P | 38.10 | 41.14 | 29P | 71.12 | 74.16 |
| 4P | 7.62 | 10.66 | 17P | 40.64 | 43.68 | 30P | 73.66 | 76.70 |
| 5P | 10.16 | 13.20 | 18P | 43.18 | 46.22 | 31P | 76.20 | 79.24 |
| 6P | 12.70 | 15.74 | 19P | 45.72 | 48.76 | 32P | 78.74 | 81.78 |
| 7P | 15.24 | 18.28 | 20P | 48.26 | 51.30 | 33P | 81.28 | 84.32 |
| 8P | 17.78 | 20.82 | 21P | 50.80 | 53.84 | 34P | 83.82 | 86.86 |
| 9P | 20.32 | 23.36 | 22P | 53.34 | 56.38 | 35P | 86.36 | 89.40 |
| 10P | 22.86 | 25.90 | 23P | 55.88 | 58.92 | 36P | 88.90 | 91.94 |
| 11P | 25.40 | 28.44 | 24P | 58.42 | 61.46 | 37P | 91.44 | 94.48 |
| 12P | 27.94 | 30.98 | 25P | 60.96 | 64.00 | 38P | 93.98 | 97.02 |
| 13P | 30.48 | 33.52 | 26P | 63.50 | 66.54 | 39P | 96.52 | 99.56 |
| 14P | 33.02 | 36.06 | 27P | 66.04 | 69.08 | 40P | 99.06 | 102.10 |

CJTconn CHANGJIANG CONNECTORS CO.,LTD.

| | | |
|----------|------------|--------|
| Unit | Scale | Sheet |
| mm | 4:1 | 1 of 1 |
| Draw BY: | Approved : | |
| Tony Su | Jack Yin | |

| | |
|--|-------------|
| Title : | |
| 2.54mm PITCH 180° SINGLE ROW BOX HEADER | |
| DRAW NO : | A2541HWV-XP |
| REV | A1 |

| | | |
|-------------------|-----------------|------------|
| General Tolerance | | |
| A1 | updated version | 2018.04.13 |
| A0 | NEW RELEASE | 2005.07.01 |
| REV | DESCRIPTION | DATE |

x.xx≤0.25
 x.xx≤0.20
 x.xxx≤0.15

ANGLE±