

SIGN	DATE	DESCRIPTION	APPROVER
△			
△			
△			

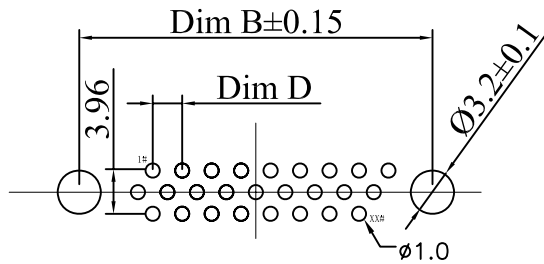
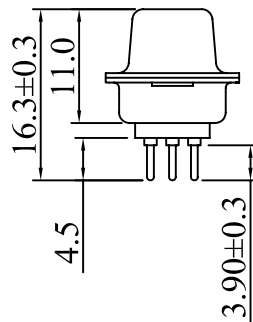
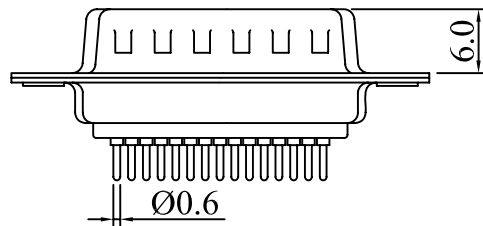
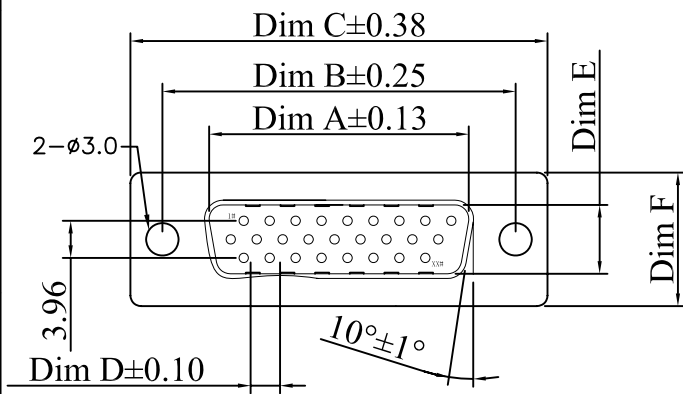

P. C. BOARD LAYOUT

POS. NO.	A	B	C	D	E	F
78P	52.86	61.10	67.10	2.41	11.11	15.30
62P	55.42	63.50	69.32	2.41	8.36	12.50
44P	38.96	47.04	53.04	2.29	8.36	12.50
26P	25.25	33.32	39.14	2.29	8.36	12.50
15P	16.92	24.99	30.81	2.29	8.36	12.50

DIMENSION

SPECIFICATIONS:

Current rating:3.0A AC/DC

Voltage rating:250V AC/DC

Contact resistance:30m ohm MAX

Insulation resistance:5000M ohm MIN

Withstanding voltage:1000V AC for one minute

Operating temperature range:-40°C~+85°C

MATERIAL AND FINISH

Insulator:PBT+30%G.F(UL94V-0)

Contact:Copper Alloy Nickel Undercoated

Selective Gold Plated

Finish:Metal Iron With Tin Plated

Ordering Information

Number of contacts		Housing Type		Mounting Options		Contacts Material		Contact Plated		Insulator material		Insulator color		Mark	
Code	Definition	Code	Definition	Code	Definition	Code	Definition	Code	Contact Area	Code	Definition	Code	Definition	Code	Definition
B	15 PIN	M	Male	1	RIVETED W/ SHIELD ONLY	2	Brass	1	Full Gold 1u"	0	PBT	0	Black	0	NONE
D	26 PIN	F	Female	2	RIVETED W/ FRONT RIVET	7	Phosphor bronze	2	Gold 3u"	2	NYLON	6	Blue	2	Nexttron
F	44 PIN			3	RIVETED W/ REAR RIVET			3	Gold 5u"			9	White		
G	62 PIN			4	RIVETED W/ NUT RIVET			4	Gold 10u"						
H	78 PIN			5	RIVETED W/ HEX SCREW+HEX NUT			5	Gold 15u"						
								6	Gold 30u"						

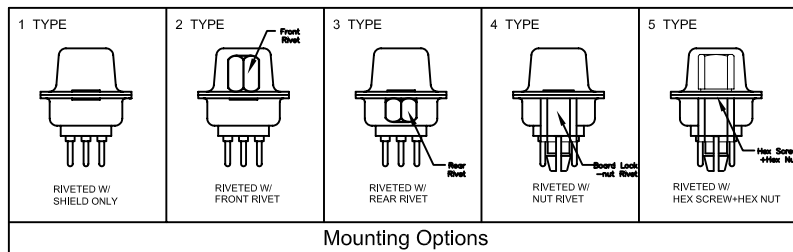

Mounting Options

nexttron 正凌精密工业股份有限公司
NEXTRONICS ENGINEERING CORP

PART. NAME: D型XX芯高密直插式PCB焊接插座(针)				TITLE:			
PART. NO.: SUB-HPBF-1071-002				DWG NAME:			
APPROVED BY	CHECKED BY	DESIGNED BY	DRAWN BY	CUSTOM NO.:		Tolerance	
Jonnson	Jeff	allan	Jacky			UNITS: mm	x. ±0.50
						SCALE:	x.xx ±0.30
						REVISION:	xx° ±1°