

SEC:A-A

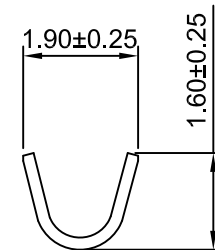

SEC:B-B

PART NO.	PLATING THICKNESS		NOTE:
	Ni / u"	Sn / u"	
A2543-TBD	3 Min.	40 Min.	Preplated Tin
A2543-TPD	3 Min.	40 Min.	

Ordering information & Specifications

Unit:mm

Part No	Wire Range	Insultion O.D.	Material	Finish	Qty/reel
A2543-TBD	AWG#22-#28	1.57mm(max)	Brass	Tin over Nickel	10,000 PCS
A2543-TPD	AWG#22-#28	1.57mm(max)	Phosphor Bronze	Tin over Nickel	10,000 PCS

**CJTconn**

CHANGJIANG CONNECTORS CO.,LTD.

Unit	Scale	Sheet
mm	8:1	1 of 1

Title :		2.54mm Pitch	REV
Crimp Terminal			
DRAW NO :		A2543-TD	

Draw By:	Approved :
Diankui Wan	Jack Yin

REV	DESCRIPTION	DATE	General Toerance	PROJECT
A3	ADD THE SIZE	2019.11.21	x.xx±0.25 x.xxx±0.15	PROJECT
A2	CHANGE THE SIZE	2019.04.10		
A1	ADD THE SIZE	2019.04.04		
REV	DESCRIPTION	DATE		