

SEC:A-A

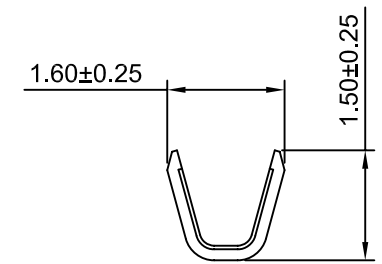

SEC:B-B

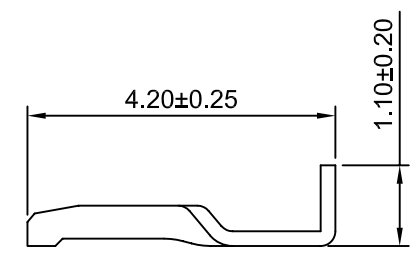

SEC:C-C

Ordering information & Specifications

Unit:mm

| Part No | Wire Range | Insultion O.D. | Material | Finish | Qty/reel |
|----------|------------|----------------|-----------------|------------------|------------|
| B1501-TB | AWG#28-#30 | 1.00mm(max) | Brass | Tin over Nickel | 15,000 PCS |
| B1501-TP | AWG#28-#30 | 1.00mm(max) | Phosphor Bronze | Tin over Nickel | 15,000 PCS |
| B1501-GB | AWG#28-#30 | 1.00mm(max) | Brass | Gold over Nickel | 15,000 PCS |
| B1501-GP | AWG#28-#30 | 1.00mm(max) | Phosphor Bronze | Gold over Nickel | 15,000 PCS |

Optional Gold plating available but MOQ requested



CHANGJIANG CONNECTORS CO.,LTD.

| | | |
|---------------------|---------------|------------------------|
| Unit mm | Scale 10:1 | Sheet 1 of 1 |
| Draw BY: Tony Su | | Approved : Jack Yin |

Title :
1.50mm PITCH
CRIMP TERMINAL

| | | | | |
|-----|-------------|------------|--|------------|
| | | | x.xx≤0.25 x.xxx≤0.20 x.xxxx≤0.15 | ANGLE± |
| A0 | NEW RELEASE | 2005.05.10 | | |
| REV | DESCRIPTION | DATE | | |

DRAW NO : **B1501-T** REV A0