

Specifications:

规格:

Voltage rating:200V AC/DC

额定电压: 200V AC/DC

Current rating:1A AC/DC

额定电流: 1A AC/DC

Withstanding voltage:500V AC/minute

耐受电压: 500V AC/ 分钟

Temperature range:-40 +105

温度范围: -40 +105

Insulation resistance:≥1000MΩ

绝缘电阻: ≥1000MΩ

Contact resistance:≤20mΩ

接触电阻: ≤20mΩ

After environmental testing:≤40mΩ

环境测试后: ≤40兆欧

X0812 F V S-XX X S- 9T V01

① ② ③ ④ ⑤ ⑥ ⑦ ⑧ ⑨

- 1.Series No
- 2.Category:F-Female
- 3.Welding Board Angle:V-Straight 180°
- 4.Welding Way:S-SMT
- 5.Row No-Pin No:XX-04P-100P
- 6.Height:A=4.0mm;B=4.5mm;C=5.0mm;D=5.5mm;E=6.0mm;F=6.5mm
- 7.Special No:S-With positioning Column
- 8.Material:9T-PA9T UL94V-0 Black
- 9.Plating:V01-Gold Flash

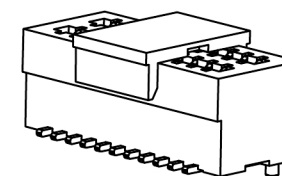
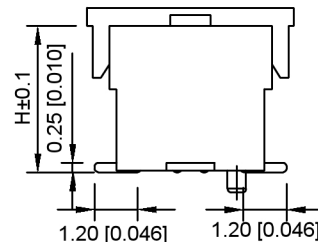
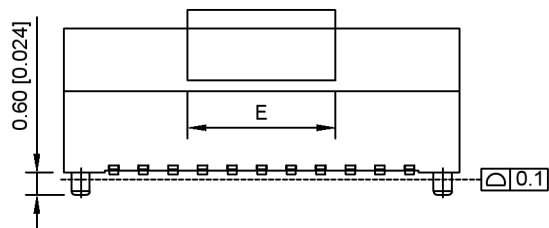

3D VIEW

| MATING HEIGHT | PLUG | SOCKET |
|---------------|------|--------|
| 4.0 | 1.0 | 3.0 |
| 4.5 | 1.0 | 3.5 |
| 5.0 | 1.0 | 4.0 |
| 5.5 | 1.0 | 4.5 |
| 6.0 | 2.0 | 4.0 |
| 6.5 | 2.0 | 4.5 |

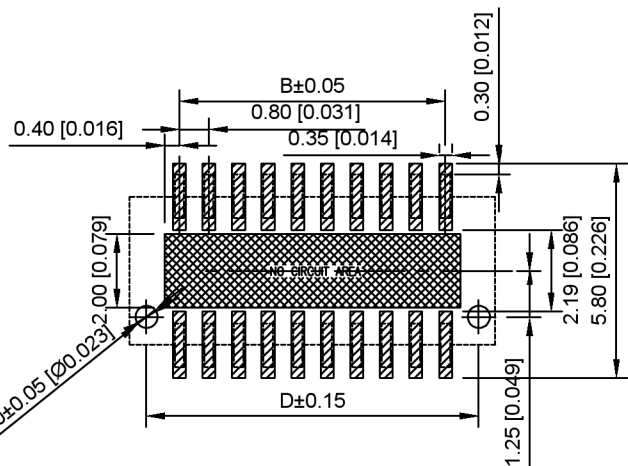

RECOMMENDED PCB PATTERN DIM.

TOLERANCE:±0.05

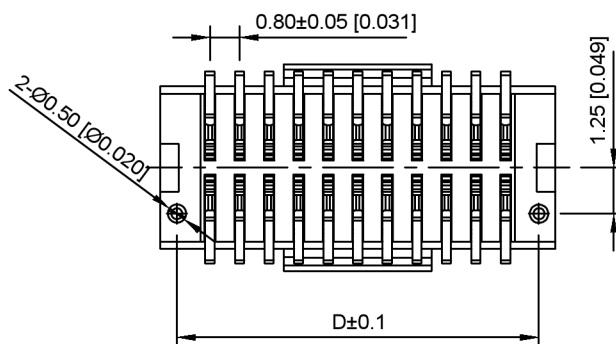

| No. of contacts | Dimensions | | | | | No. of contacts | Dimensions | | | | |
|-----------------|------------|-------|-------|-------|---|-----------------|------------|-------|-------|-------|---|
| | A | B | C | D | E | | A | B | C | D | E |
| 4 | 3.50 | 0.80 | 1.86 | 2.60 | | 54 | 23.50 | 20.80 | 21.86 | 22.60 | |
| 6 | 4.30 | 1.60 | 2.66 | 3.40 | | 56 | 24.30 | 21.60 | 22.66 | 23.40 | |
| 8 | 5.10 | 2.40 | 3.46 | 4.20 | | 58 | 25.10 | 22.40 | 23.46 | 24.20 | |
| 10 | 5.90 | 3.20 | 4.26 | 5.00 | | 60 | 25.90 | 23.20 | 24.26 | 25.00 | |
| 12 | 6.70 | 4.00 | 5.06 | 5.80 | | 62 | 26.70 | 24.00 | 25.06 | 25.80 | |
| 14 | 7.50 | 4.80 | 5.86 | 6.60 | | 64 | 27.50 | 24.80 | 25.86 | 26.60 | |
| 16 | 8.30 | 5.60 | 6.66 | 7.40 | | 66 | 28.30 | 25.60 | 26.66 | 27.40 | |
| 18 | 9.10 | 6.40 | 7.46 | 8.20 | | 68 | 29.10 | 26.40 | 27.46 | 28.20 | |
| 20 | 9.90 | 7.20 | 8.26 | 9.00 | | 70 | 29.90 | 27.20 | 28.26 | 29.00 | |
| 22 | 10.70 | 8.00 | 9.06 | 9.80 | | 72 | 30.70 | 28.00 | 29.06 | 29.80 | |
| 24 | 11.50 | 8.80 | 9.86 | 10.60 | | 74 | 31.50 | 28.80 | 29.86 | 30.60 | |
| 26 | 12.30 | 9.60 | 10.66 | 11.40 | | 76 | 32.30 | 29.60 | 30.66 | 31.40 | |
| 28 | 13.10 | 10.40 | 11.46 | 12.20 | | 78 | 33.10 | 30.40 | 31.46 | 32.20 | |
| 30 | 13.90 | 11.20 | 12.26 | 13.00 | | 80 | 33.90 | 31.20 | 32.26 | 33.00 | |
| 32 | 14.70 | 12.00 | 13.06 | 13.80 | | 82 | 34.70 | 32.00 | 33.06 | 33.80 | |
| 34 | 15.50 | 12.80 | 13.86 | 14.60 | | 84 | 35.50 | 32.80 | 33.86 | 34.60 | |
| 36 | 16.30 | 13.60 | 14.66 | 15.40 | | 86 | 36.30 | 33.60 | 34.66 | 35.40 | |
| 38 | 17.10 | 14.40 | 15.46 | 16.20 | | 88 | 37.10 | 34.40 | 35.46 | 36.20 | |
| 40 | 17.90 | 15.20 | 16.26 | 17.00 | | 90 | 37.90 | 35.20 | 36.26 | 37.00 | |
| 42 | 18.70 | 16.00 | 17.06 | 17.80 | | 92 | 38.70 | 36.00 | 37.06 | 37.80 | |
| 44 | 19.50 | 16.80 | 17.86 | 18.60 | | 94 | 39.50 | 36.80 | 37.86 | 38.60 | |
| 46 | 20.30 | 17.60 | 18.66 | 19.40 | | 96 | 40.30 | 37.60 | 38.66 | 39.40 | |
| 48 | 21.10 | 18.40 | 19.46 | 20.20 | | 98 | 41.10 | 38.40 | 39.46 | 40.20 | |
| 50 | 21.90 | 19.20 | 20.26 | 21.00 | | 100 | 41.90 | 39.20 | 40.26 | 41.00 | |

广东星坤科技股份有限公司

| | | |
|------|--|----|
| ΔX | | 日期 |
| ΔX | | 日期 |
| ΔX | | 日期 |
| MARK | | |

| REVISIONS | DATE | REVISED | APPROVED |
|-----------|------|---------|----------|
| | | | |

www.helloxkb.com www.helloxkb.cn www.xk-dg.cn

| | |
|------------------------|------|
| ANGULAR | ±5° |
| L ≤ 4 | ±0.2 |
| 4 < L ≤ 16 | ±0.3 |
| 16 < L ≤ 63 | ±0.4 |
| L > 63 | ±0.5 |
| UNSPECIFIED TOLERANCES | |



| | |
|------|-------------|
| DSND | SCALE: N/A |
| DWN | VIEW: |
| CHKD | UNIT: mm/in |
| APPD | SIZE: A4 |

| | | |
|---|-------|----------|
| MODEL TYPE: 0.8mm BTB Style Connectors | | |
| PART NO.: X0812FVS-XXXS-9TV01 | | |
| DWG NO.: X-X0812FVS-XXXS-9TV01 | | |
| WEIGHT | SHEET | REVISION |
| | 1/1 | A0 |

XKB INDUSTRIAL PRECISION CO., LIMITED

文件工程章