

P.C.B LAYOUT

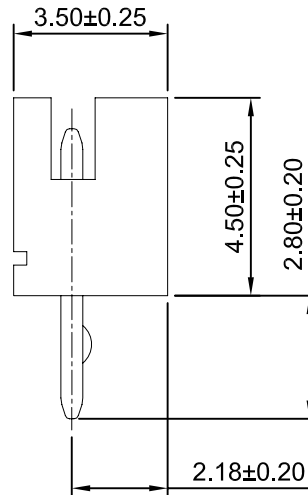
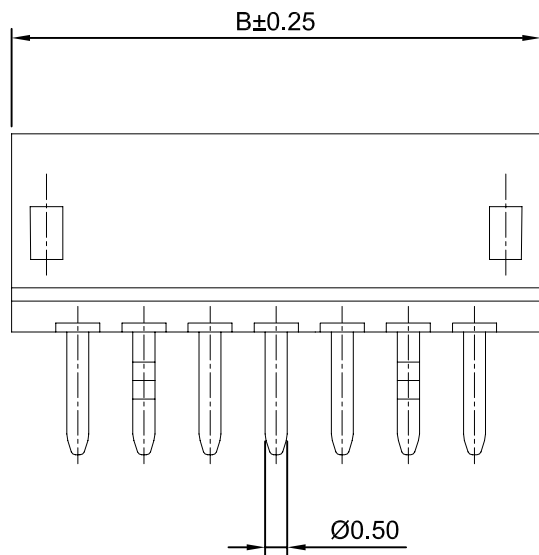

Ordering Information:

A1501WV-XP - **

1 2

1.Part No.

2.Color:

(blank):Brown

WH:White

SPECIFICATIONS:

Current Rating: 1A AC,DC

Voltage Rating: 100V AC,DC

Temperature Range: -40°C ~ +105°C

Contact Resistance: 20mΩ Max.

Insulation Resistance: 500MΩ Min.

Withstanding Voltage: 500V AC/minute

Pin Material: Brass/Tin over Nickel

Material: Nylon 66,UL94V-0(Brown)

Ordering Information & Dimensions

Circuits	Dimensions(mm)		Circuits	Dimensions(mm)	
	A	B		A	B
2P	1.50	4.50	8P	10.50	13.50
3P	3.00	6.00	9P	12.00	15.00
4P	4.50	7.50	10P	13.50	16.50
5P	6.00	9.00	11P	15.00	18.00
6P	7.50	10.50	12P	16.50	19.50
7P	9.00	12.00	13P	18.00	21.00

CJTconn

CHANGJIANG CONNECTORS CO.,LTD.

Unit	Scale	Sheet
mm	6:1	1 of 1

Title :

1.50mm PITCH

Draw BY:	Approved :
LIZQ	GONGYB

180° WAFER

General Tolerance

x.xx±0.25	ANGLE±
x.xxx±0.20	⊕
x.xxxx±0.15	⊖

DRAW NO : A1501WV-XP

REV
A0

A0	NEW RELEASE	2005.05.10
REV	DESCRIPTION	DATE