

电路图

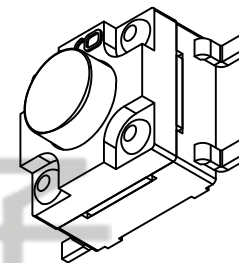

主要技术规格:

1. 额定值: 50mA DC12V
2. 接触电阻: $\leq 50m\Omega$
3. E(操作力: $250 \pm 50gf$)
4. 行程: $0.3 \pm 0.1mm$
5. 绝缘电阻: $\geq 100M\Omega$
6. 抗电强度: 250V 50HZ 1Min.
7. 寿命: 100,000 Cycles
8. 防水等级: IP67
9. 防银迁移: 60V, 85°C, 90%RH/60H

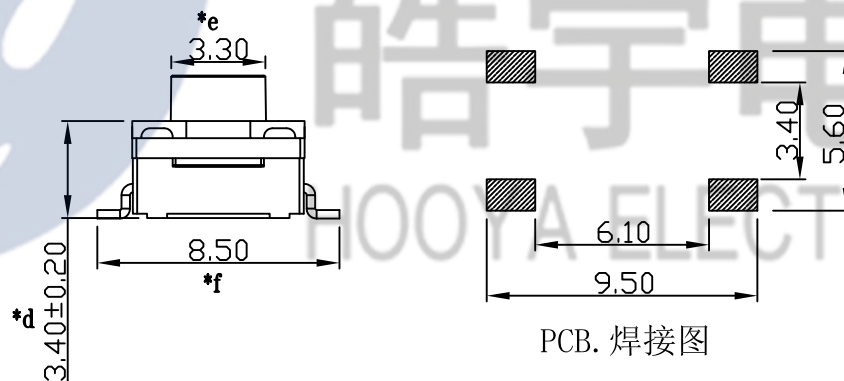

PCB. 焊接图

H	
4.3	4.5
5.0	5.5
6.0	6.5
7.0	7.5
8.0	8.5
9.0	9.5

操作力 : E=250 ± 50gf

NO.	PART NAME	MATERIAL	QTY	FINISHING	TOLERANCE UNLESS SPECIFIED		REVISIONS		BY	APPD
8					UP TO 5mm: ±0.1	ANGULAR	1			
7					ABOVE 5mm: ±0.2	±1°	NO	DATE		
6	CONTACT	BRASS	4	Ag-PLATED	TITLE: TACT SWITCH		UNIT : MM	ROHS COMPLIANT	DWN	
5	CASE	PPA	1	BLACK	MODEL: TC-06104F-043E		SCALE: 1:1		CHK'D	
4	REED	SUS	1	Ag-PLATED	HAOYU(HONGKONG)LIMITED				APPD	
3	WATERPROOF PAD	RUBBER	1	BLACK	皓宇(香港)有限公司					
2	COVER PLATE	PPA	1	BLACK						
1	BUTTON	PPA	1	BLACK						
					PRO.AGL:				REV :A0	