

电路图

H	
4.3	4.5
5.0	5.5
6.0	6.5
.....	.....
13.0	13.5
14.0	15.0

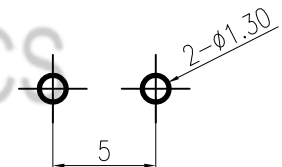

PCB. 焊接图

主要技术规格:

1. 额定值: 50mA DC12V
2. 接触电阻: ≤50mΩ
3. 操作力: 250±40gf
4. 行程: 0.45±0.1mm
5. 绝缘电阻: ≥100MΩ
6. 抗电强度: 250V 50HZ 1Min.
7. 寿命: 100,000 Cycles
8. 防水等级: IP67
9. 防银迁移: 60V, 85°C, 90%RH/60H

操作力: E=250±50gf

NO.	PART NAME	MATERIAL	QTY	FINISHING	TOLERANCE UNLESS SPECIFIED		1	DATE	REVISIONS	BY	APPD	
					UP TO 5mm: ±0.1	ANGULAR						
6	TERMINAL	BRASS	4	Ag-Plated	UP TO 5mm: ±0.1	ANGULAR	1					
5	CASE	PPA	1	BLACK	ABOVE 5mm: ±0.2	±1°	NO					
4	REED	SUS	1	Ag-Plated	TITLE: TACT SWITCH		UNIT: MM		ROHS COMPLIANT	DWN		
3	WATERPROOF PAD	RUBBER	1	BLACK	MODEL: TC-00121AF-045E		SCALE: 1:1			CHK'D		
2	COVER	PPA	1	BLACK	<b>HAOYU(HONGKONG)LIMITED</b> 皓宇(香港)有限公司					APPD		
1	BUTTON	PPA	1	BLACK								
										PRO.AGL:		REV :A0