

FS3400M

SOT-23 場效應晶體管(SOT-23 Field Effect Transistors)

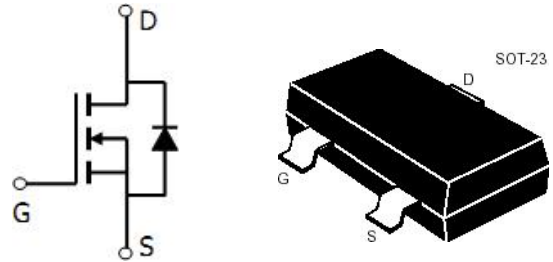

N-Channel Enhancement-Mode MOS FETs

N 沟道增强型 MOS 场效应管

■ MAXIMUM RATINGS 最大額定值

Characteristic 特性參數	Symbol 符號	Max 最大值	Unit 單位
Drain-Source Voltage 漏極-源極電壓	BV_{DSS}	30	V
Gate- Source Voltage 柵極-源極電壓	V_{GS}	± 12	V
Drain Current (continuous) 漏極電流-連續	I_D	5.8	A
Drain Current (pulsed) 漏極電流-脈沖	I_{DM}	18	A
Total Device Dissipation 總耗散功率 $T_A=25^\circ\text{C}$ 環境溫度為 25°C	PD	1400	mW
Junction 結溫	T_J	150	$^\circ\text{C}$
Storage Temperature 儲存溫度	T_{stg}	-55to+150	$^\circ\text{C}$

■ DEVICE MARKING 打標

FS3400M=A09T



FS3400M

■ ELECTRICAL CHARACTERISTICS 電特性

($T_A=25^{\circ}\text{C}$ unless otherwise noted 如無特殊說明, 溫度為 25°C)

Characteristic 特性參數	Symbol 符號	Min 最小值	Typ 典型值	Max 最大值	Unit 單位
Drain-Source Breakdown Voltage 漏極-源極擊穿電壓($I_D=250\mu\text{A}, V_{GS}=0\text{V}$)	BV_{DSS}	30	—	—	V
Gate Threshold Voltage 柵極開啓電壓($I_D=250\mu\text{A}, V_{GS}=V_{DS}$)	$V_{GS(th)}$	0.6	—	2	V
Diode Forward Voltage Drop 內附二極管正向壓降($I_S=1.25\text{A}, V_{GS}=0\text{V}$)	V_{SD}	—	0.7	1	V
Zero Gate Voltage Drain Current 零柵壓漏極電流($V_{GS}=0\text{V}, V_{DS}=30\text{V}$)	I_{DSS}	—	—	1	μA
Gate Body Leakage 柵極漏電流($V_{GS}=\pm 12\text{V}, V_{DS}=0\text{V}$)	I_{GSS}	—	—	± 100	nA
Static Drain-Source On-State Resistance 靜態漏源導通電阻($I_D=5\text{A}, V_{GS}=10\text{V}$)	$R_{DS(ON)}$	—	32	38	$\text{m}\Omega$
Static Drain-Source On-State Resistance 靜態漏源導通電阻($I_D=3.5\text{A}, V_{GS}=4.5\text{V}$)	$R_{DS(ON)}$	—	40	45	$\text{m}\Omega$
Static Drain-Source On-State Resistance 靜態漏源導通電阻($I_D=3\text{A}, V_{GS}=2.5\text{V}$)	$R_{DS(ON)}$	—	50	55	$\text{m}\Omega$
Input Capacitance 輸入電容 ($V_{GS}=0\text{V}, V_{DS}=15\text{V}, f=1\text{MHz}$)	C_{ISS}	—	545	—	pF
Output Capacitance 輸出電容 ($V_{GS}=0\text{V}, V_{DS}=15\text{V}, f=1\text{MHz}$)	C_{OSS}	—	66	—	pF
Turn-ON Time 開啓時間 ($V_{DS}=15\text{V}, V_{GS}=10\text{V}, R_{GEN}=6\Omega$)	$t_{(on)}$	—	9.6	—	ns
Turn-OFF Time 關斷時間 ($V_{DS}=15\text{V}, V_{GS}=10\text{V}, R_{GEN}=6\Omega$)	$t_{(off)}$	—	39	—	ns

Pulse Width $\leq 300\mu\text{s}$; Duty Cycle $\leq 2.0\%$

FS3400M

■ **DIMENSION** 外形封裝尺寸
單位(UNIT): mm

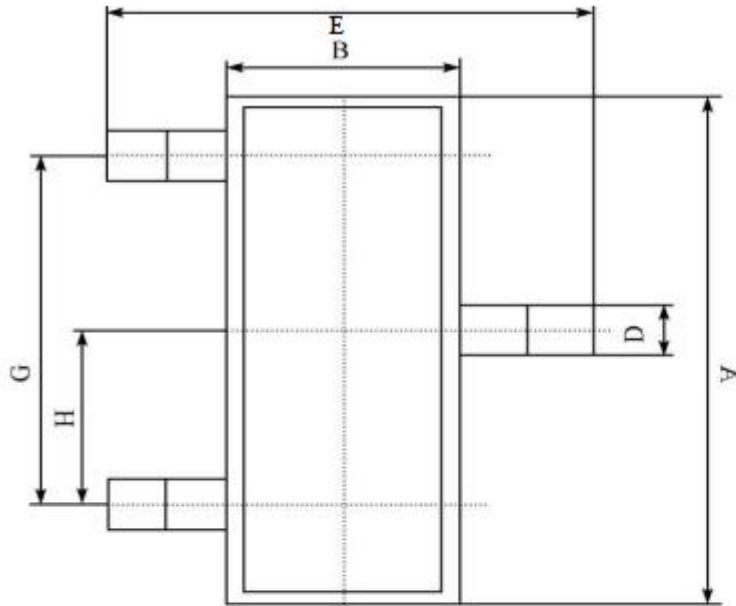

代碼	範圍(單位:mm)
A	2.80~3.00
B	1.20~1.40
C	0.90~1.10
D	0.30~0.50
E	2.20~2.60
G	1.80~2.00
H	0.90~1.00
J	0.08~0.18
K	0.02~0.12
M	≥0.22
N	0.50~0.70
P	6°~10°

