

REV.	ECN. NO.	APPD.
A		

NOTES:
 Current Rating:3.0AMP
 Contact Resistance:20mΩ max
 Withstand Voltage:500V AC/DC
 Insulation Resistance:1000MΩ min
 Operation Temperature:-40°C to +105°C

Contact Material:Brass
 Contact plating:Au or Sn Over Ni
 Insulator Material:PBT or PA6T+30%GF(UL94V-0)

Recommended P.C.B Layout(Top Side)
 (PCB BOARD TOLERANCE±0.05)

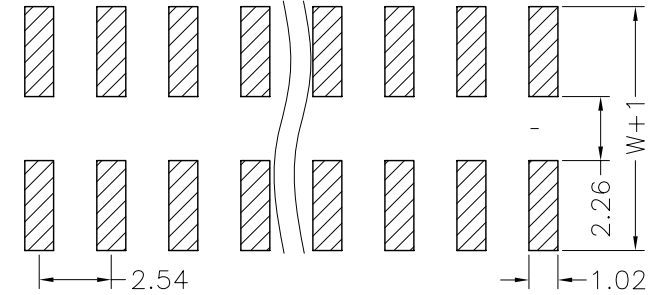
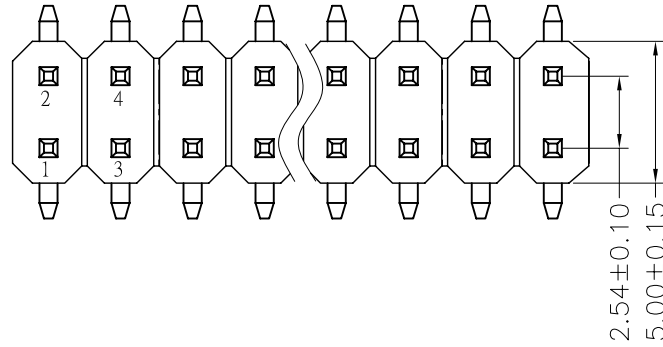

Ordering Information

MTP125-12XXM1

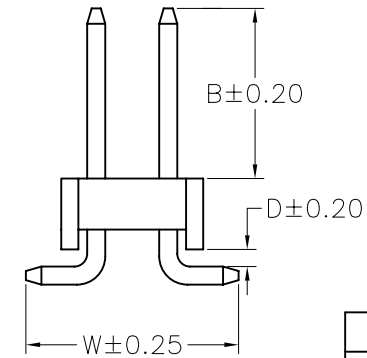
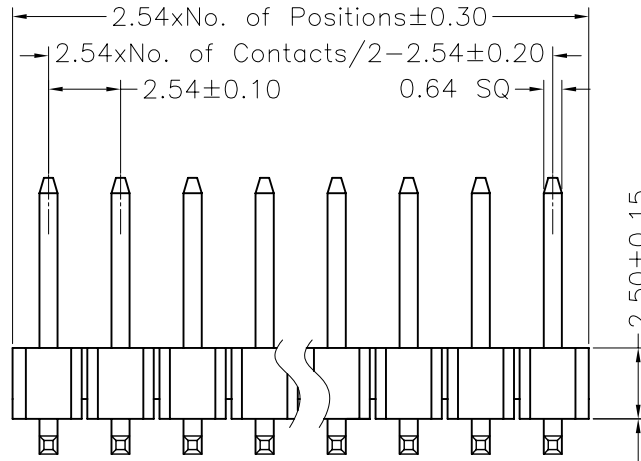

Dimension antitheses list			
ITEM	D	B	W
Standard	0.60	6.00	7.50
Alternate			

X. ± 0.30	X.° ± 5°	UNITS mm	NAME(INTENDED USE)	MINTRON CO.,LTD.			
.X ± 0.20	.X° ± 2°				MAT'L	TITLE: MTP125-12XXM1	
.XX ± 0.10	.XX° ± 1°				FINISH		DWG NO.:
.XXX ± 0.05	.XXX° ± 0.5°				Q'TY		
PIN HEADER CONNECTOR			APPD: SUNNY				
			CHKD: LISA		SCALE 1/1		
			DR: ZOE 2006-11-28		SHEET 1/1		
				REV. A			