

REV.	ECN. NO.	APPD.
A		

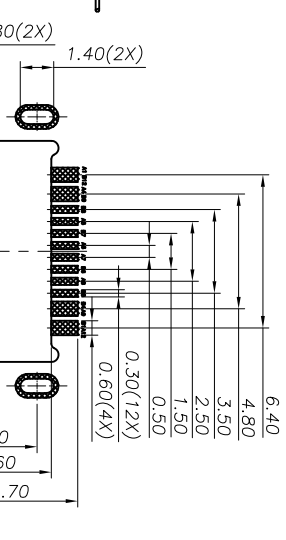

USB TYPE-C PIN ASSIGNMENTS

PIN NUMBER	SIGNAL NAME	PIN NUMBER	SIGNAL NAME
A1	GND	B12	GND
A4	VBUS	B9	VBUS
A5	CC1	B8	SBUS2
A6	Dp1	B7	Dn2
A7	Dn1	B6	Dp2
A8	SBUS1	B5	CC2
A9	VBUS	B4	VBUS
A12	GND	B1	GND

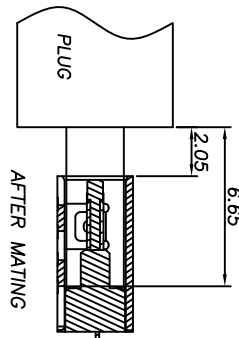
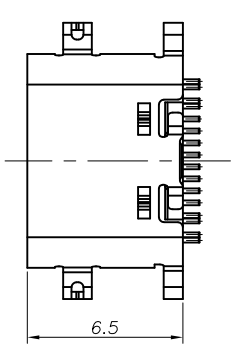
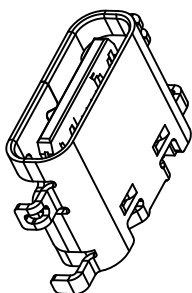
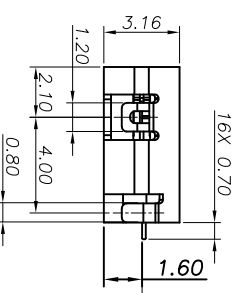
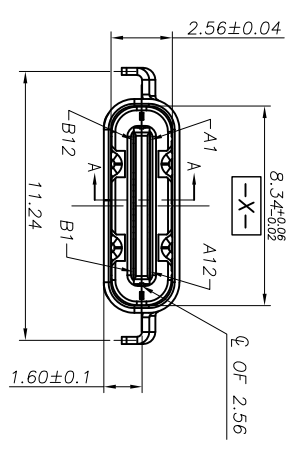

- 备注:
1. 材质及电镀 见附表1
 2. 电气性能:
 - 2.1 接触电阻: 30mΩ Max FOR INITIAL, 40mΩ Max AFTER TEST.
 - 2.2 耐压: 100V AC
 - 2.3 绝缘: 100MΩ Min
 - 2.4 额定电流: COLLECTIVELY VBUS PIN (A4,A9,B4,B9) ,TOTAL 5A VCCON PIN (B5) THROUGH GND PIN(A1,A12,B1,B12),1.25A
 3. 机械性能:
 - 3.1 插入力: 5~20N,
 - 3.2 拔出力: 初始值8~20N 测试后6~20N
 - 3.3 寿命: 10,000 CYCLES
 4. 工作温度: -40°C ~ 80°C.

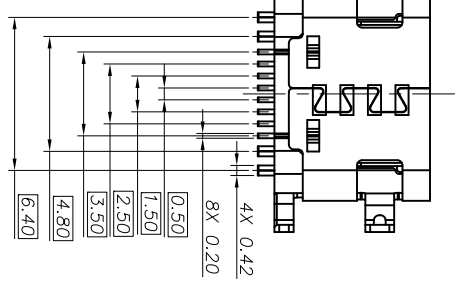
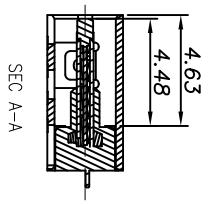

序号	品名	材质	用量	备注
07	外壳	不锈钢	1	SUS 304 1/2H10.30
06	二次Molding件	LCP	1	黑色 UL94 V-0
05	上挂脚件	LCP	1	黑色 UL94 V-0
04	下挂脚件	LCP	1	黑色 UL94 V-0
03	中夹片	SUS301-H T=0.15	1	不电镀
01	端子	C2680-H T=0.15	1set	功能测试区域镀金, 焊脚镀金

MINTRON CO., LTD.

TITLE: TYPE C 16P沉板1.6 L=6.5

DWG NO.: 26019-UCAP002-X

SCALE	SHEET	REV.
1/1	1/1	A

X.	±0.30	X.°	±5°	UNITS	mm
.X	±0.20	.X°	±2°	MAT'L	
.XX	±0.10	.XX°	±1°	FINISH	
.XXX	±0.05	.XXX°	±0.5°	QTY	

TYPE C CONNECTOR	QTY	DR: ZOE
APPD: SUNNY	CHKD: USA	2022-06-10