

REVISIONS				
REV	ECO	DESCRIPTION	DATE	BY APPR
B1	-	RELEASED DRAWING	04-9-2014	Ben Tommy

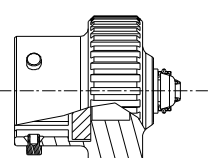
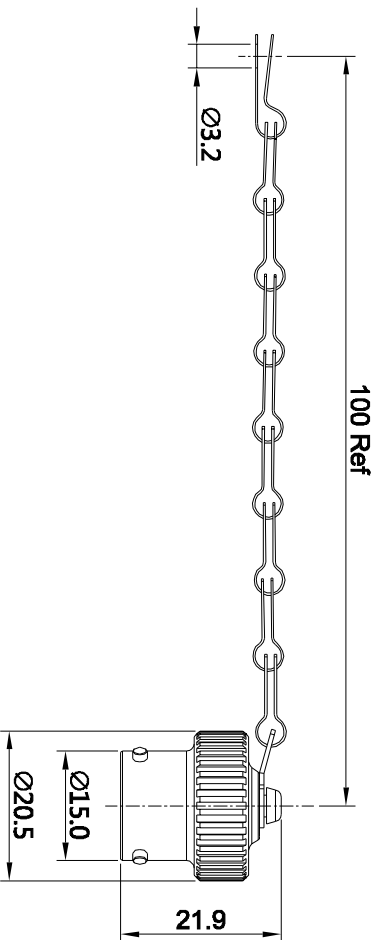

RT610DC X X  
① ②

P/N	①	②	CHAIN	PLATING
RT610DC	---	---	NO CHAIN	NICKEL PLTING
RT610DCA	---	A	NO CHAIN	BLACK ANODIZING
RT610DCG	G	---	CHAIN	NICKEL PLTING
RT610DCGA	G	A	CHAIN	BLACK ANODIZING

- NOTES : (UNLESS OTHERWISE SPECIFIED)
- MATERIAL :  
DUST CAP : AL ALLOY , NICKEL PLATED.  
CHAIN : STAINLESS STEEL.  
LOCATING RIVET : STAINLESS STEEL.  
RIVET : COPPER ALLOY,NICKEL PLATING  
O-RING : NBR.
  - SPECIFICATIONS :  
2.1 OPERATING TEMPERATURE : -40°C ~ +105°C.  
2.2 IP--CLASS : IP67.  
2.3 MATTING CYCLES DURABILITY : 500 CYCLES MIN.  
2.4 ROHS COMPLIANT.
  - ALL DIMENSIONS ARE FOR REFERENCE USE ONLY.

QUANTITY	SEE PART NUMBER CHART	PART NUMBER	DESCRIPTION	ITER
<b>MATERIALS LIST</b>				
UNLESS OTHERWISE SPECIFIED				
1) All dimensions are in millimeters.				
2) Tolerances are as follows:				
1 Pk. DEC 20 08				
1 Pk. DEC 20 09				
3 Pk. DEC 20 08				
3) Note reference =				
MATERIAL SPECIFICATIONS:				
PROCESS SPECIFICATIONS:				
NEXT ASST:				
SIGNATURES		DATE	THIS DRAWING IS SUPPLIED FOR SPECIFICATIONS AND PERFORMANCE DATA. THE DRAWING IS NOT TO BE USED FOR REPRODUCTION AND ALL RIGHTS OF REPRODUCTION ARE RESERVED. ALL MANUFACTURING VARIATIONS.	
DRAWN:	Ben	04-9-2014		
CHECKED:	Andrew S. Veda			
ENGINEER:				
APPROVAL:				
CUSTOMER:				
ECO-MATE DUSTCAP FOR PLUG, SIZE 10		SIZE	TYPE	DWG NO.
		B	C-	RT610DCGX
		SCALE	NONE	REVISION
				B1
		SHEET	1	OF
				1

**Amphenol**  
Sine Systems - www.amphenol-sine.com  
44724 Morley Drive  
Clinton Township, MI 48038