

A

B

C

D

E

F

G

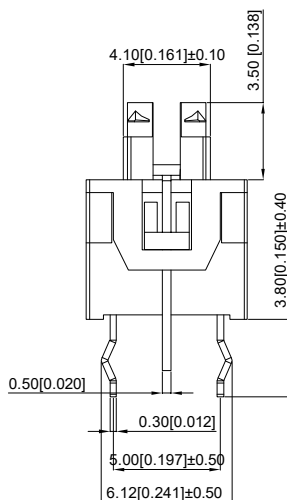
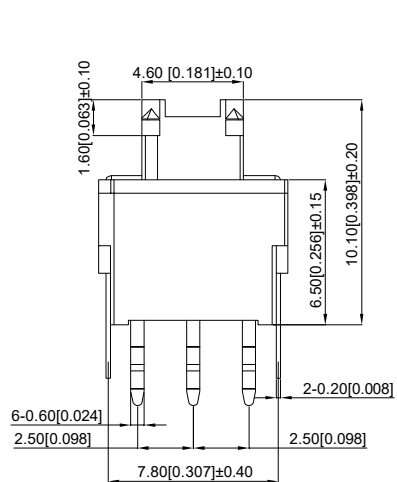
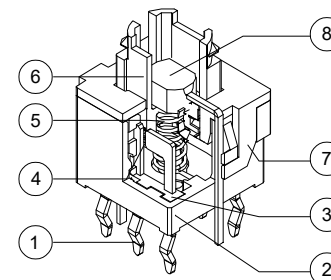
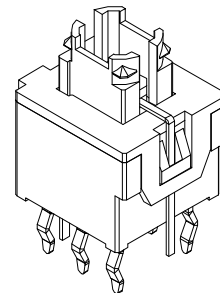
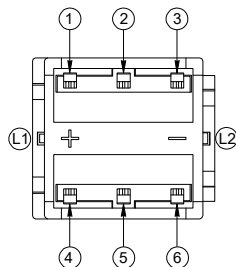
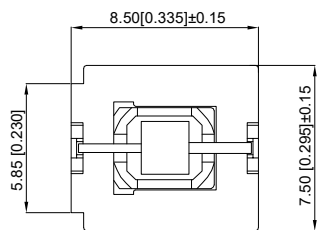

Technical parameter

技术参数

1. Rated current: DC12V 50mA
1. 额定电流: DC12V 50mA
2. Withstand voltage: AC250V (50-60Hz) for 1 minute
2. 耐压: AC250V(50-60Hz)持续1分钟
3. Contact impedance: 100M Ω Max
3. 接触阻抗: 100mΩmax
4. Insulation impedance: 100M Ω min.500v DC
4. 绝缘阻抗: 100MΩmin.500V DC
5. Operating force: 200 ± 100gf
5. 操作力: 200±100gf

6. Full stroke 2.0mm ± 0.4mm
6. 全行程2.0mm±0.4mm
7. Conduction stroke: 0.8mm ± 0.4mm
7. 导通行程0.8mm±0.4mm
8. Working temperature: -40 °C ~ + 85 °C
8. 工作温度: -40℃~+85℃
9. Operation type: No lock
9. 运行类型: 无锁
10. Service life: 10,000 times
10. 寿命: 10,000次

3

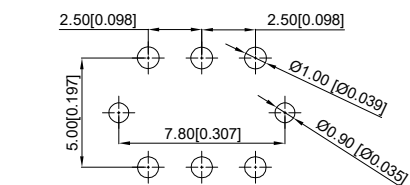

PCB LAYOUT

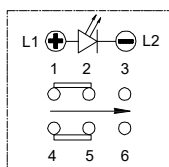

Circuit diagram

8	LED		1	Red 红灯
7	Cover 盖板	POM	1	Black 黑色
6	Guide core 导芯	POM	1	White 白色
5	Spring 弹簧	Steel wire 钢丝	1	
4	Reed 簧片	Phosphor copper 磷铜	2	Ag plating 镀银
3	Injection molding terminal 注塑端子	PA66	2	Black 黑色
2	Base 底座	PA66	1	Black 黑色
1	Terminal 端子	Brass 黄铜	6	Ag plating 镀银
NO 序号	Part name 部件名	Material 材料	QTY 数量	Remark 备注

5

A4				
A3				
A2				
A1				
REV	DATE	REVISION	DESCRIPTION	ISSUE



COMMON TOLERANCE

X.XX	± 0.10
X.X	± 0.15
X	± 0.25
ANGULAR	——

UNIT	MM	PROJECTED		PRODUCT NAME:
DRAWN BY	FUYUAN	CHECKED BY	COCO	MODEL NO: TP5852111010
DATE	2019	APPROVAL B	ALEN	Https: www.rocpu.tw
ROCPU TECHNOLOGY CO.,LTD				
Copies are issued in strict confidence and shall not be reproduced or copied, or used as the basis of manufacture or sale of apparatus without permission				