

A

B

C

D

E

F

G

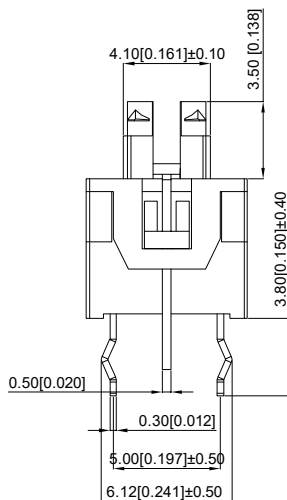
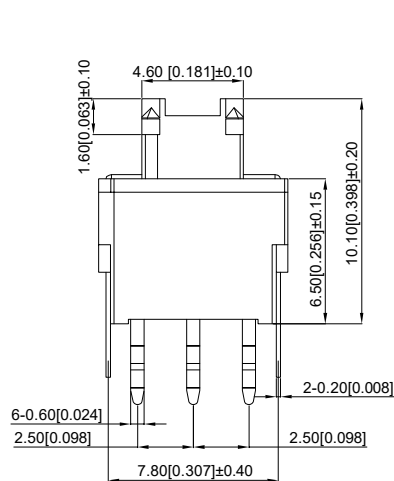
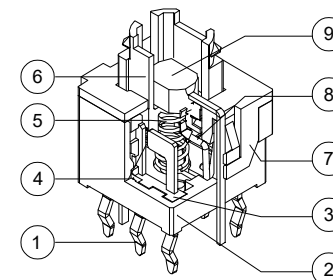
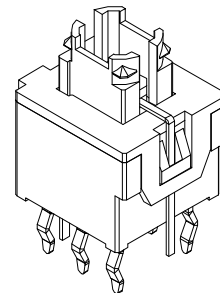
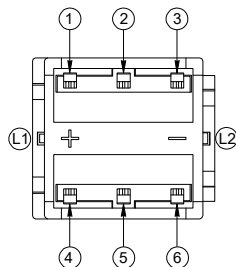
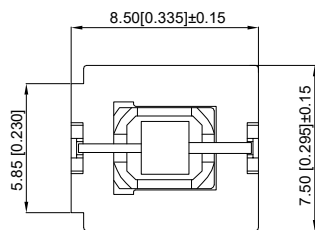

### Technical parameter

#### 技术参数

1. Rated current: DC12V 50mA  
1. 额定电流: DC12V 50mA
2. Withstand voltage: AC250V (50-60Hz) for 1 minute  
2. 耐压: AC250V(50-60Hz)持续1分钟
3. Contact impedance: 100M Ω Max  
3. 接触阻抗: 100mΩmax
4. Insulation impedance: 100M Ω min.500v DC  
4. 绝缘阻抗: 100MΩmin.500V DC
5. Operating force: 200 ± 100gf  
5. 操作力: 200±100gf

6. Full stroke 2.0mm ± 0.4mm  
6. 全行程2.0mm±0.4mm
7. Conduction stroke: 0.8mm ± 0.4mm  
7. 导通行程0.8mm±0.4mm
8. Working temperature: -40 °C ~ +85 °C  
8. 工作温度: -40℃~+85℃
9. Operation type: self-locking  
9. 运行类型: 自锁
10. Service life: 10,000 times  
10. 寿命: 10,000次

3

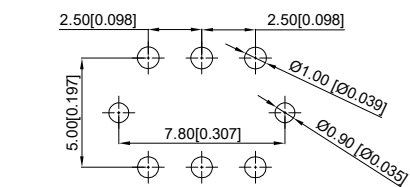

PCB LAYOUT

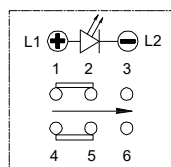

Circuit diagram

9	LED		1	Red 红灯
8	Crochet hook 钩针	Steel wire 钢丝	1	
7	Cover 盖板	POM	1	Black 黑色
6	Guide core 导芯	POM	1	White 白色
5	Spring 弹簧	Steel wire 钢丝	1	
4	Reed 簧片	Phosphor copper 磷铜	2	Ag plating 镀银
3	Injection molding terminal 注塑端子	PA66	2	Black 黑色
2	Base 底座	PA66	1	Black 黑色
1	Terminal 端子	Brass 黄铜	6	Ag plating 镀银
NO 序号	Part name 部件名	Material 材料	QTY 数量	Remark 备注

5

A4				
A3				
A2				
A1				
REV	DATE	REVISION	DESCRIPTION	ISSUE



#### COMMON TOLERANCE

X.XX	± 0.10
X.X	± 0.15
X	± 0.25
ANGULAR	—

UNIT

MM

PROJECTED

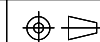

PRODUCT NAME:

DRAWN BY

FUYUAN

CHECKED BY

COCO

MODEL NO: TP5851111010

DATE

2019

APPROVAL B

ALEN

Https: www.rocpu.tw

# ROCPU TECHNOLOGY CO.,LTD

Copies are issued in strict confidence and shall not be reproduced or copied, or used as the basis of manufacture or sale of apparatus without permission