

## TO-277 Plastic-Encapsulate Diodes

### ST15100L Schottky Rectifier Diode

#### Features

- $I_{F(AV)}$  15A
- $V_{RRM}$  100V
- High surge current capability
- Low peak forward voltage

#### Applications

- Rectifier

#### Marking

- ST15100L:ST15100L

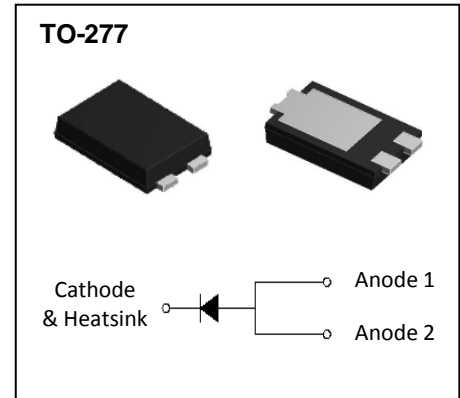

#### Limiting Values(Absolute Maximum Rating)

Item	Symbol	Unit	Test Conditions	ST15100L
Repetitive Peak Reverse Voltage	$V_{RRM}$	V		100
Maximum RMS Voltage	$V_{RMS}$	V		70
Average Forward Current	$I_{F(AV)}$	A	60Hz Half-sine wave, Resistance load, $T_L=125^\circ\text{C}$	15
Surge(Non-repetitive)Forward Current	$I_{FSM}$	A	60Hz Half-sine wave, 1 cycle, $T_a=25^\circ\text{C}$	200
Junction Temperature	$T_J$	$^\circ\text{C}$		-55 ~ +150
Storage Temperature	$T_{STG}$	$^\circ\text{C}$		-55 ~ +150

#### Electrical Characteristics ( $T=25^\circ\text{C}$ Unless otherwise specified)

Item	Symbol	Unit	Test Condition		ST15100L	
Peak Forward Voltage	$V_F$	V	$I_F=15.0\text{A}$	$T_a=25^\circ\text{C}$	0.67(TYP)	0.74(MAX)
				$T_a=125^\circ\text{C}$	0.62(TYP)	0.68(MAX)
Peak Reverse Current	$I_{RRM1}$	mA	$V_{RM}=V_{RRM}$	$T_a=25^\circ\text{C}$	0.02(TYP)	0.08(MAX)
	$I_{RRM2}$			$T_a=125^\circ\text{C}$	10(TYP)	20(MAX)
Thermal Resistance(Typical)	$R_{\theta J-A}$	$^\circ\text{C}/\text{W}$	Between junction and ambient		80	
	$R_{\theta J-L}$		Between junction and terminal		5	
Typical junction capacitance	$C_J$	nF	$V_R=4.0\text{V}$ , $f=1\text{MHz}$		0.95	

#### Notes:

Thermal resistance from junction to ambient and from junction to lead mounted on P.C.B. with 0.3" x 0.3" (8.0 mm x 8.0 mm) copper pad areas

# Typical Characteristics

FIG.1: FORWARD CURRENT DERATING CURVE

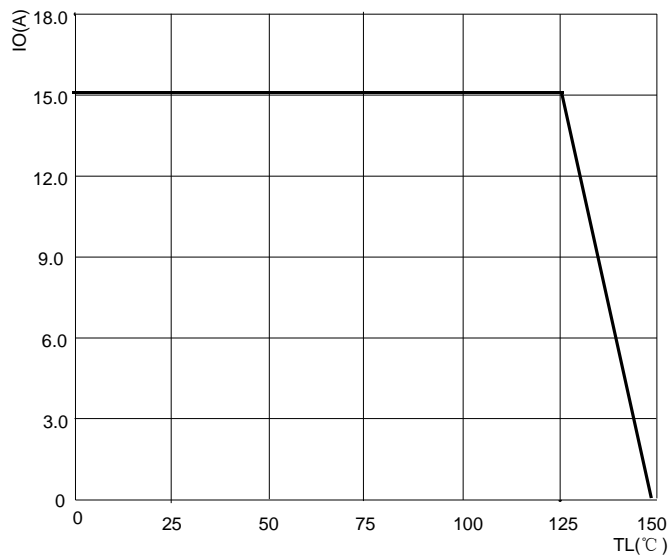

FIG.2: MAXIMUM NON-REPETITIVE FORWARD URGE CURRENT

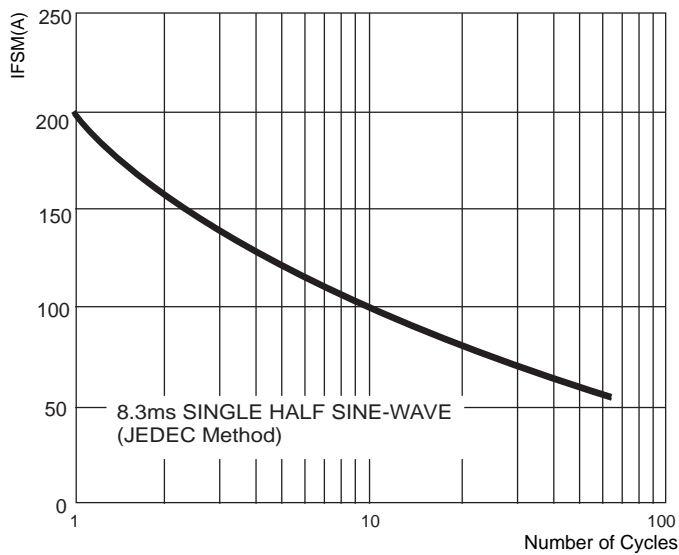

FIG3: Instantaneous Forward Voltage

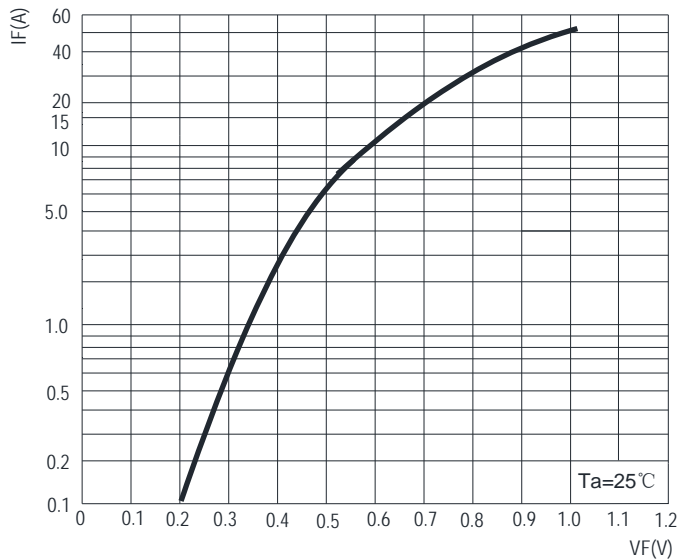
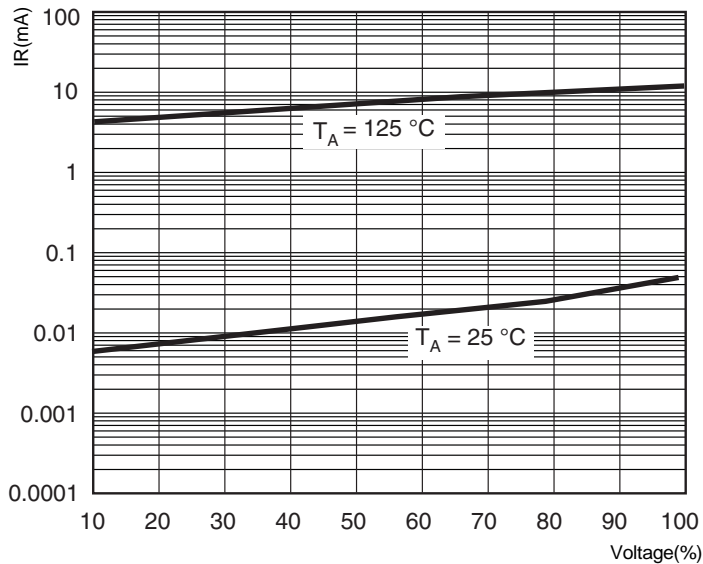
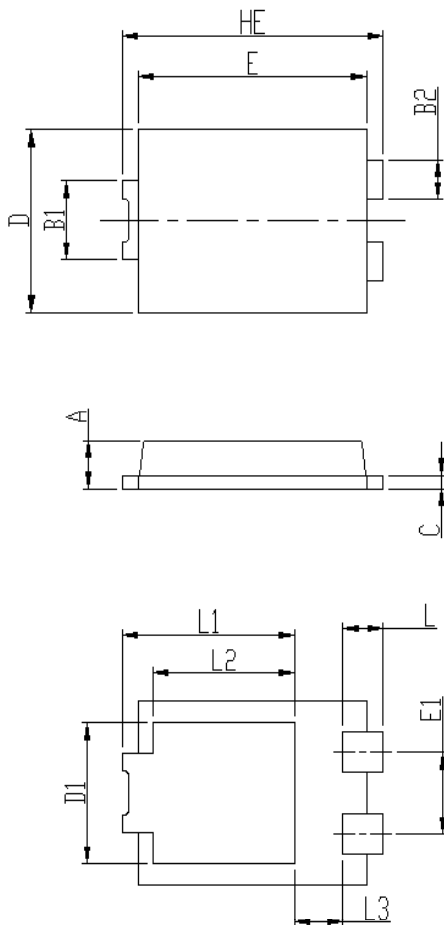

FIG.4: TYPICAL REVERSE CHARACTERISTICS



## TO- 277 Package Outline Dimensions



DIM	Unit: mm		Unit: inch	
	MIN	MAX	MIN	MAX
HE	6.4	6.6	0.252	0.260
E	5.6	5.8	0.220	0.228
D	4.1	4.3	0.161	0.169
B1	1.7	1.9	0.067	0.075
B2	0.8	1	0.031	0.039
A	1.05	1.2	0.041	0.047
C	0.3	0.4	0.012	0.016
L	0.85	1.1	0.033	0.043
L1	4.2	4.4	0.165	0.173
L2	3.52 Typ.		0.139 Typ.	
L3	1.1	1.4	0.043	0.055
D1	3	3.3	0.118	0.130
E1	1.86 Typ.		0.073 Typ.	

## TO- 277 Suggested Pad Layout

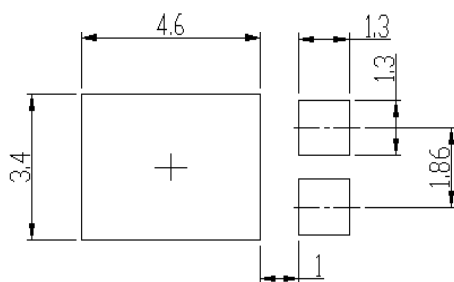

### Note:

1. Controlling dimension: in millimeters.
2. General tolerance:  $\pm 0.05$  mm.
3. The pad layout is for reference purposes only.

### NOTICE

JSCJ reserves the right to make modifications, enhancements, improvements, corrections or other changes without further notice to any product herein. JSCJ does not assume any liability arising out of the application or use of any product described herein.