

Operation: 4DIP+SMT5PIN Micro USB/卧式&插板 钢质加强舌片



LTEM NO.: MC-142P

(L8.00mm × W2.90mm × H6.70mm CONNECTORS)



Technical parameter

PROJECT	LEVEL	A[better product]		B[average product]	
	Contact Rating	1.0A, 24V DC			
Electrical Properties	Initial Contact Resistance	30mΩ max.		50mΩ max.	
	Insulation Resistance	100MΩ min.500V DC	Skey/PD:	100MΩ min.300V DC	
	Withstand Voltage	500V AC for 1 minute		350 V AC for 1 minut	
Durable Performance	There No Load	8,000 Cycles		6,000 Cycles	
	Rated Load	6,500 Cycles		5,000 Cycles	
	Storage temp.	-25℃~+75℃(Operating Temp:)			

表面贴片+DIP

側向導入 LATERAL

精密部品 NICETY

可靠 STABILIZE

適合環保 RoHS

Unit:mm

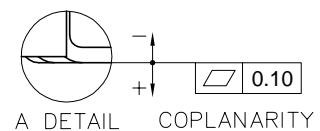
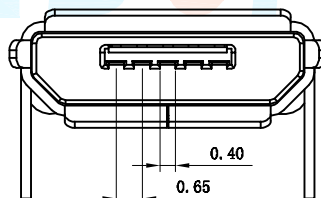
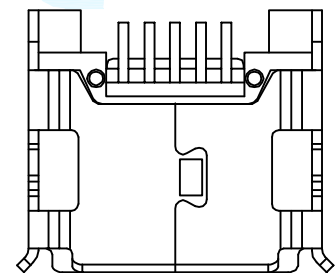
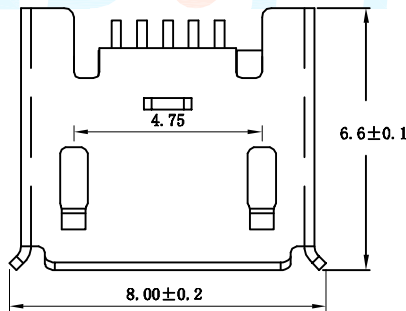
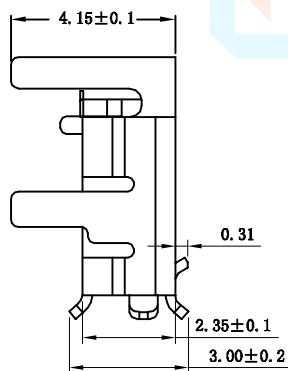
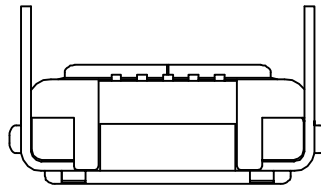
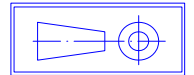

Operating Force

Inward
Exiting

5. 0N (500gf) ~8. 0N
6. 0N [(800gf) ~8. 5N

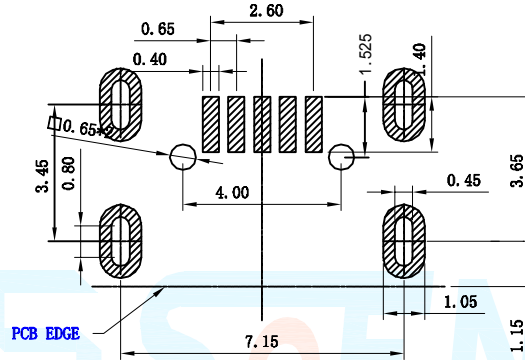

Pin Definition



Material declaration

No.	NAME	Type	Description
①	SHELL	1	Stainless Steel,(Gold Flash)
②	HOUSING	1	THERMOPLASTIC(glass fiber filled)BK
③	CONTACT	5	BRASS(t=0.12mm)
④	METAL COVER	1	STAINLESS STEEL(t=0.25mm)



本品不屬於危害性廢棄物,須丟棄時可以委託回收商予以回收再生處理。
Products do not belong to •

注記 NOTICE

1. 碩方公司擁有最終解釋權; The company reserves the right of final interpretation;
2. 文件禁止外洩、轉載; Leaked and reproduced prohibited;
3. 未經授權修改無效。Modify is invalid.

運送時本產品不要直接與水、酸鹼性化學物質接觸,或放置於含有以上氣體環境中,並且需要注意會有滑落、側翻的危險發生; 運輸過程中不能有碰撞或者擠壓,須保證溫度與濕度適中 [常溫 25℃,濕度在 50℃以內],不可導致材料變形或氧化。