

- NOIES 1:**
- ELECTRICAL CHARACTERISTICS:**
 - CURRENT RATING: 5A MIN.
 - TEMPERATURE RANGE: -45 °C to 85 °C
 - CONTACT RESISTANCE: 30 MILLIONHM MAX.
 - DIELECTRIC WITHSTANDING VOLTAGE: 500 VAC r.m.s
 - INSULATION RESISTNACE: 100 MEGOHMS MIN.
 - MECHANICAL CHARACTERISTICS**
 - INSERTION FORCE 5~20N
 - EXTRACTION FORCE: INITIAL: 8~20N, DURABILITY: 8~20N(1000CYCLES), 6~20N(10000CYCLES)
 - DURABILITY: 10,000CYCLES

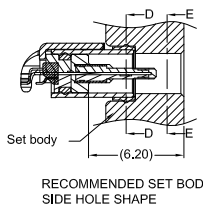

PIN DEFINITION: (Some GND pins(A1,A12,B1,B12) and Mld Plate may connect together.)

A1	A2	A3	A4	A5	A6	A7	A8	A9	A10	A11	A12
GND	TX1+	TX1-	VBUS	CC1	D+	D-	SBU1	VBUS	RX2-	RX2+	GND
GND	RX1+	RX1-	VBUS	SBU2	D-	D+	CC2	VBUS	TX2-	TX2+	GND
B12	B11	B10	B9	B8	B7	B6	B5	B4	B3	B2	B1

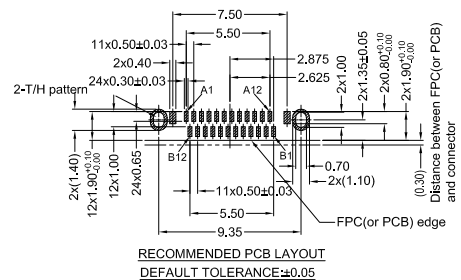
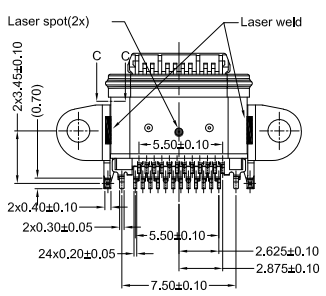
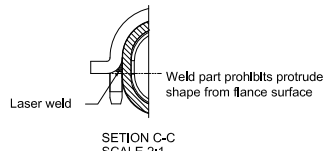
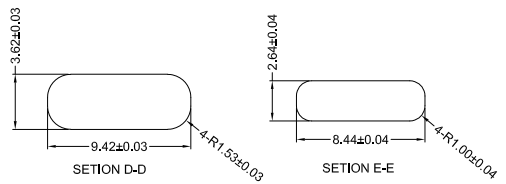

Item	Title	Material	Dispose	Item	Title	Material	Dispose
1	Frame	Stainless Steel, T=0.40	Ni:40u" Min.	7	Housing A	High Temperature Plastic	UL 94V-0/Black
2	Shell	Stainless Steel, T=0.30	Ni:40u" Min.	8	Housing B	High Temperature Plastic	UL 94V-0/Black
3	GND Plate	Stainless Steel, T=0.10	None	9	Housing C	High Temperature Plastic	UL 94V-0/Black
4	Mld Plate	Stainless Steel, T=0.15	Ni 40u"Min.+ Solder area: Au 1u"Min.	10	Rubber(O-ring)	Si	Red
5	Top Contact	Copper Alloy, T=0.12	Mating Area: Ni 80u"+Au 15u" Min.	11	Rubber	Si	Black
6	Bottom Contact	Copper Alloy, T=0.12	Solder Tails: Ni 80u"+Au 1u" Min.				

b-Switch 品贊科技® **G-Switch Electronic (HongKong) CO.,Ltd.**

Unless otherwise specified, Tolerance: X. ±0.30 X.x ±0.20 X.xx ±0.15 X.xxx ±0.10 Angles ±3°	DESIGN Li Qingqi	DATE 2022.04.09	Molde code:	
	CHECKED	DATE	GT-USB-7084A	
	APPROVED	DATE	REV.: X1	SCALE: 4:1
	http://www.dg-switch.com		UNIT: mm	
TEL:0769-82388879	SIZE: A4	SHEET: 1/1		