

PCB LAYOUT

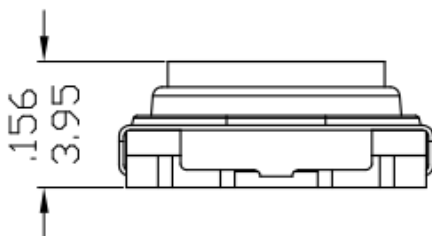
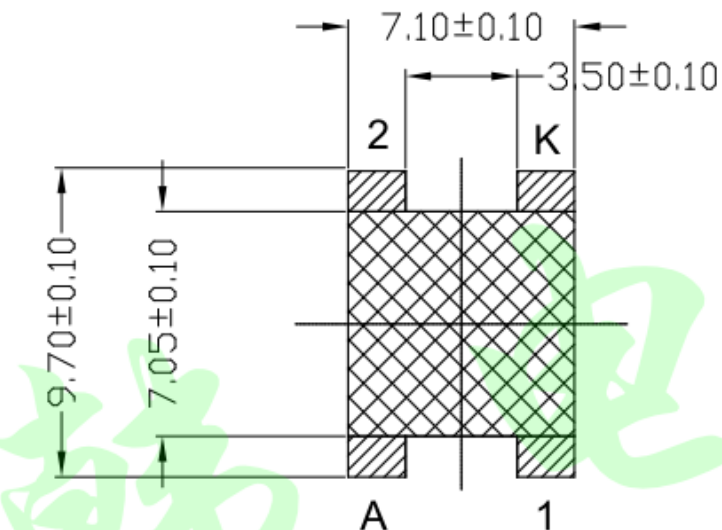

For automotive interior light control.
Switch can be with different LED colors.
Water-proof construction.

1. Contact Rating: DC 28V, 50mA
2. Operation Life: 500,000 cycles
3. Contact Resistance: 100m Ω max. (initial)
4. Insulation Resistance: 500M Ω min. 250VDC
5. Press force: 500 \pm 150gf
6. Travel: 0.75 \pm 0.3mm

CIRCUIT

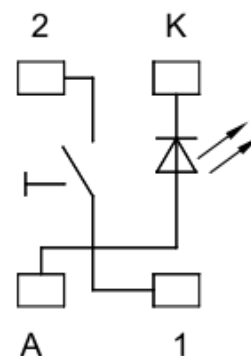

WITH LED

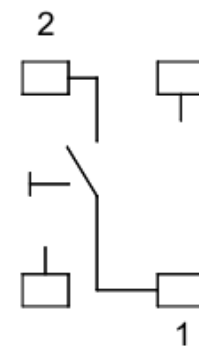

WITHOUT LED

					Nominal Tolerance		Part no.		东莞市美韩电子科技有限公司			
					Range	Tolerance	Dwg no.		Dongguan Usakro Electronic Technology Co., Ltd.		Drawer	
					0 ~ 1	± 0.10	Part Name.		Scale 1:1		Date	
1	A0	NEW	陈代学	22.2.22	1 ~ 4	± 0.20	TQ Series Tact Switches		UK-C0303-Y		Rev. 0	
NO.	Edition	Modified Contents	Name	Date	4 ~ 16	± 0.30			Unit m/m (inch)		Edition A0	