

- 备注:
1. 外壳镗雕A3;
 2. 拧螺母, 配垫圈。

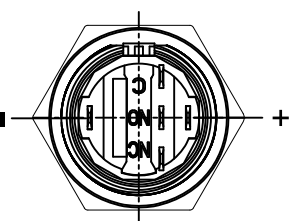
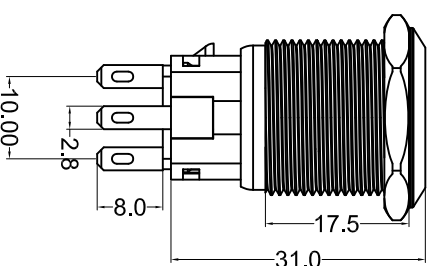
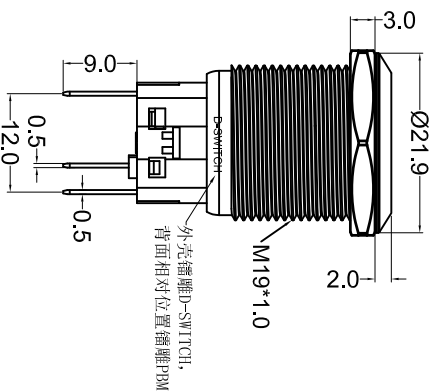

Nut Torque:5~14Nm

Operating Pressure:500gf ±200gf

Operating Stroke:3.5mm±0.5mm

Protection Grade:IP67,IK08

Function:ON-OFF

Contact:Silver Alloy

Base:PA66

Shell:SUS

Button:SUS

Lamp Type:LED

Lamp Life:50000H

Terminal:Brass, silver

Rating (Resistive load):3A 250V (AC)

Contact Resistance:50mΩ Max.

Insulation Resistance:100MΩ Min.



Dielectric Strength:1500VAC 1 minute

Electrical life:50,000 cycles

Mechanical life:100,000 cycles

Operating Temperature:-20°C~80°C

Relative Air Humidity:45%~85%

Safety Approval:   

CUT-OUT

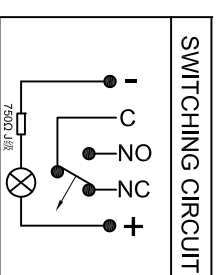
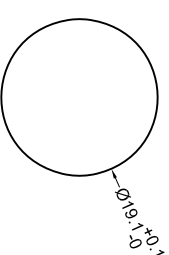

公差 TOLERANCES .X±0.5 .XX±0.3 角度 ANGLE ±1° 单位 DIMENSION UNIT mm.

版本 VER	变更说明 CHANGE DESCRIPTION	日期 DATE	ECON NO.	版本 VERSION	核准 APPROVED BY	比例尺 SCALE	核对 CHECKED BY	日期 DATE	绘图 DRAWN BY	品名 TITLE	图号 DRAWING NO
				A0		1:1		2022.03.09	孙成	PBM-19Z15-FB-01-X12-S6S-Z1-K-A3-0004	1013276