

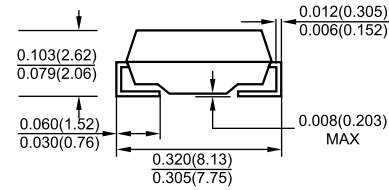

## SMC/DO-214AB

### Features

- ✧ FOR SURFACE MOUNTED APPLICATIONS
- ✧ LOW PROFILE PACKAGE
- ✧ BUILT-IN STRAIN RELIEF
- ✧ EASY PICK AND PLACE
- ✧ PLASTIC MATERIAL USED CARRIES UNDERWRITERS
- ✧ LABORATORY CLASSIFICATION 94 V-0
- ✧ EXTREMELY LOW VF
- ✧ MAJORITY CARRIER CONDUCTION
- ✧ HIGH TEMPERATURE SOLDERING : 260°C//10 SECONDS AT TERMINALS

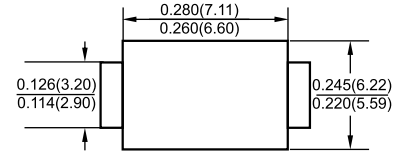

### Mechanical Data

- ✧ CASE : DO-214AB(SMC)
- ✧ TERMINALS : SOLDER PLATED
- ✧ POLARITY : INDICATED BY CATHODE BAND
- ✧ WEIGHT : 0.22GRAMS

Dimensions in inches and (millimeters)

### MAXIMUM RATINGS AND ELECTRICAL CHARACTERISTICS

Ratings at 25 C ambient temperature unless otherwise specified  
Resistive or inductive load

	SYMBOL	SS1020	SS1030	SS1040	SS1050	SS1060	SS1080	SS10A0	UNITS
Maximum Repetitive Peak Reverse Voltage	$V_{RRM}$	20	30	40	50	60	80	100	Volts
Maximum RMS Voltage	$V_{RMS}$	14	21	28	35	42	56	70	Volts
Maximum DC Blocking Voltage	$V_{DC}$	20	30	40	50	60	80	100	Volts
Maximum Average Forward Current .375" (9.5mm) lead length at $T_L = 75^\circ C$	$I_{AV}$	10.0							Amps
Peak Forward Surge Current 8.3ms Single Half Sine-Wave Superimposed on Rated Load (JEDEC Method)	$I_{FSM}$	250							Amps
Maximum Instantaneous Forward Voltage at 8.0A	$V_F$	0.55		0.70		0.85		Volts	
Maximum DC Reverse Current $T_A = 25^\circ C$ at Rated DC Blocking Voltage $T_A = 100^\circ C$	$I_R$	1.0 20							mA
Maximum Thermal Resistance (NOTE 2)	$R_{\theta JL}$	20							$^\circ C / W$
Operating Junction Temperature Range	$T_J$	-50 to +150							$^\circ C$
Storage and Operating Temperature Range	$T_{STG}$	-55 to +150							$^\circ C$

NOTES :

1. Pulse test with  $PW = 300 \mu sec$ , 1% duty cycle
2. Mounted on P.C.Board with  $8mm^2$  (0.13mm think) copper pad areas

## RATINGS AND CHARACTERISTIC CURVES

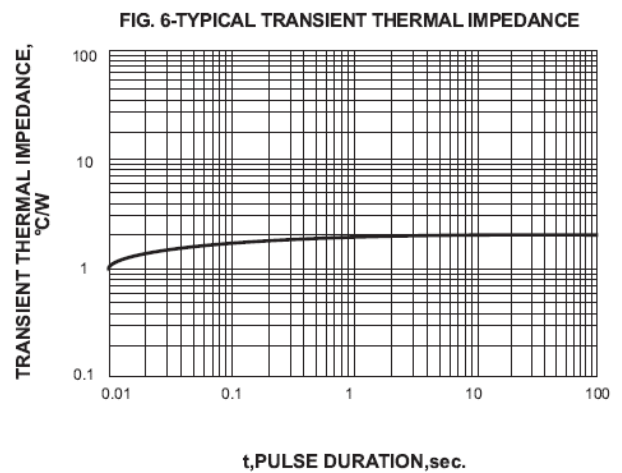
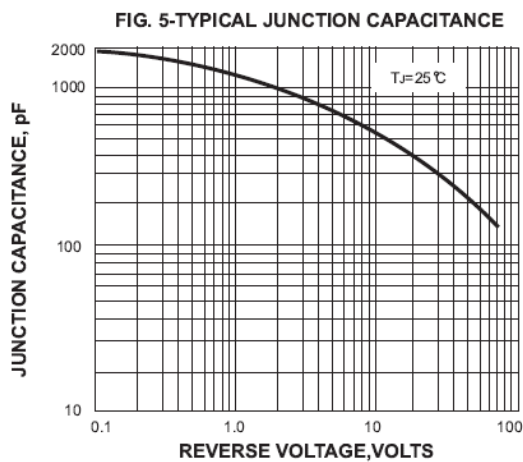
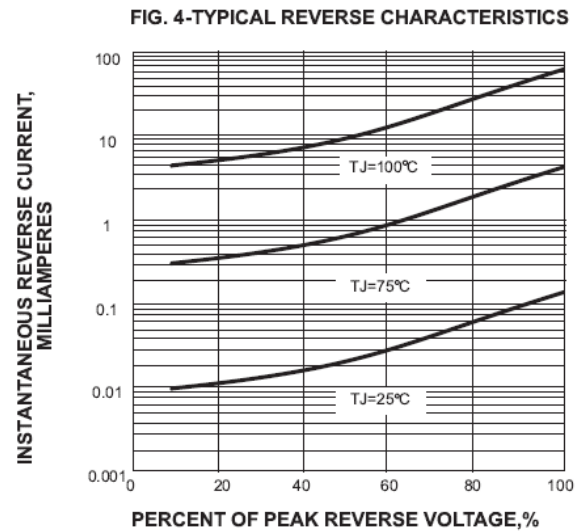
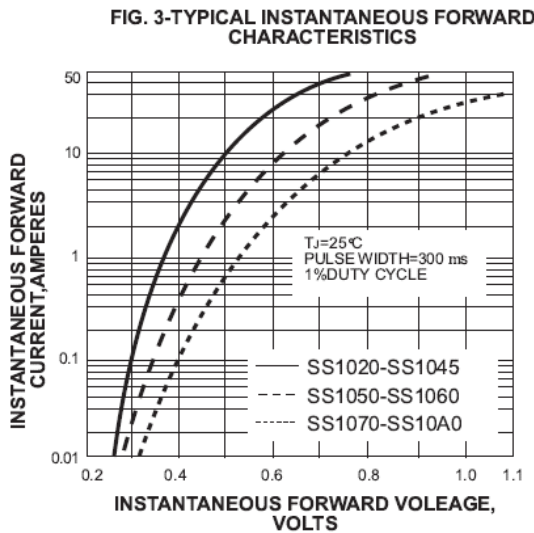
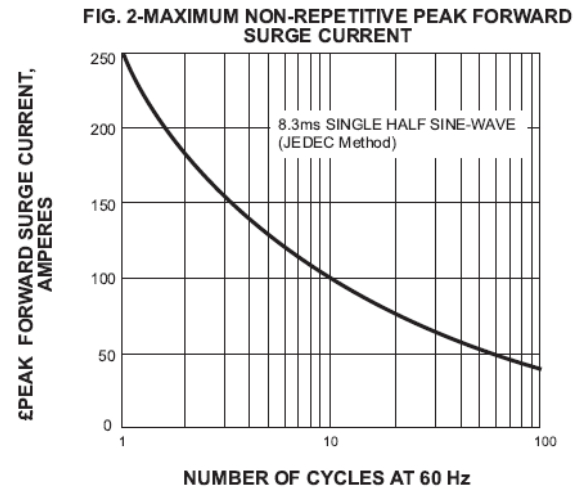
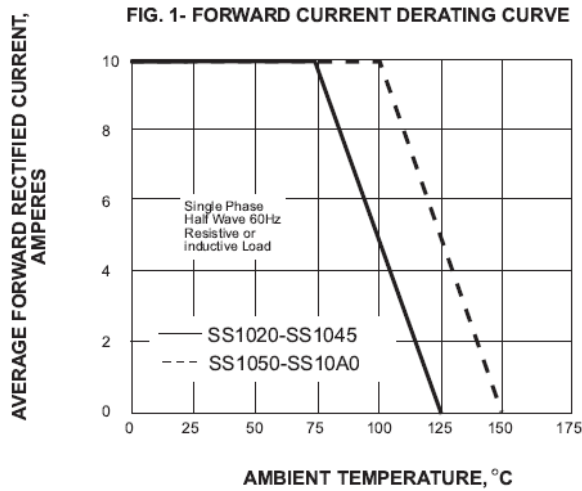

PACKAGE	SPQ/PCS	CARTON SPQ/PCS	CARTON SIZE/CM	CARTON GW/KG	CARTON NW/KG
SMC	3000/REEL	42000	36X36X36.5	18.50	15.50