

Nut Torque:5~14Nm  
 Operating Pressure:400gf ±200gf  
 Operating Stroke:1.8mm±0.5  
 Protection Grade:IP65,IK08  
 Function:(ON)-OFF  
 Contact:Silver Alloy  
 Base:PA66  
 Shell:SUS  
 Button:SUS  
 Rating(Resistive load):3A 250V AC  
 Contact Resistance:50mΩ Max.  
 Insulation Resistance:100MΩ Min.  
 Dielectric Strength:1500V AC 1 minute  
 Electrical life:50,000 cycles  
 Mechanical life:100,000 cycles  
 Operating Temperature:-20°C~80°C  
 Relative Air Humidity:45%~85%  
 Safety Approval:CE RoHS CQC

CUT-OUT

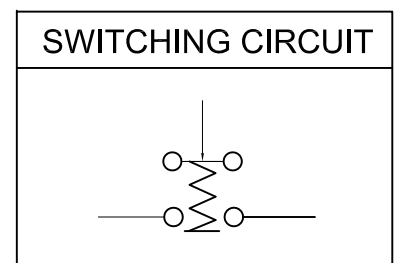
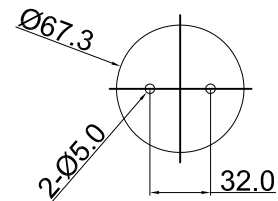

				公差 TOLERANCES		角度 ANGLE ±1°		单位 DIMENSION UNIT	
				.X± 0.5	.XX± 0.3			mm.	
		版本 VERSION	A0	比例尺 SCALE	1:1	日期 DATE	2022.03.11	品名 TITLE	图号 DRAWING NO
		核准		核对		绘图	孙成	PBM-16B2	1011368
版本 VER.	变更说明 CHANGE DESCRIPTION	日期 DATE	ECN NO.	APPROVED BY	CHECKED BY	DRAWN BY			