

# PRODUCT SPECIFICATION

版本号  
Version Number: \_\_\_\_\_

产品编码  
PART Number: \_\_\_\_\_

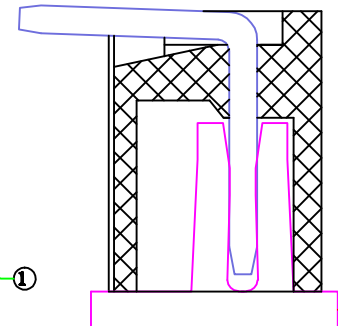
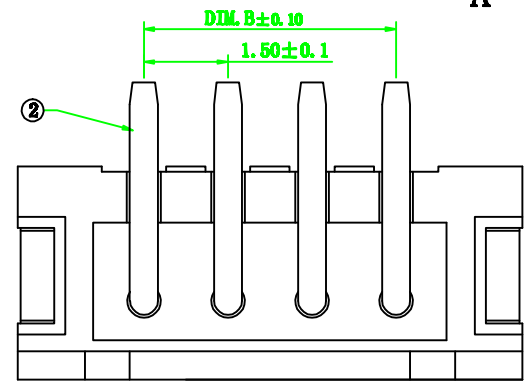
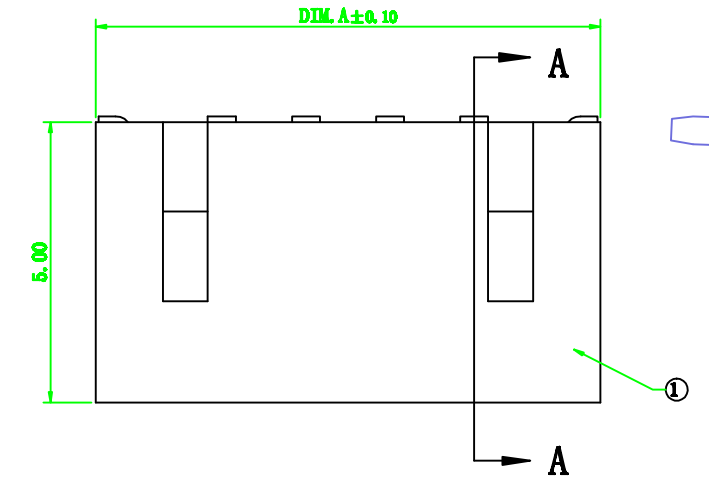
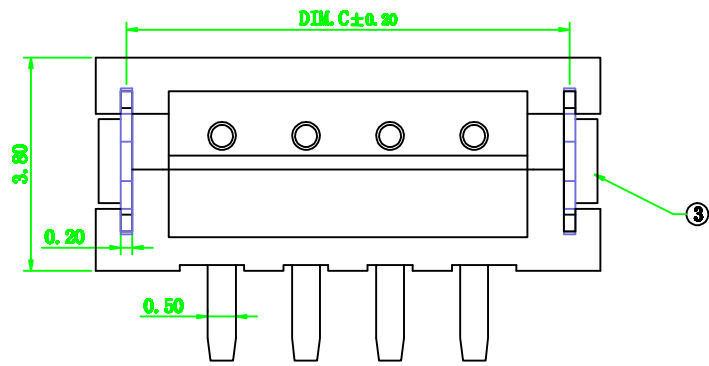

SECTION A-A

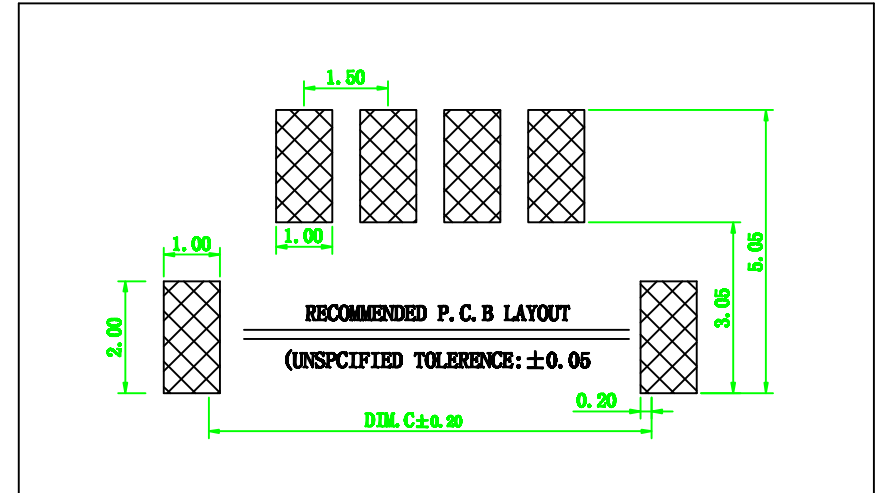

11	19.50	15.00	18.40				
10	18.00	13.50	16.90	20	33.00	28.50	31.90
9	16.50	12.00	15.40	19	31.50	27.00	30.40
8	15.00	10.50	13.90	18	30.00	25.50	28.90
7	13.50	9.00	12.40	17	28.50	24.00	27.40
6	12.00	7.50	10.90	16	27.00	22.50	25.90
5	10.50	6.00	9.40	15	25.50	21.00	24.40
4	9.00	4.50	7.90	14	24.00	19.50	22.90
3	7.50	3.00	6.40	13	22.50	18.00	21.40
2	6.00	1.50	4.90	12	21.00	16.50	19.90
POS.	DIM. A	DIM. B	DIM. C	POS.	DIM. A	DIM. B	DIM. C

③	定位片	2pcs	Copper alloy 黄铜镀锡
②	pin针	npcs	Copper alloy 黄铜镀锡
①	底座	1pcs	Material: High-temperature plastic, COLOR: NATURAL 材料: 耐高温塑料 颜色: 本色 米黄
NO.	PART NAME:	Q'TY	DESCRIPTION 类型

GENERAL TOLERANCES 一般公差			
DIM	TOL	DIM	DEG
X		X'	±3.00°
X.X	±0.25	X.X'	±2.00°
X.XX	±0.20	X.XX'	±1.00°
X.XXX	±0.15	X.XXX'	

DRAW :	林加才	2016.06.01
DESIGN:	林加才	2016.06.01
CHECK:	朱精峰	2016.06.01
APPROVED	朱精峰	2016.06.01
CUSTOMER DRAWING 客户图纸		

名称 TITLE:	1.50 Pitch ZH Connector	DRAW NAME:	ZH1.5-A 贴片式连接器
SERIES:		DRAW NO.	
P/N:		UNIT:	SHEET:
REV. 1.00	SCALE N/A	1/1	