

2.4GHz 1005 Low Pass Filter: LPF1005R240010K50

Applications:

WLAN, 802.11b/g, Bluetooth, ISM Band...

Features

SMD, high reliability, ultra Impact...

Part number

LPF 1005 R 2400 10K 50
 (1) (2) (3) (4) (5)

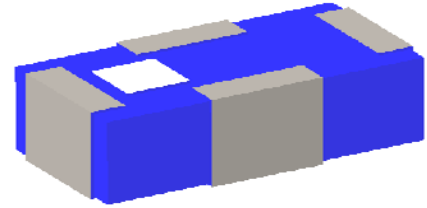

(1) Size Code	1.0x0.5mm
(2) Packing	Tape and reel
(3) Frequency	2.4~2.5GHz
(4) Packing Number	10K
(5) TYPE	50

Electrical Specification

Pass Band	2400~2500MHz
Impedance	50 Ohm
Insertion Loss	0.5 dB (Max) at 25°C
Attenuation	25dB Min @ 4880~5000 MHz 25dB Min @ 7200~7500 MHz
VSWR	2.0 (Max)
Ripple	0.50dB

The specification is defined on EVB.

Dimension and Terminal Configuration

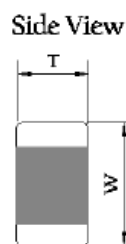
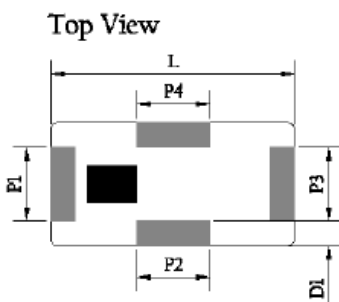

Side View

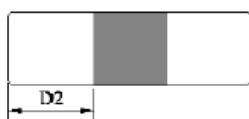

Dimension (mm)	
L	1.00±0.10
W	0.50±0.10
T	0.35±0.10
P1	0.30 ±0.15
P2	0.30 ±0.15
P3	0.30 ±0.15
P4	0.30 ±0.15
D1	0.15 ±0.10
D2	0.35 ±0.15

No.	Terminal Name
P1	Input
P2	GND
P3	Output
P4	GND

2.4GHz 1005 Low Pass Filter: LPF1005R240010K50

Evaluation Board Reference

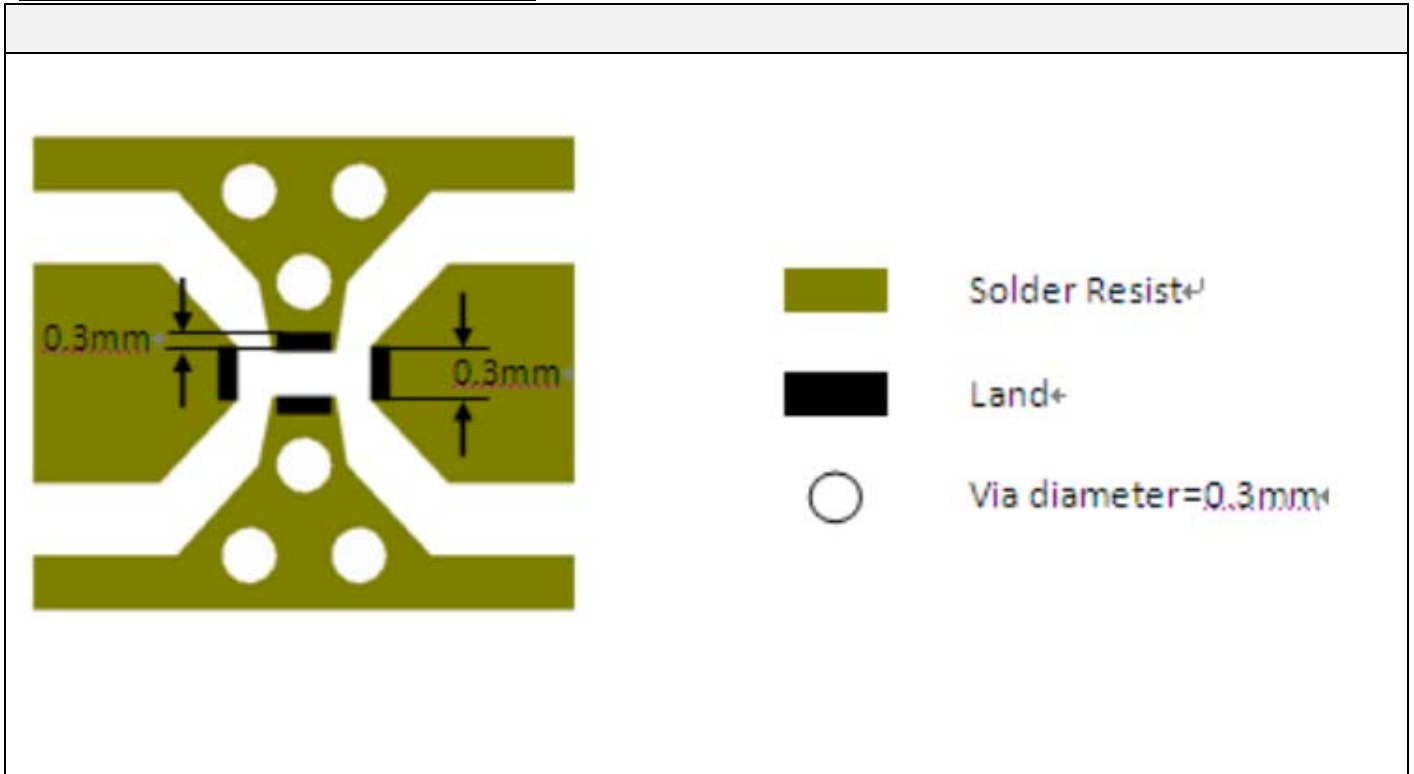

Electrical Characteristics

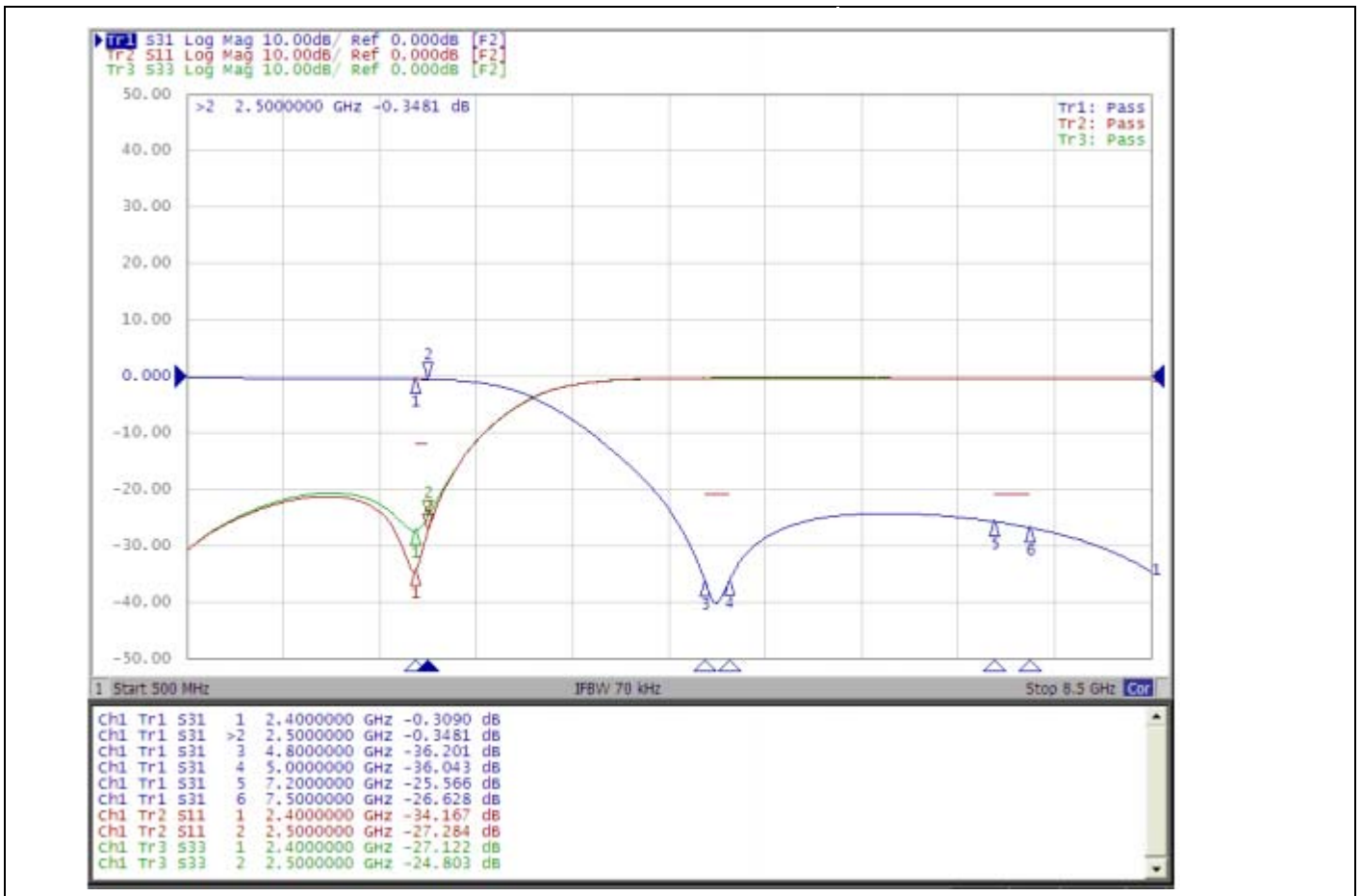

2.4GHz 1005 Low Pass Filter: LPF1005R240010K50

Taping Specifications

Reel and Taping Specification

Reel Specification

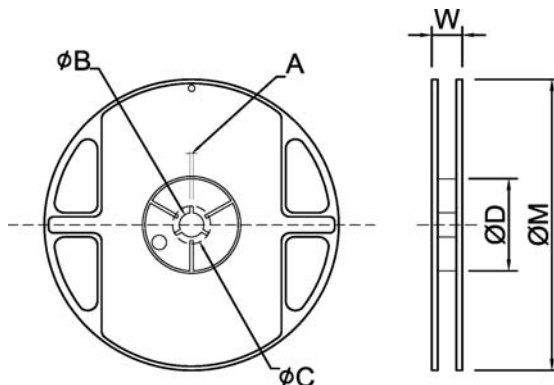

TYPE	SIZE	A	ϕB	ϕC	ϕD	W	ϕM	
1005	7"	10K/Reel	2.0±0.5	13.5±1.0	21±1.0	60±1.0	11.5±2.0	178±2.0

Taping Specification

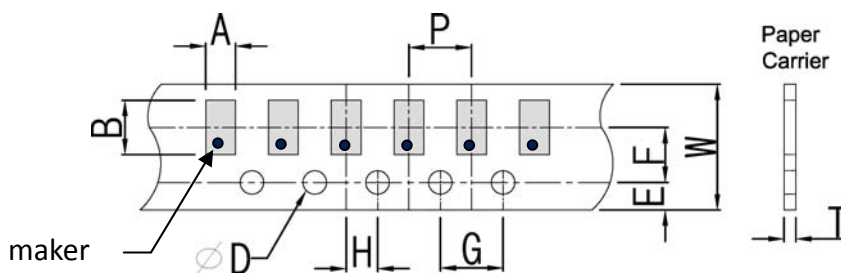

Packaging	Type	A	B	W	E	F	G	H	T	ϕD	P
Paper Type	1005	1.40±0.20	2.20±0.20	8.0±0.20	1.75±0.10	3.0±0.05	4.0±0.10	2.0±0.05	0.75±0.10	1.50 +0.10 -0	4.0±0.1

2.4GHz 1005 Low Pass Filter: LPF1005R240010K50



Recommended Reflow Profile

Pb free solder

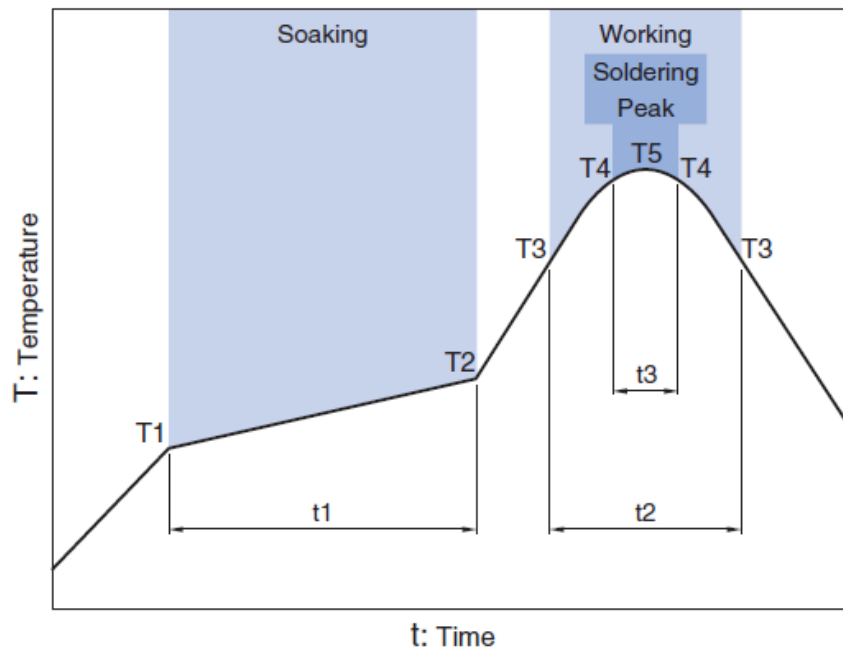

Soaking		Working		Soldering		Peak	
Temp.	Time	Temp.	Time	Temp.	Time	Temp.	
T1	T2	t1	T3	t2	T4	t3	T5
150°C	180°C	60 to 120sec	230°C	more than 30sec	247 to 253°C	within 10sec	260°C Max.

March 2019 Ver.H01