

REVISION			
LTR	DESCRIPTION	DATE	APP
A0	NEW RELEASE	02/14/2022	PECK

SPECIFICATIONS:

- ELECTRICAL CHARACTERISTICS:
 - CONTACT RESISTANCE: 30mΩ MAX.
 - DIELECTRIC WITHSTANDING VOLTAGE: 100V AC FOR ONE MINUTE.
 - INSULATION RESISTANCE: 100MΩ MIN. MEASURED BY 500 VDC
- MECHANICAL CHARACTERISTICS:
 - INSERTION FORCE :0.5-2.0Kgf(REF.)
 - WITHDRAWAL FORCE :0.8-2.0Kgf(REF.)
- LIFE TEST: 10,000 CYCLES.
- TO CONFORM TO THE KRCONN HAZARDOUS SUBSTANCE FREE SPEC.

PIN	Signal NAME	PIN	Signal NAME
A 1	GND	B12	GND
A 4	V BUS	B 9	V BUS
A 5	CC1	B8	SBU2
A 6	Dp1	B 7	Dn2
A 7	Dn1	B 6	Dp2
A8	SBU1	B 5	CC2
A 9	V BUS	B 4	V BUS
A12	GND	B 1	GND

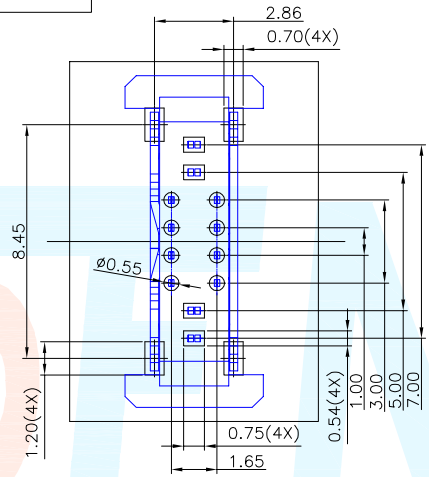
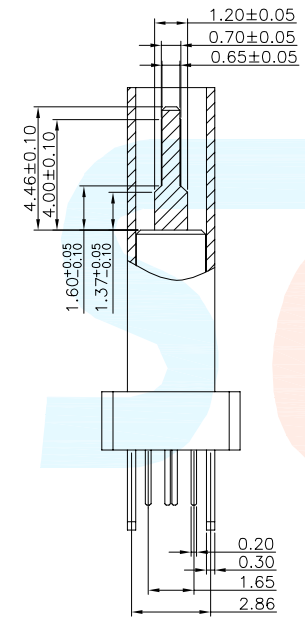
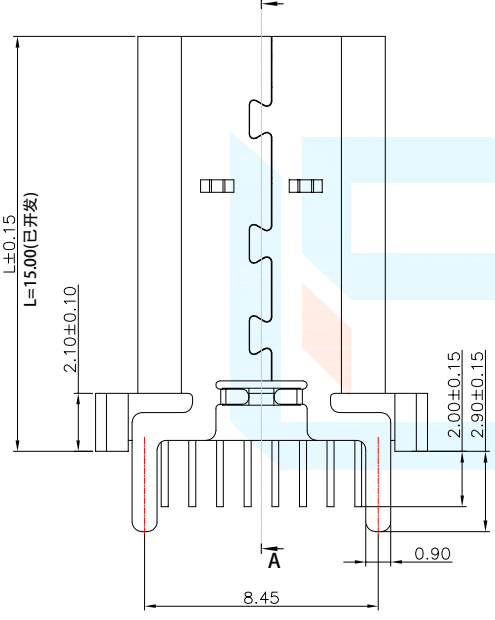
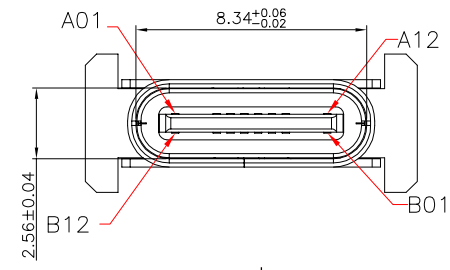
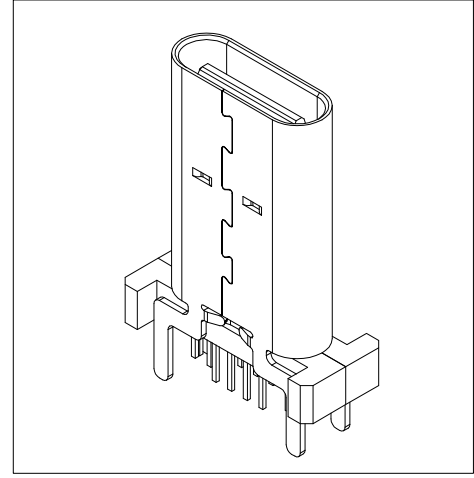
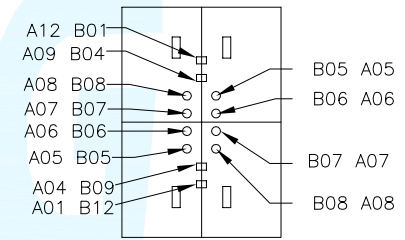

RECOMMENDED P.C.B. LAYOUT (T:1.00mm)
TOLERANCE UNSPECIFIED ±0.05mm

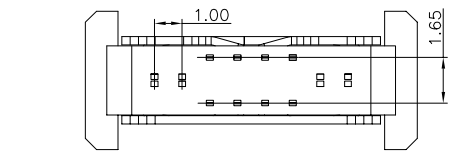

NO.	DESCRIPTION	MATERIAL	REMARKS	QTY
6	SHELL	STAINLESS STEEL	Ni Plated	1PCS
5	SHIELDING PLATE	STAINLESS STEEL	---	1PCS
4	MD	HIGH TEMPERATURE PLASTIC	BLACK	1PCS
3	CONTACT	COPPER ALLOY	Au/Ni Plated	1SET
2	CONTACT	COPPER ALLOY	Au/Ni Plated	1SET
1	HOUSING	HIGH TEMPERATURE PLASTIC	BLACK	1PCS

DIMENSION CLASSIFICATION
 ■ : CRITICAL
 ☒ : MAJOR

台灣碩方精密電子科技有限公司
TAIWAN SOFNG PRECISION ELECTRONIC CO., LTD



TITLE: MC-322D
16PIN立插式TYPE-C连接器

開關, 連接器
SOFNG

TOLERANCE TABLE		PART NO.	SERIES
.X	± 0.40		SD106
.XX	± 0.25	APPROVED	Peck
.XXX	± 0.10	CHECKED	Paul
ANGLE	± 2°	DRAWIN	David

SCALE	UNIT	SIZE
1:1	mm	A4

SHEET NO. 1/1