

Ordering Information:

C2521HF-XP - **
1 2

1.Part No.

2.Color:

(blank):Black

WH:White

SPECIFICATIONS:

Current Rating: 3A AC,DC

Voltage Rating: 250V AC,DC

Temperature Range: -40°C ~ +105°C

Contact Resistance: 10mΩ Max

Insulation Resistance: 500MΩ Min

Withstanding Voltage: 1500V AC/minute

Material: Nylon 66,UL94V-0 (Black)

Ordering Information & Dimensions

Circuits	Dimensions(mm)		Circuits	Dimensions(mm)	
	A	B		A	B
2P	2.50	5.65	8P	17.50	20.65
3P	5.00	8.15	9P	20.00	23.15
4P	7.50	10.65	10P	22.50	25.65
5P	10.00	13.15	11P	25.00	28.15
6P	12.50	15.65	12P	27.50	30.65
7P	15.00	18.15			

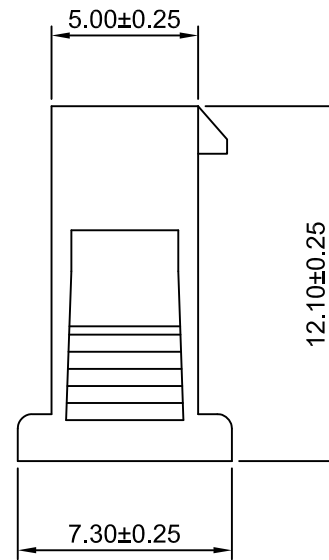
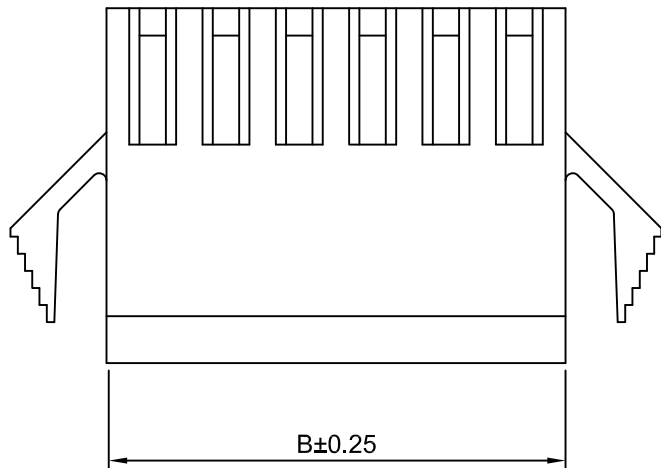

CJTconn

CHANGJIANG CONNECTORS CO.,LTD.

Unit: mm, Scale: 4:1, Sheet: 1 of 1

Title:

2.50mm PITCH

Draw By:

Dlankul Wan

Approved:

Jack Yin

SINNGLE ROW HOUSING

General Tolerance

REV	DESCRIPTION	DATE	PROJECT
A1	CHANGE THE SIZE	2018.11.23	x.xx±0.25
A0	NEW RELEASE	2013.12.11	x.xx±0.20
			x.xxx±0.15

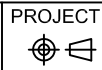

DRAW NO: C2521HF-XP

REV A1