

REV	MARK	DESCRIPTION	DRAFTED. BY	DATE

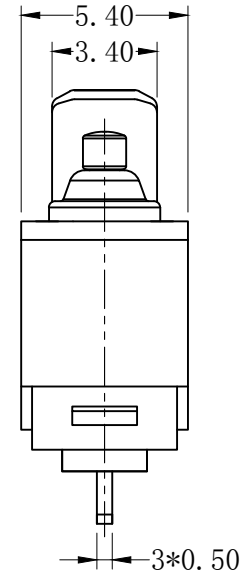

Circuit Diagram

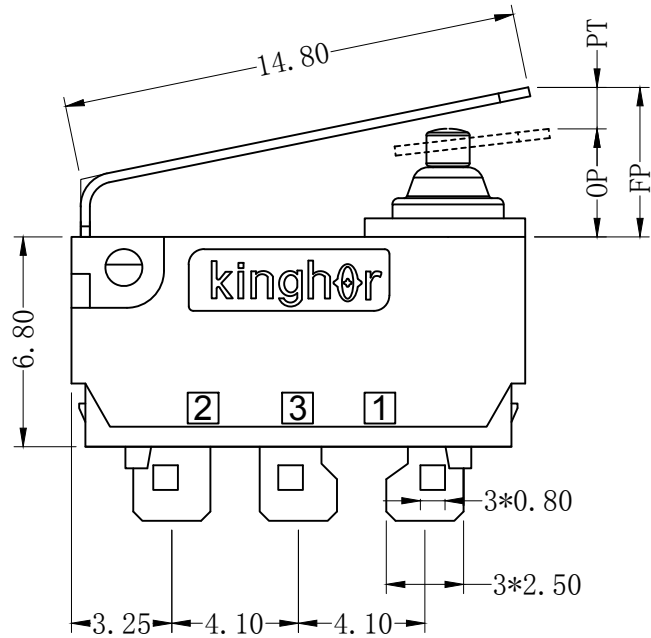
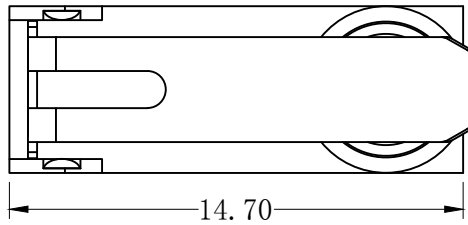
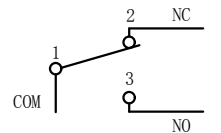

CHARACTERISTICS	
OPERATING FORCE (OF):	195gf Max.
RELEASE FORCE (RF):	25gf Min.
OPERATING POSITION:	3.7 ± 0.6 mm.
PRE TRAVEL:	3.5mm Max.
DIFFERENTIAL TRAVEL:	0.6mm Max.
FREE POSITION:	6.8mm Max.

ELECTRICAL DATA	
RATING	OPERATING LIFE
3A 12VDC	100,000 CYCLES
0.1A 48VDC 125/250VAC	100,000 CYCLES

MECHANICAL LIFE	500,000 CYCLES
GAP TYPE	MICRO
OPERATING TEMP	-40°C ~ +85°C
WATERPROOF	IP67

OUTLINE DRAWING				TOLERANCE UNLESS OTHERWISE SPECIFIED						
TITLE	H3 SERIES MICRO SWITCH			≤3	1~3	3~10	10~30	30~100	100~200	ANGLE
MODEL	H3-A1			±0.2	±0.3	±0.4	±0.6	±1.0	±1.5	±3.0°
PART NO.	H3-A1-1D02S									
DRAFTED BY	Bing Wang	DATE	2020-6-15							
CHECKED BY	Hua Bai	DATE	2020-6-15							
APPROVED BY	Hong Chen	DATE	2020-6-15	SCALE		UNIT		VERSION REV		A1
KINGHOR										
SWITCHES AND CONTROL EXPERT										