

RoHS

SPECIFICATIONS

Rated Current:3.0AMP
 Contact Resistance:20mΩ Max
 Withstand Voltage:1000V AC/DC
 Insulation Resistance:1000MΩ Min
 Operation Temperature:-40°c to +105°c

Contact Material:Brass
 Contact Plating:Au Over Ni
 Insulator Material:Polyester(UL94V-0)
 Standard: PA6T
 Max.Processing Temp: 230°C for 30-60 seconds
 (260°C for 10 seconds)

Recommended P.C.B Layout(Top Side)
 (PCB BOARD TOLERANCE±0.05)

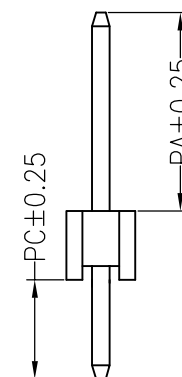
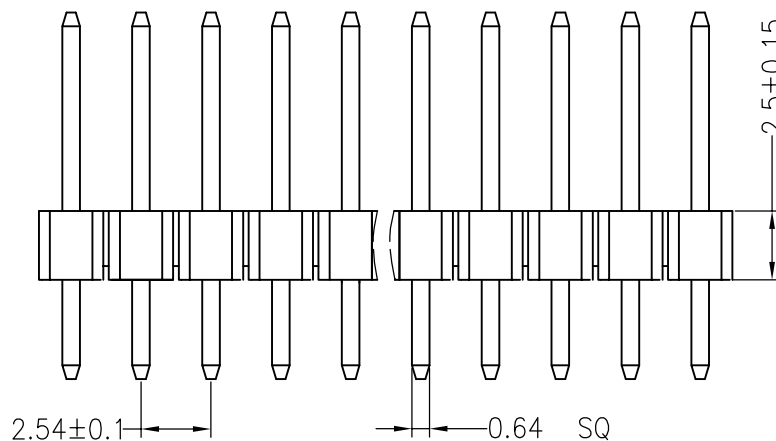
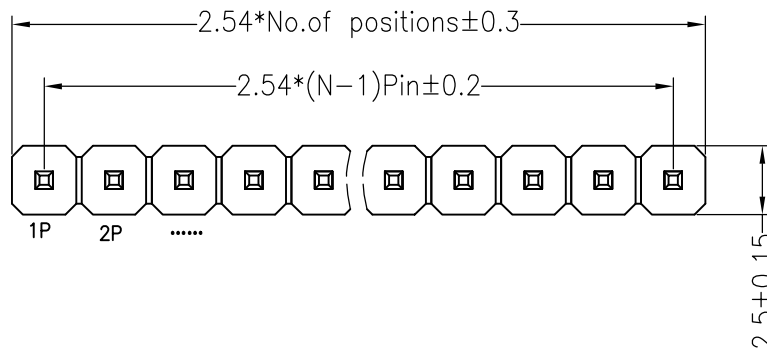
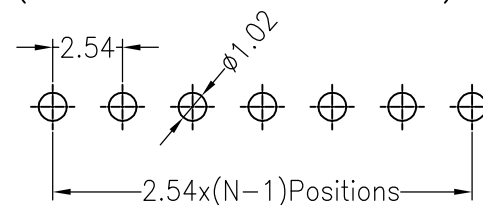

Dimension antitheses list			
ITEM	PA	PC	L
Standard	6.00	3.00	11.50
Alternate			

深圳市连盛精密连接器有限公司

				OPERATION			SCALE	FIT	PART NO. PH-00070	
				X.X ±0.30	DRAW		UNIT	mm		
				X.XX ±0.20	CHECK		SIZE	A4	TITLE: 2.54PH H=2.5 1X7P DIP PA6.0 PC3.0 L=11.5	
A0	2012.03.28	NEW DRAWING		X.XXX ±0.10	APPROVE		SHEET	1/1		
REV	DATE	MODIFICATION DESCRIPTION	CHANGE	Angle ±3'			PROJ.	☐		
				DIM TOL						