

RoHS

Recommended P.C.B Layout(Top Side)  
(PCB BOARD TOLERANCE±0.05)

SPECIFICATIONS

Rated Current:3.0AMP  
Contact Resistance:20mΩ Max  
Withstand Voltage:1000V AC/DC  
Insulation Resistance:1000MΩ Min  
Operation Temperature:-40°C to +105°C

Contact Material:Brass  
Contact Plating:Au Over Ni  
Insulator Material:Polyester(UL94V-0)  
Standard: PA6T  
Max.Processing Temp: 230°C for 30-60 seconds  
(260°C for 10 seconds)

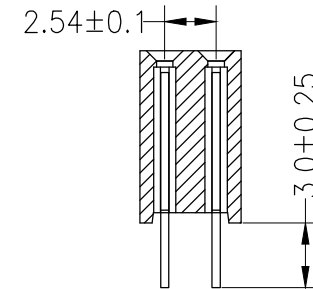
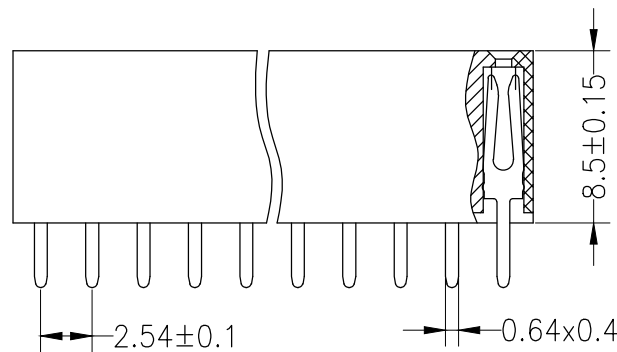
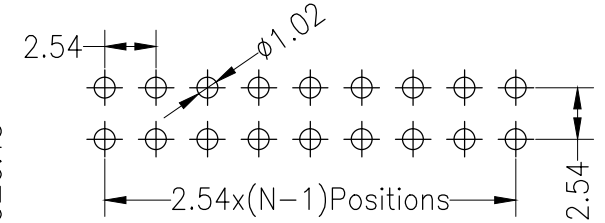
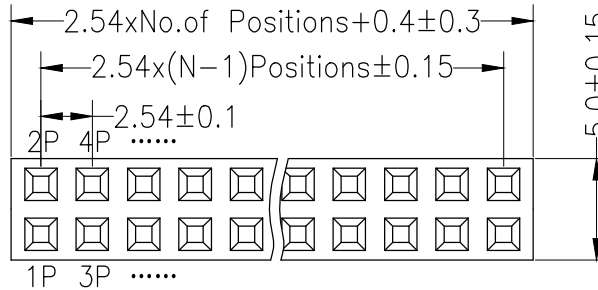

				OPERATION		DRAW		SCALE	FIT	深圳市连盛精密连接器有限公司	
				X.X	±0.30			UNIT	mm		
				CHECK				SIZE	A4	PART NO.	
				APPROVE				SHEET	1/1	FH-00870	
REV	DATE	MODIFICATION DESCRIPTION		CHANGE	DIM	TOL		PROJ.		TITLE:	2.54FH H8.5 2x10pin 180° W5.0mm