

SPM Series
SMT Power Metal Inductor
Size 4020

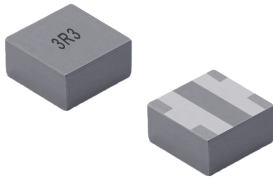

FEATURES

- Large current, Low DC-resistance, High efficiency by magnetic metal powder
- Low acoustic noise and low leakage flux noise by shielded construction
- Operating temperature: -40 °C ~ 125 °C
- Quantity: 1000 pcs/reel

Dimensions: [mm]

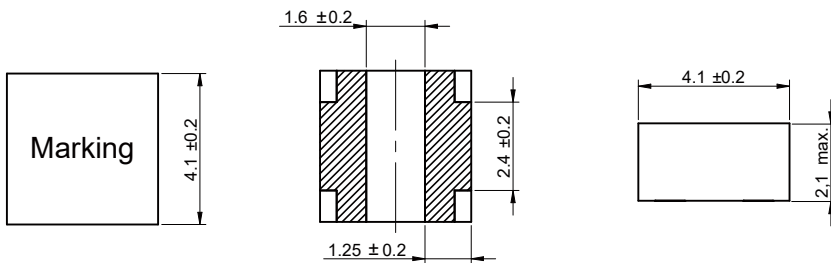

Land Pattern: [mm]

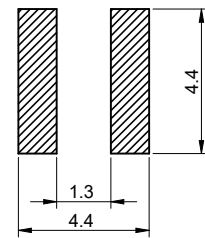

Electrical Properties:

| Part No | Inductance (μH) | Tolerance | Temperature Rise Current Typ. (A) | Saturation Current Typ. (A) | DCR Max. (mΩ) | DCR Typ. (mΩ) |
|--------------|-----------------|-----------|-----------------------------------|-----------------------------|---------------|---------------|
| SPM4020-R22N | 0.22 | ± 30% | 9.00 | 13.10 | 7.5 | 5.5 |
| SPM4020-R33N | 0.33 | ± 30% | 8.90 | 10.30 | 8.0 | 6.0 |
| SPM4020-R56N | 0.56 | ± 30% | 7.90 | 9.00 | 9.0 | 7.0 |
| SPM4020-1R0M | 1.0 | ± 20% | 6.70 | 7.30 | 16 | 13 |
| SPM4020-1R5M | 1.5 | ± 20% | 5.40 | 6.30 | 21 | 17 |
| SPM4020-2R2M | 2.2 | ± 20% | 4.20 | 5.40 | 35 | 29 |
| SPM4020-3R3M | 3.3 | ± 20% | 3.30 | 4.40 | 48 | 40 |
| SPM4020-4R7M | 4.7 | ± 20% | 2.90 | 4.00 | 76 | 63 |
| SPM4020-5R6M | 5.6 | ± 20% | 2.80 | 3.40 | 81 | 68 |
| SPM4020-6R8M | 6.8 | ± 20% | 2.30 | 3.20 | 116 | 97 |
| SPM4020-100M | 10 | ± 20% | 1.80 | 2.70 | 193 | 161 |

Inductance is measured at 100kHz.

Temperature rise current: the actual value of DC current when the temperature rise is ΔT40 °C.

Saturation Current that will cause initial inductance to drop approximately 20%.

Typical Electrical Characteristics:

