

GoldMax 300 Comm X7R, Ceramic, 4700 pF, 10%, 50 VDC, X7R, GoldMax, Commercial Standard, Lead Spacing = 2.54mm

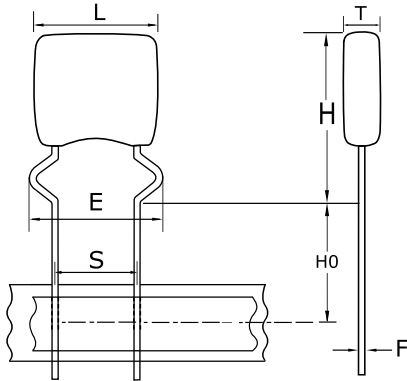

| Dimensions |                      |
|------------|----------------------|
| L          | 3.81mm MAX           |
| H          | 5.84mm MAX           |
| T          | 2.54mm MAX           |
| S          | 2.54mm +/-0.78mm     |
| H0         | 16mm +/-0.5mm        |
| F          | 0.51mm +0.1/-0.025mm |
| E          | 5.08mm NOM           |

| Packaging Specifications |            |
|--------------------------|------------|
| Packaging:               | T&R, 305mm |
| Packaging Quantity:      | 2500       |

| General Information |   |
|---------------------|---|
| Series:             | GoldMax 300 Comm X7R  |
| Style:              | Radial  |
| Description:        | GoldMax, Commercial Standard  |
| RoHS:               | No  |
| Prop 65:            | <b>WARNING:</b> Cancer and reproductive harm - <a href="http://www.p65warnings.ca.gov">www.p65warnings.ca.gov</a> . |
| REACH:              | SVHC (Pb - CAS 7439-92-1)   |
| SCIP Number:        | d4c83dcf-0af3-4f6a-8c42-c840cabd6f5b  |
| Termination:        | Lead (SnPb)   |
| Failure Rate:       | N/A   |
| AEC-Q200:           | No  |
| Halogen Free:       | Yes   |

| Specifications  |                     |
|---|---------------------|
| Capacitance:  | 4700 pF             |
| Measurement Condition:  | 1 kHz 1.0Vrms       |
| Capacitance Tolerance:  | 10%                 |
| Voltage DC:   | 50 VDC              |
| Dielectric Withstanding Voltage:                                    | 125 VDC             |
| Temperature Range:  | -55/+125°C          |
| Temperature Coefficient:  | X7R                 |
| Capacitance Change with Reference to +25°C and 0 VDC Applied (TCC): | 0.15, 1kHz 1.0Vrms  |
| Dissipation Factor:   | 2.5% 1 kHz 1.0Vrms  |
| Aging Rate:   | 3% Loss/Decade Hour |
| Insulation Resistance:  | 100 GOhms           |