

# HSF

Recommended P. C. B Layout (Top Side)  
 (PCB BOARD TOLERANCE  $\pm 0.05$ )

- NOTES:
- Current Rating: 1AMP
  - Contact Resistance: 20mΩ max
  - Withstand Voltage: 500V AC/DC
  - Insulation Resistance: 1000MΩ min
  - Operation Temperature: -40°C to +105°C
  - Contact Material: Brass
  - Contact plating: Au or Sn Over Ni
  - Insulator Material: PA9T+30%GF (UL94V-0)

## Ordering Information

3130-XX M XX BK00 X 2

- |             |                   |                 |                 |
|-------------|-------------------|-----------------|-----------------|
| No. of Pins | Contact Plating   | Color Insulator | Packing         |
| 10 34       | G0=Gold Flash     | B=Black         | A=Tray          |
| 14 40       | G1=3u"Gold        | U=Blue          | T=Tube          |
| 16 44       | G2=5u"Gold        | W=White         | P=Tube+CAP      |
| 20 50       | G3=10u"Gold       |                 | R=Tape&Reel+CAP |
| 24 60       | G4=15u"Gold       |                 |                 |
| 26 64       | G5=30u"Gold       |                 |                 |
| 30 80       | S0=Gold Flash/Tin |                 |                 |
| 32 100      | S1=3u"Gold/Tin    |                 |                 |
|             | S2=5u"Gold/Tin    |                 |                 |
|             | S3=10u"Gold/Tin   |                 |                 |
|             | S4=15u"Gold/Tin   |                 |                 |
|             | S5=30u"Gold/Tin   |                 |                 |
|             | SN=Tin            |                 |                 |

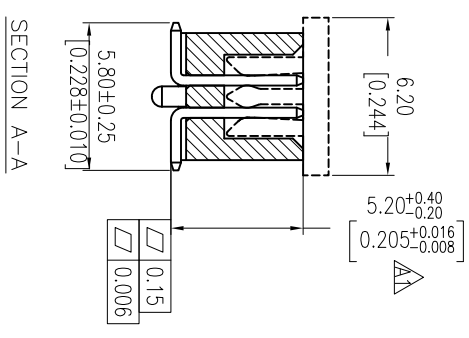
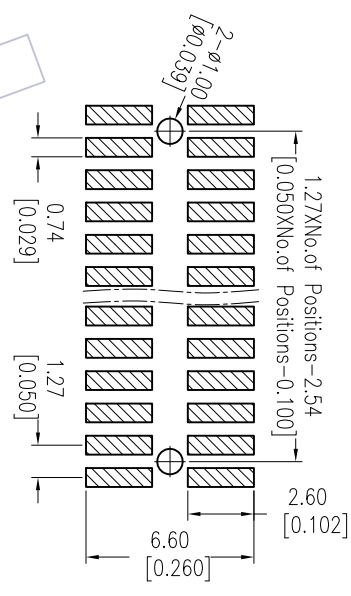
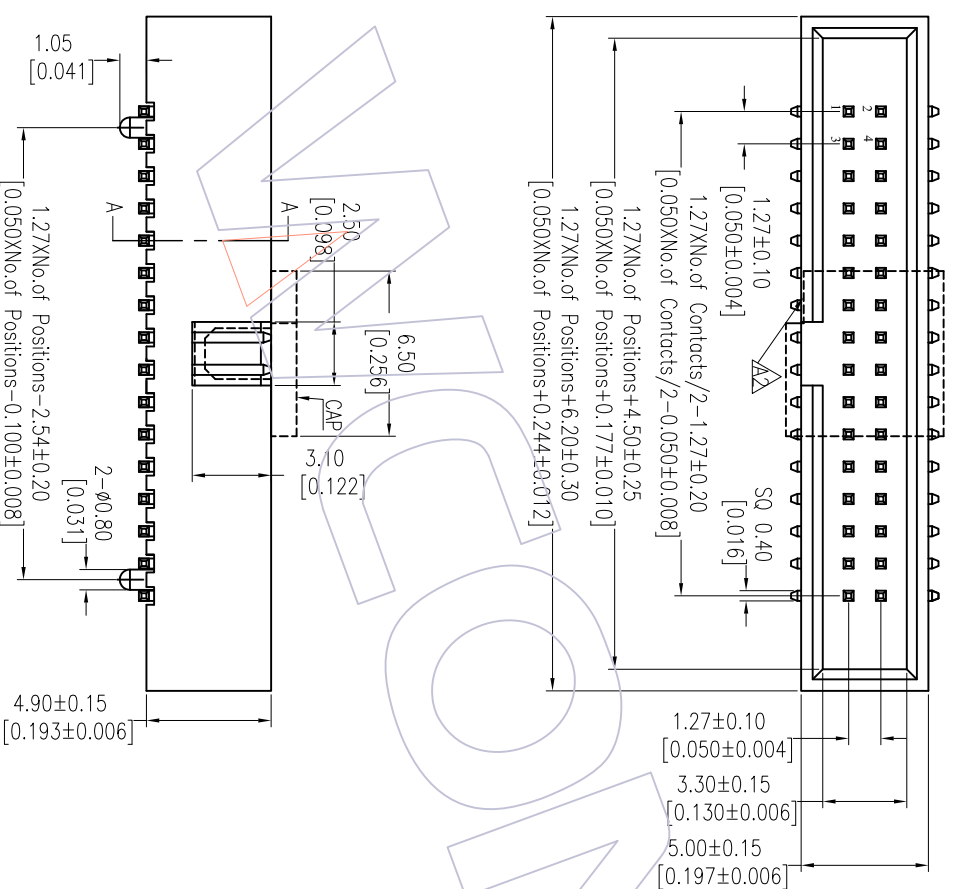

REV	DATE	MODIFICATION DESCRIPTION
A0	2008/04/25	NEW
A1	2010/09/30	Change drawing
A2	2012/08/31	Modify CAP

OPERATION			DRAW		DATE		SCALE		FIT		PART NO.	
XX			Tsingsn		2012/08/31		mm		1/1		3130-XXXXXBK00X2	
XX XX			CHECK		DATE		UNIT		inch		TITLE:	
X.XXX			±0.25		DATE		SIZE		A4		1.27 BOX HEADER SMT	
±0.15			APPROVE		DATE		SHEET		1/1		H=4.90 WITH POST	
± 3'			CHANGE		DATE		PROJ.		Customer NO.			
DWM			TOL		DATE		PROJ.		Customer NO.			

# WCON

Http: www.wcon.com

WCON-Dongguan Tel: +86 769 85358920 Fax: +86 769 85358915 E-mail: sdes@wcon.com

WCON-Kunshan Tel: +86 512 57468408 Fax: +86 512 57468468 E-mail: sdesks@wcon.com