

SPECIFICATION FOR APPROVAL

REF. :

PROD. NAME	Shielded SMD Power Inductor	ABC'S DWG NO.		GSSC1040151M□□□	
		REV.	20200805	PAGE	1

I . Configuration and dimensions :

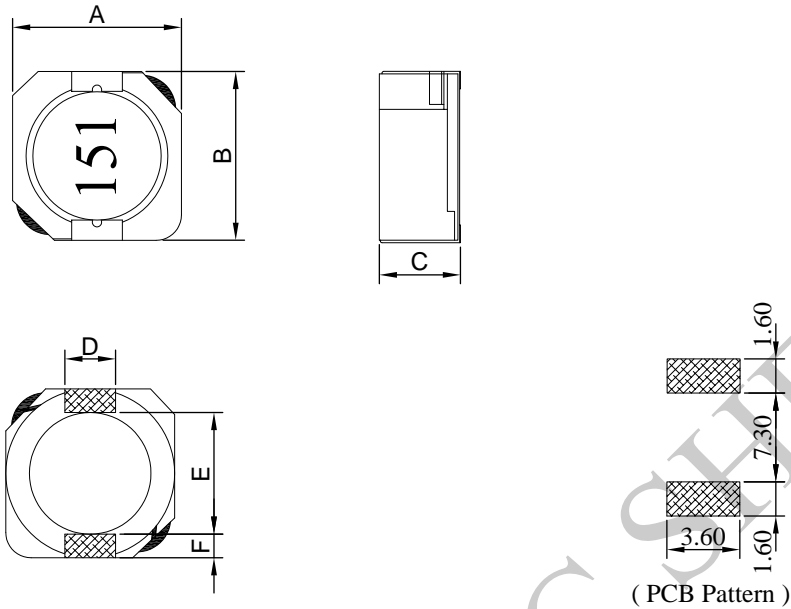

Unit : mm

A	B	C	D	E	F
10.50 max.	10.60 max.	4.20 max.	3.00 typ.	7.70 typ.	1.20 typ.

II . Description :

- a . Ferrite drum core construction.
- b . Magnetically shielded.
- c . Enamelled copper wire : H class
- d . Product weight : 1.50g (ref.)
- e . Moisture sensitivity Level 1
- f . Products comply with RoHS' requirements
- g . Halogen free

Peak temp. : 245°C max.
 Max. peak temp. - 5°C : 30sec. max.
 Max. time above 217°C : 60sec.~150sec. max.

III . General specification :

- a . Storage temp. : -40°C ----+125°C
- b . Operating temp. : -40°C ----+125°C
(Temp. rise included.)
- c . Resistance to solder heat : 260°C.10 secs.

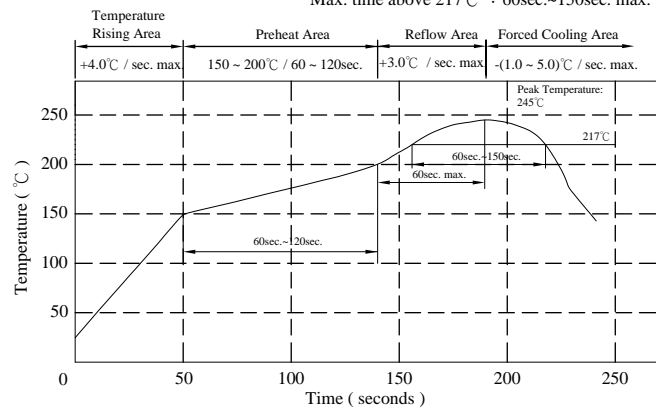

AR-001C

SPECIFICATION FOR APPROVAL

REF. :

PROD. NAME	Shielded SMD Power Inductor	ABC'S DWG NO.	GSSC1040151M□□□		
		REV.	20200805	PAGE	2

IV . Electrical characteristics :

DWG No.	Inductance (μ H)	Test Freq. (Hz)	RDC ($m\Omega$) max.	Isat (A) max.	Irms (A) max.
GSSC1040151M□□□	150.0 \pm 20%	100k/0.25V	506.0	0.85	0.85

- 1). Electrical specifications at 25°C
- 2). Isat base on $\Delta L/L0A=35\%$ max. (Approximately transient current)
- 3). Irms base on temp. rise 40 max.

DRAFT SPEC SHEET

AR-001C