



Shanghai Keter Polymer Material Co., Ltd.

N0.736 East Zhuanxing Road, Shanghai, China
 TEL: 0086-21-33505870 FAX: 0086-21-33506335
 Web: www.keter.com.cn Email: info@keter.com.cn

Polymer PTC Device

Chip Type resettable fuse

KT250-110-27

Document:
 Revision: 2.0
 Page: 1 of 1

Physical Dimensions: (mm)

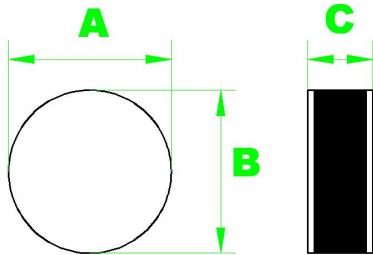

A	B	C
5.5(Type)	5.5(Type)	2.1(Type)

Electrical Characteristics:

Part Number	I_{hold} (A)	I_{trip} (A)	V_{max} (V)	I_{max} (A)	T_{trip}		R (Ω)		R_{1max} (Ω)
					current (A)	Time (s)	min	max	
KT250-110-27	0.15	0.25	250	3.0	0.25	≤ 60	8.5	10.5	18.0

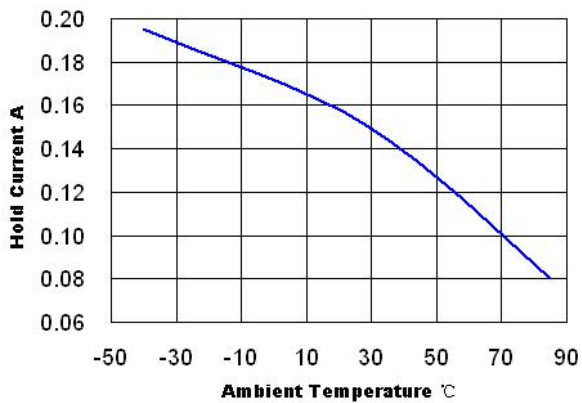

I_{hold} = Hold Current: maximum current at which the device will not trip at 29 °C still air.

I_{trip} = Trip Current: minimum current at which the device will always trip at 22 °C still air.

V_{max} = Maximum voltage device can withstand without damage at rated current.

I_{max} = Maximum fault current device can withstand without damage at rated voltage.

T_{trip} = Maximum time to trip(s) at assigned current.

R_{1max} = Maximum Device resistance at 25 °C, of device one hour after being tripped the first time.



Prepare	Approval	Accept