

NOTES1:

- UL Standard
- Rated voltage/current : 150V / 4A
- Withstanding voltage : AC1250V/1Min.
- Insulation Resistance:1000MΩ Min
- Contact Resistance:20mΩ Max

IEC Standard

1. Pollution degree	2	2	3
Overvoltage category	II	III	III
Rate impulse voltage(KV)	2.5KV	2.5KV	2.5KV
Rate voltage(V)	320V	250V	160V
Rate current(A)	5A		

NOTES2:

- 1.Dimension shall be interpreted per ASME Y14.5-2009
- 2.Pitch : 2.50mm, Poles : N=02~24P
- 3.Operating temperature: -40°C~+105°C
- 4.Undimensioned tolerances:

Pitch range in mm	Nominal dimension range					
	Over	Over	Over	Over	Over	Over
6	TO	TO	30	60	100	150
10	TO	TO	30	60	100	150
24	TO	TO	30	60	100	150
±0.15±0.20±0.30±0.30±0.50±0.70±1.00±1.30						±2'

5.RoHS Compliance

# Ordering Information

**JL15EDGVC - 250 XX G 02**

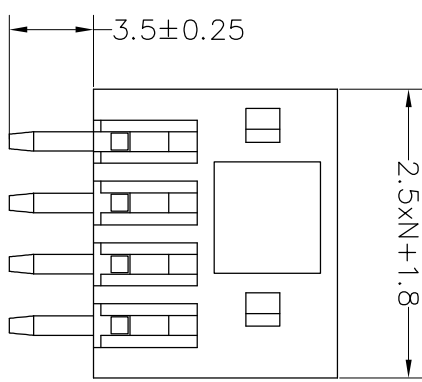
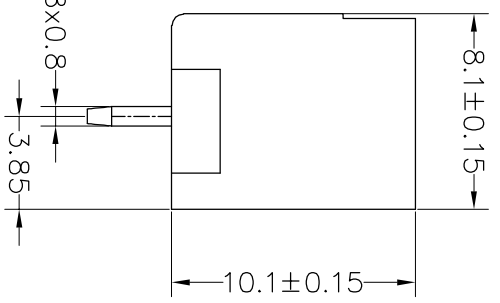
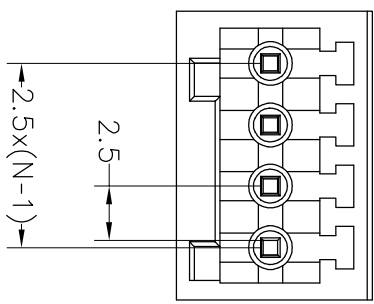
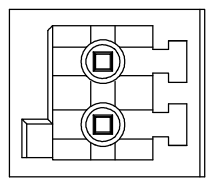
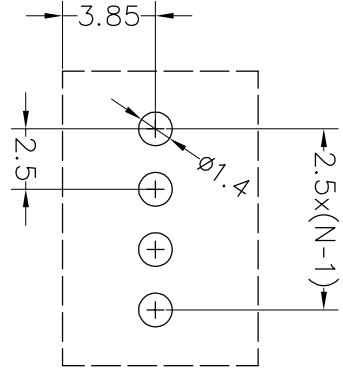
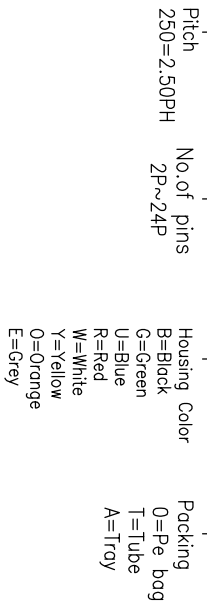

REVISION RECORD				
REV	ECN	DESCRIPTION	DRFT	DATE
A0		NEW		21.11.5

DRAW	SHUANGPING ZHENG		SCALE	FIT	PART NO.	JILIN® 东莞市锦凌电子有限公司 DONGGUAN JINLING ELECTRONIC CO., LTD
	CHECK	LICHAO LIU	UNIT	mm		
APPROVE	YONGLANG GAO		SIZE	A4	TITLE:	JL15EDGVC-2.50-XXP插拔式公座/绿色
			SHEET	1/1		
			PROJ.			