

P.C.B LAYOUT

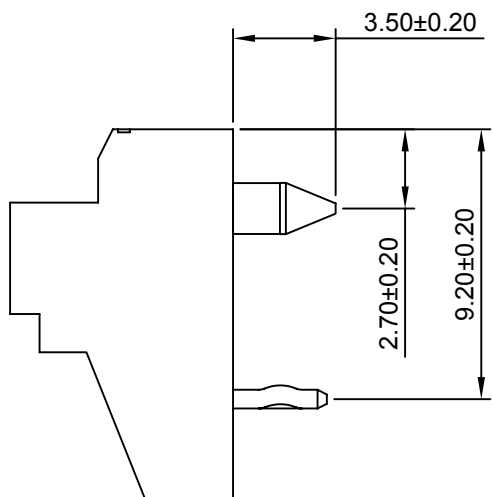
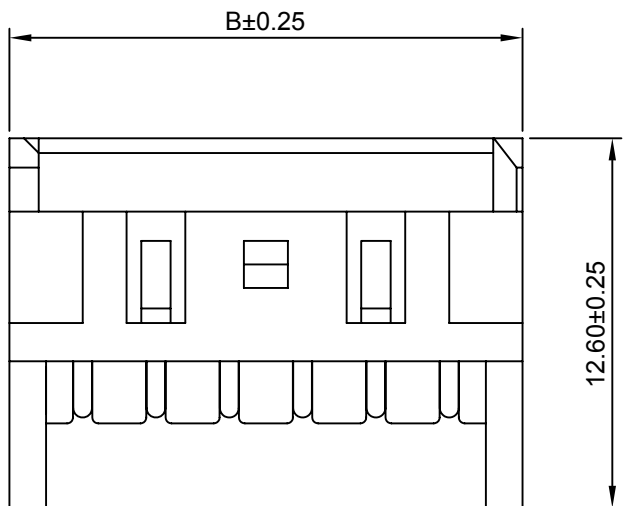

Ordering Information:

A2508WR-F-XP - \*\*  
1 2

1.Part No.

2.Color:

- (blank) - Ivory
- BK - Black
- RD - Red
- BL - Blue
- YL - Yellow
- GN - Green
- OR - Orange
- BR - Brown
- GY - Gray
- PK - Pink
- WH - White
- LY - Lemon yellow
- P - Purple
- LE - Light blue
- FY - Vivid yellow

SPECIFICATIONS:

Current Rating: 3A AC,DC  
 Voltage Rating: 250V AC,DC  
 Temperature Range: -40°C ~ +105°C  
 Contact Resistance: 10mΩ Max.  
 Insulation Resistance: 100MΩ Min.  
 Withstanding Voltage: 1000V AC/minute  
 Pin Material: Brass/Tin Over Nickel  
 Material: Nylon66 UL94V-0(Ivory)

Ordering Information & Dimensions

Circuits	Dimensions(mm)		Circuits	Dimensions(mm)	
	A	B		A	B
2P	2.50	7.50	9P	20.00	25.00
3P	5.00	10.00	10P	22.50	27.50
4P	7.50	12.50	11P	25.00	30.00
5P	10.00	15.00	12P	27.50	32.50
6P	12.50	17.50	13P	30.00	35.00
7P	15.00	20.00	14P	32.50	37.50
8P	17.50	22.50	15P	35.00	40.00



CHANGJIANG CONNECTORS CO.,LTD.

Unit	Scale	Sheet
mm	4:1	1 of 1
Draw BY:	Approved :	
Jack Yin	GONGYB	

Title :  
**2.50mm PITCH**  
**90° WAFER**

A1	Modify the color	2015.03.09	x.xs≤0.25	ANGLE± 
A0	NEW RELEEASE	2013.11.06	x.xx≤0.20	
REV	DESCRIPTION	DATE	x.xxx≤0.15	

DRAW NO : A2508WR-F-XP REV A1