

Model No.	POS.1	POS.2	POS.3
1AS1	ON	NONE	ON
Term. Comm.	2-3	OPEN	2-1
SCHEMATIC			

SWITCH FUNCTION

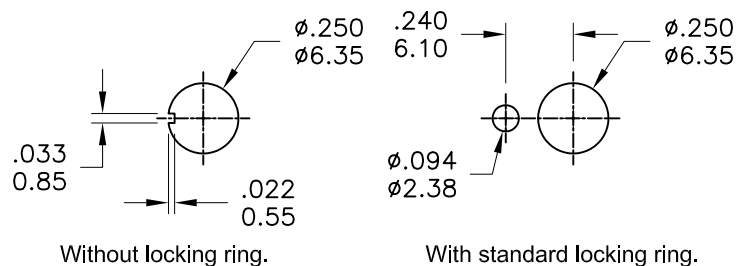

PANEL MOUNTING

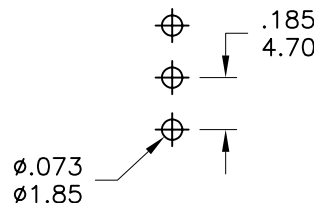

P.C. MOUNTING

**SPECIFICATIONS**

**MECHANICAL LIFE:** 30,000 make-and-break cycles.  
**CONTACT RESISTANCE:** 10mΩ max. initial @ 2-4VDC  
 100mA for both silver and gold plated contacts.  
**INSULATION RESISTANCE:** 1,000MΩ min.  
**DIELECTRIC STRENGTH:** 1,000 V RMS@sea level.  
**OPERATING TEMPERATURE:** -30°C to 85°C.

**MATERIALS**

**CASE BUSHING:** Glass filled nylon 66, flame retardant, heat stabilized(UL94v-0).  
**ACTUATOR:** Brass,chrome plated with internal, O-ring seal standard.  
**SWITCH SUPPORT:** Brass or steel, tin plated.  
**SWITCH SUPPORT RETAINER:** Stainless Steel.  
**CONTACT/TERMINAL:** copper alloy, with Silver or gold plated.

**RATING :**

R : 0.4 Volt-Amps(VA) max. @20V max.(AC or DC)  
 Q : 2Amps @250VAC  
 5Amps @120 VAC or 28 VDC

**德利威電子股份有限公司**  
**DAILYWELL ELECTRONICS CO.,LTD.**

符號	原尺寸	修改後尺寸	變更日期	SCALE (比例) : 3 : 2	TITLE 圖名	Sealed Miniature Toggle Switches		SIZE 圖紙	A4	
1		確認圖面尺寸	JUN-28-2004	TOLERANCE (公差) : 0.00 mm ± 0.25mm 0.0 mm ± 0.40mm ANGULAR : ± 2.54 mm FILE NAME : 1ASP0046	DWG NO. 圖號	1AS1T1B1M2RES		UNIT 單位	inch mm	
2	(A) 5.60	5.30	NOV-08-2004		REV. 版本	D	DATE 日期	SEP - 10 - 2003	SHEET 張數	1 of 1
3	(B)				CHECKED BY 審核	RICHARD		DRAWN BY 製圖	BLUE	
4	(C)									
5	(D)									