

SECTION A-A

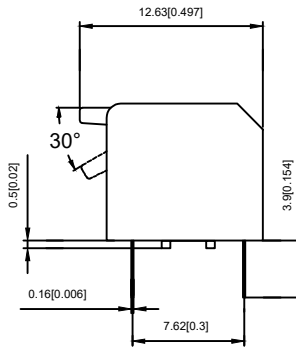

Projection (P)

CIRCUIT

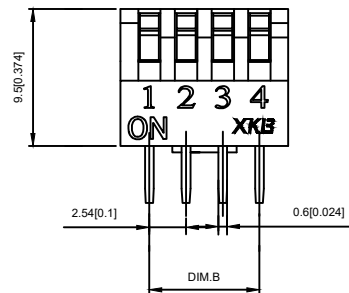
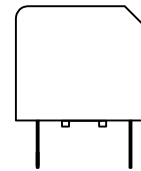
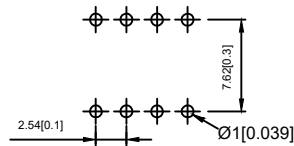
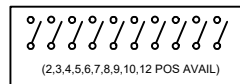

Short (S)

PART NO.	NO.OF POS	DIM.A	DIM.B	Cover/Red(R)		Cover/Blue(BL)	
				Projedion(P)	Short(S)	Projedion(P)	Short(S)
DPL-01	1	3.98		DPL-01RP	DPL-01RS	DPL-01BLP	DPL-01BLS
DPL-02	2	6.52	2.54	DPL-02RP	DA-02RS	DPL-02BLP	DPL-02BLS
DPL-03	3	9.06	5.08	DPL-03RP	DA-03RS	DPL-03BLP	DPL-03BLS
DPL-04	4	11.6	7.62	DPL-04RP	DA-04RS	DPL-04BLP	DPL-04BLS
DPL-05	5	14.14	10.16	DPL-05RP	DA-05RS	DPL-05BLP	DPL-05BLS
DPL-06	6	16.68	12.7	DPL-06RP	DA-06RS	DPL-06BLP	DPL-06BLS
DPL-07	7	19.22	15.24	DPL-07RP	DA-07RS	DPL-07BLP	DPL-07BLS
DPL-08	8	21.76	17.78	DPL-08RP	DA-08RS	DPL-08BLP	DPL-08BLS
DPL-09	9	24.3	20.32	DPL-09RP	DA-09RS	DPL-09BLP	DPL-09BLS
DPL-10	10	26.84	22.86	DPL-10RP	DA-10RS	DPL-10BLP	DPL-10BLS
DPL-12	12	31.92	27.94	DPL-12RP	DA-12RS	DPL-12BLP	DPL-12BLS

SPECIFICATION

Contact Rating: 25mA,24V DC  
 Contact Resistance: 50mΩ max  
 Insulation Resistance: 100mΩ min.500V DC  
 Dielectric Strength: 500V AC/1minute  
 Operating Force: 1000gf max  
 Travel: 2mm  
 Operating Life: 3000cycles  
 Operating Temp: -20℃~+70℃  
 Storage Temp: -30℃~+80℃

ITEM	PAPT NAMF	QTY	MATERIAL	FINISHING
4	Terminal		Copper Alloy	T: Tin plated G: Plating Gold≥15MIU
3	Base	1	Pa66	Black
2	Keystake	1	Pa66	White
1	Cover	1	Pa66	Black Blue Red

DSND	DATE	SCALE: N/A	MODEL TYPE:
DWN	DATE	VIEW:	DIP SWITCH
CHKD	DATE	UNIT: mm/in	PART NO.:
APPD	DATE	SIZE: A4	DWG NO.: DPL-XX-X-X
XKB INDUSTRIAL PRECISION CO., LIMITED			WEIGHT: 1.0g
			SHEET: 1/1
			REVISION: A0

REVISIONS	DATE	REVISED	APPROVED	UNSPECIFIED TOLERANCES
ΔX				units: mm
ΔX				tolerance: X.X ±0.2mm
ΔX				X.XX ±0.1mm
MARK				X.XXX ±0.05mm