

NOTES:  
SPECIFICATION:

1. CURRENT RATING: 5.0A MAX
2. VOLTAGE: 100 VAC
3. TEMPERATURE RANGE: -30 °C ~ 85 °C
4. CONTACT RESISTANCE: 40 MILLIONHM MAX
5. INSULATION RESISTANCE: 100 MEGOHMS MIN.
6. INSERTION FORCE : 5N~20N
7. UNMATING FORCE: 8N~20N
8. DURABILITY: 10,000 CYCLES

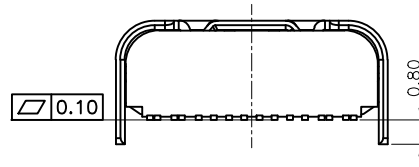
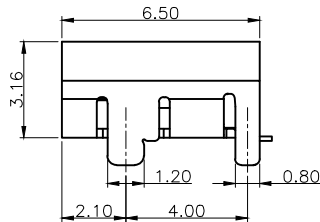
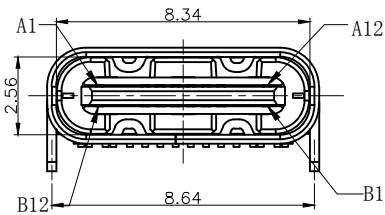

USB TYPE-C PIN ASSIGNMENTS

| PIN | SIGNAL NAME | PIN | SIGNAL NAME |
|-----|-------------|-----|-------------|
| A1  | GND         | B12 | GND         |
| A4  | VBUS        | B9  | VBUS        |
| A5  | CC1         | B8  | SBU2        |
| A6  | DP1         | B7  | DN2         |
| A7  | DN1         | B6  | DP2         |
| A8  | SBU1        | B5  | CC2         |
| A9  | VBUS        | B4  | VBUS        |
| A12 | GND         | B1  | GND         |

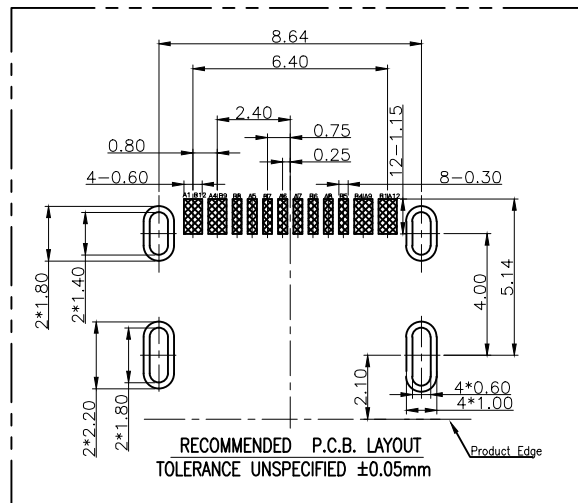
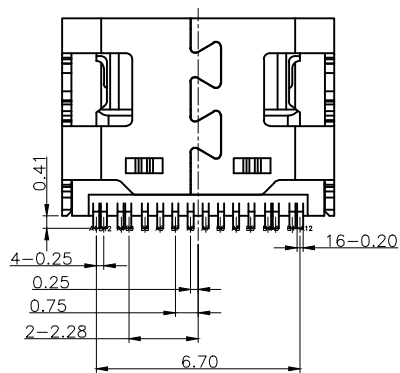

| NO. | DESCRIPTION     | MATERIAL                 | REMARKS      | QTY  |
|-----|-----------------|--------------------------|--------------|------|
| 6   | SHELL           | STAINLESS STEEL          | Ni Plated    | 1PCS |
| 5   | SHIELDING PLATE | STAINLESS STEEL          | ---          | 1PCS |
| 4   | MD              | HIGH TEMPERATURE PLASTIC | BLACK        | 1PCS |
| 3   | CONTACT         | COPPER ALLOY             | Au/Ni Plated | 1SET |
| 2   | CONTACT         | COPPER ALLOY             | Au/Ni Plated | 1SET |
| 1   | HOUSING         | HIGH TEMPERATURE PLASTIC | BLACK        | 1PCS |

|           |                        |                   | GENERAL TOLERANCE | 制图<br>DRAWING    | 深圳市华灿天禄电子有限公司<br>ShenzhenhuacantianluELECTRONICS CO.,LTD |                                     |             |     |
|-----------|------------------------|-------------------|-------------------|------------------|--|-------------------------------------|-------------|-----|
|           |                        |                   | DIM TOL           | 审核<br>CHECK      |  |                                     |             |     |
|           |                        |                   | X.X ±0.30         | 批准<br>APPROVAL   | 产品名称<br>TITLE  | Type C F 16P 单排 SMT 1.6.5mm<br>四脚插板 | 版本<br>REV.  | A   |
| 1         | 初版发行                   |                   | X.XX ±0.20        | 比例<br>SCALE      | 产品料号<br>PART NO.   | HC-TYPE-C-16P-01M                   | 单位<br>UNITS | mm  |
| 序号<br>No. | 变更内容<br>MODIFY CONTENT | 日期<br>MODIFY DATE | X.XXX ±0.10       | 投影<br>Projection | 材料<br>MATERIAL   |                                     | 页次<br>SHEET | 1/2 |
|           |                        |                   | Angle ±3.0°       |                  |  |                                     |             |     |