

## NRSE Series

### SMD Shielded Tiny Power Inductor

#### Size 8065



#### CHARACTERISTICS

- Magnetic resin for higher current and semi-magnetically shielded
- Different sizes from 2mm to 8mm in square shape
- Quantity: 700pcs

#### APPLICATION

- DC/DC converter
- LC filter

#### Dimensions: [mm]

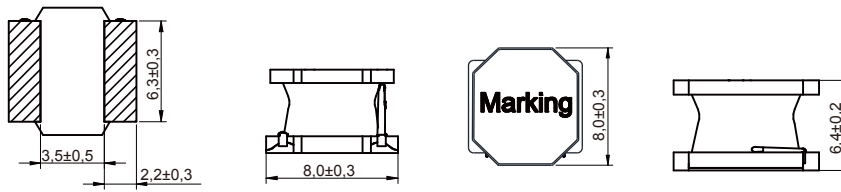

#### Land Pattern: [mm]

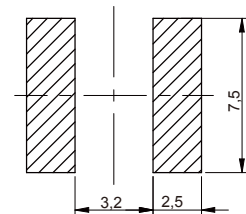

#### Electrical Properties:

Part No	Inductance (μH)	Tolerance	Saturation current (A)	Temperature Rise Current (A)	DC Resistance ±30% (mΩ)
NRSE8065-3R3N	3.3	±30%	9.5	5.1	15
NRSE8065-4R7N	4.7	±30%	8.5	4.7	18
NRSE8065-6R8M	6.8	±20%	7.6	4.3	26
NRSE8065-100M	10	±20%	6.6	4.0	33
NRSE8065-150M	15	±20%	5.2	3.5	45
NRSE8065-220M	22	±20%	4.3	2.85	55
NRSE8065-330M	33	±20%	3.6	2.0	85
NRSE8065-470M	47	±20%	2.85	1.8	135
NRSE8065-680M	68	±20%	2.5	1.5	181
NRSE8065-101M	100	±20%	2.0	1.3	250
NRSE8065-151M	150	±20%	1.6	1.0	360
NRSE8065-221M	220	±20%	1.3	0.9	530
NRSE8065-331M	330	±20%	1.2	0.7	850
NRSE8065-471M	470	±20%	1.0	0.55	1300
NRSE8065-102M	1000	±20%	0.65	0.4	2350
NRSE8065-152M	1500	±20%	0.54	0.32	3650
NRSE8065-202M	2000	±20%	0.45	0.27	4900
NRSE8065-222M	2200	±20%	0.45	0.27	5100

Part No	Inductance ( $\mu$ H)	Tolerance	Saturation current (A)	Temperature Rise Current (A)	DC Resistance $\pm$ 30% (m $\Omega$ )
NRSE8065-302M	3000	$\pm$ 20%	0.38	0.25	7000
NRSE8065-332M	3300	$\pm$ 20%	0.36	0.23	7300
NRSE8065-452M	4500	$\pm$ 20%	0.3	0.18	12300
NRSE8065-472M	4700	$\pm$ 20%	0.29	0.18	12500
NRSE8065-562M	5600	$\pm$ 20%	0.26	0.15	16000
NRSE8065-682M	6800	$\pm$ 20%	0.26	0.14	18700
NRSE8065-822M	8200	$\pm$ 20%	0.22	0.13	19000
NRSE8065-103M	10000	$\pm$ 20%	0.2	0.12	22000

Operating temperature : -40 °C ~ +125 °C

Temperature rise current: the actual value of DC current when the temperature rise is  $\Delta T 40^{\circ}C$

Saturation Current that will cause initial inductance to drop approximately 30%