

SPECIFICATION FOR APPROVAL

CUSTOMER		CUST P/N.	
ITEM	SMD Power Inductors	Description	CDH105N-220M
PART NO.	306-97058	DATE	2018.10.12

(1) DIMENSION(UNIT:mm)

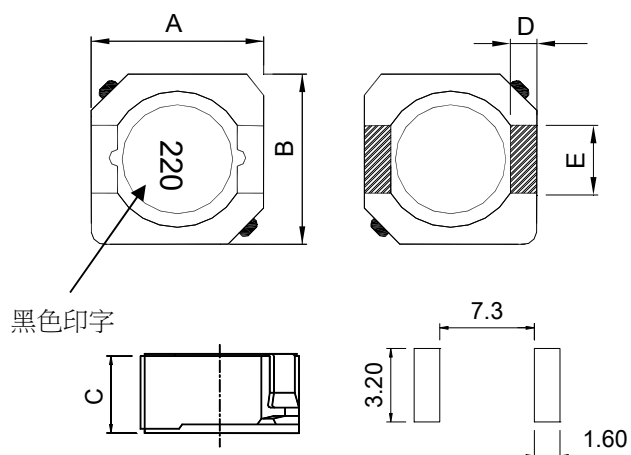

A	10.5 ± 0.5	mm
B	10.0 ± 0.5	mm
C	5.0 (Max)	mm
D	1.2 ± 0.15	mm
E	3.0 ± 0.2	mm
F		mm
G		mm
H		mm

(2) ELECTRICAL REQUIREMENTS

TEST CONDITION		FREQUENCY		(3) TEST INSTRUMENTS	
		VOLTAGE		LCR-METER:	
L	22.0μH±20%	100KHz	0.25V	V	HP-4291A WK3260B
DCR	0.050Ω (Max)	KHz	V	V	DC RESISTANCE METER: WK3260B
Isat	3.25A(Max)drop 35% typ	100KHz	0.25V	V	CURRENT SOURCE: WK3260B
Irms	2.44A(Max) at ΔT=40°C (TYP)	100KHz	0.25V	V	RFIMPEDANCE/MATERIAL ANALYZER TH2816B+1320

(4) TURN: 15Ts(REF)

(5) MATERIAL LIST

ITEM	MATERIAL	DESCRIPTION
1	CORE	DR 9.7×3.65 ^{D3}
2	COAT	RIS 10×3.2×8.2
3	WIRE	0.3mm*2P (2UEW-H)
4	INK	BLACK
5	BASE	C-TSB104R

REMARK:

APPROVED	CHECKED	DRAWN BY
姜杰文	姜法寶	王艷