

SS-12F45-GXXX

直柄

G-Switch P/N

Switch Height (mm)

G020=2.0 G030=3.0
 G040=4.0 G050=5.0
 G055=5.5 G060=6.0
 G065=6.5 G070=7.0
 G075=7.5 G080=8.0
 G085=8.5 G090=9.0
 G095=9.5 G100=10.0

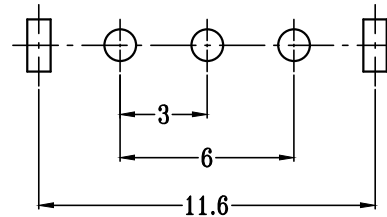
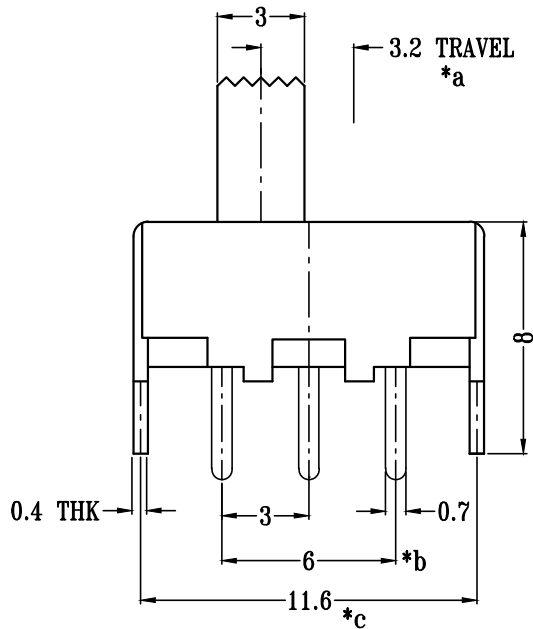

P.C.B LAYOUT
BOTTOM VIEW

G-Switch Specification:

Electrical Specifications: 1.0A/DC24V
 Contact resistance (CR): $\leq 50\text{m}\Omega$
 Insulation Resistance(IR): $\geq 100\text{M}\Omega$ DC250V
 Compressive strength (WV): AC250V 1minute
 Operating temperature: $-25^{\circ}\text{C}\sim+70^{\circ}\text{C}$
 Storage humidity: $<85\%\text{RH}$
 Electrical life: 10,000Cycles.

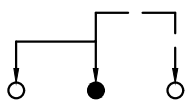

SCHEMATIC (NON-SHORTING)



G-Switch Electronic (HongKong) CO.,Ltd.

Unless otherwise specified, Tolerance:
 X. ± 0.30
 X.x ± 0.20
 X.xx ± 0.15
 X.xxx ± 0.10
 Angles $\pm 3^{\circ}$

DESIGN FengFengChen DATE 2019.05.29
 CHECKED DATE
 APPROVED DATE
<http://www.dg-switch.com>
 TEL:0769-82388879

Molde code:
SS-12F45-GXXX
 REV.: X1 SCALE: 4:1 UNIT: mm
 SIZE: A4 SHEET: 1/1