

环保物料

TEL:0769-82001899

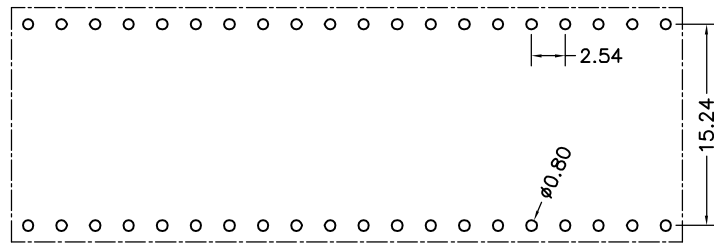
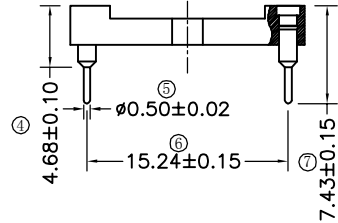
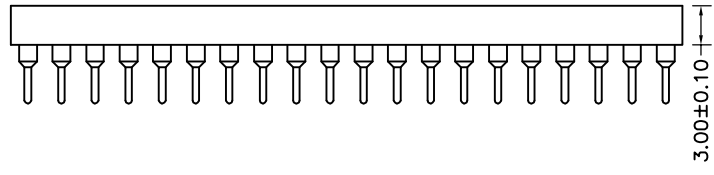
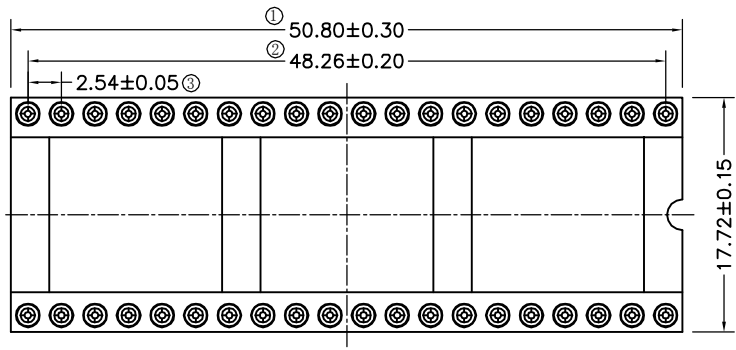

P. C. B LAYOUT

Technical Data

Material:

Pin(outer sleeve):Brass,machined CuZn38Pb2

Plating(outer sleeve):

Tin Plated:2μm/80μ"NI, 5μm/200μ"Sn

Gold Plated:2μm"/80μ"Ni, 0.8μ" gold

Plating(Contact):2μm/80μ"NI, gold or Tin plated

Insuiator:PPS UL94V-0

ClIp(Contact 4 Flnger):Beryllium copper, heat teated

Electrical:

Current rating:3Amps/contact max.

Contact resistance:≤4mΩ/contact

Insuiation resistance:≥1000MΩ at V=100V

Operaing voitage:60VAC/DC

Mechanical:

Average Insertion force with steel pin of 0.432:<250g

Average withdrawal force with steel pin of 0.432:>70g

Mechanical lige cycle:min 200

Operaling temperature:-40 ° C to+105 ° C

Soldering temperature:+255 ° C

Critical Dimensions:⊗

TOLERANCE UNLESS OTHERWISE

X.	±0.30	X°	±5°
.X	±0.20	.X°	±2°
.XX	±0.08	.XX°	±1°
.XXX	±0.03	.XXX°	±0.5°

DRAWN

CK tan

CHKD

APPD

VIEW

⊕

◀

XFCN 兴飞连接器有限公司
XFCN CONNECTORS CO.,LTD.

PRODUCT NAME 2.54mm IC Socket Connectors

PART. NO. IC254V-12-40-0743-P1524

SHEET

1/1

DATE

2020.04.12

UNITS

mm

SCALE

1:1

DWG NO.

009

AO

VER

MODIFICATION

DRAW

DATE