

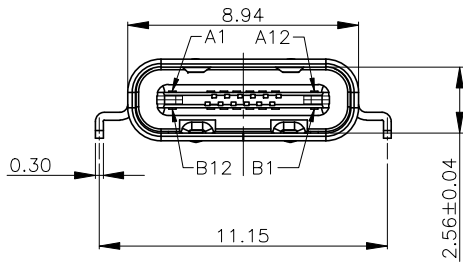

REV.	ECN NO OR DESCRIPTION	REVISED	DATE

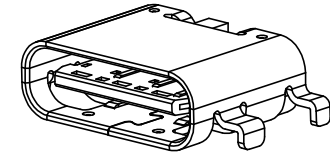
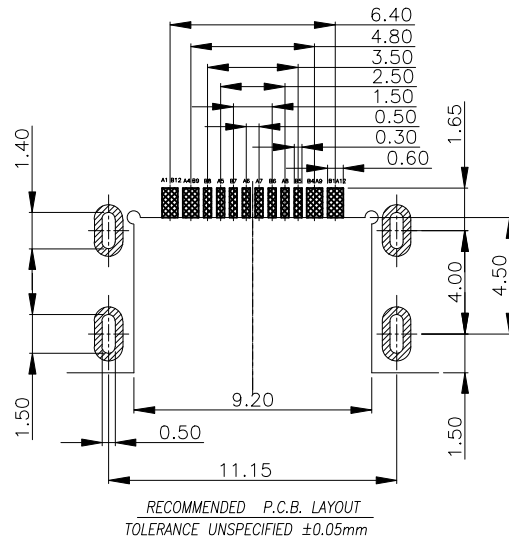
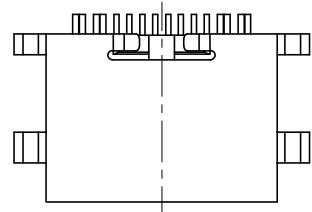

A1	GND	B12	GND
A4	VBUS	B9	VBUS
A5	CCI	B8	SRU2
A6	DP1	B7	DN2
A7	DN1	B6	DP2
A8	SRU1	B5	CC2
A9	VBUS	B4	VBUS
A12	GND	B1	GND
PIN	SIGNAL NAME	PIN	SIGNAL NAME

SPECIFICATION

- 1. ELECTRICAL CHARACTERISTICS:**
 1-1. VOLTAGE & CURRENT RATING: DC 30V MAX & 3A
 1-2. CONTACT RESISTANCE: 40mΩ MAX INITIAL.
 1-3. INSULATION RESISTANCE: 1000MΩ MIN FOR VOLTAGE 100VDC.
 1-4. DIELECTRIC WITHSTAND: 100V AC FOR 1 MINUTE
 1-5. OPERATING TEMPERATURE: -25°C ~ +85°C
- 2. MECHANICAL CHARACTERISTICS:**
 2-1. INSERT FORCE: 5-20N Max
 2-2. WITHDRAW FORCE: 5-20N Min
 2-3. LIFE TEST : 3,000 CYCLES

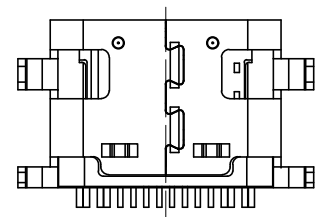
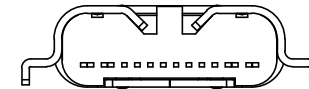
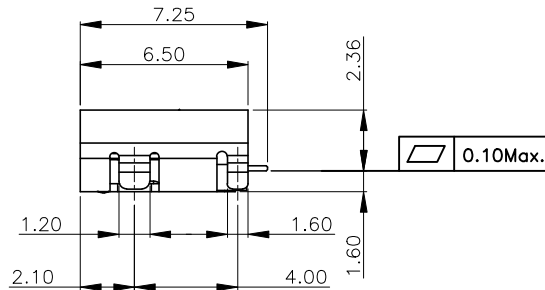

UNLESS OTHERWISE SPECIFIED TOLERANCES



东莞市汉博电子科技有限公司
DONGGUAN HANBO TECHNOLOGY CO., LTD

DECIMALS: ANGLES:
 X.X ±0.30 X° ±5°
 X.XX ±0.15 X.X° ±2°
 X.XXX ±0.10

TITLE	TYPE C 16PIN 沉板1.6mm		
DWN	xiong	PART NO. MC-309-B16	
CHKD	lee	SCALE: 1:1	UNIT: mm
APVD	wang	SIZE: A4	SHEET: 1 OF 1
			REV: A4

CUSTOMER COPY