

REV	MARK	DESCRIPTION	DRAFTED. BY	DATE

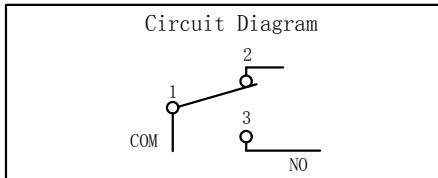
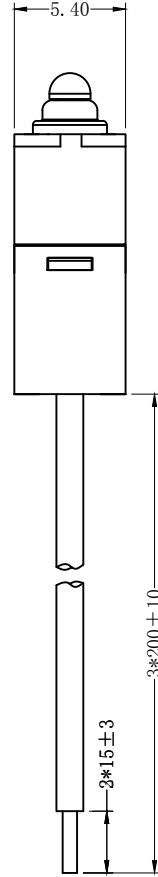
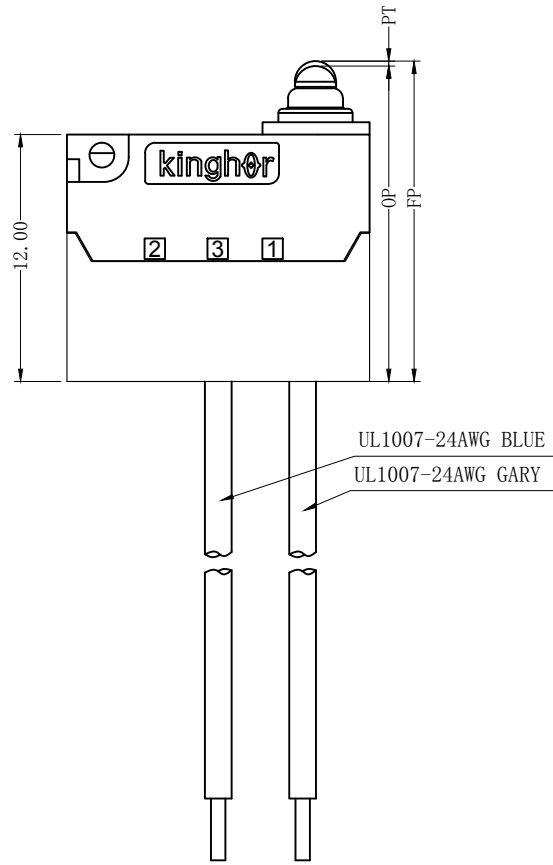
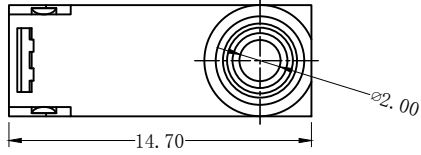

CHARACTERISTICS	
OPERATING FORCE (OF):	130gf Max.
RELEASE FORCE (RF):	13gf Min.
OPERATING POSITION:	3.0 ± 0.2 mm.
PRE TRAVEL:	0.8mm Max.
DIFFERENTIAL TRAVEL:	0.2mm Max.
FREE POSITION:	3.6mm Max.

ELECTRICAL DATA	
RATING	OPERATING LIFE
3A 12VDC	100,000 CYCLES
0.1A 48VDC 125/250VAC	100,000 CYCLES

MECHANICAL LIFE	500,000 CYCLES
GAP TYPE	MICRO
OPERATING TEMP	-20°C ~ +85°C
WATERGROOF	IP67

OUTLINE DRAWING		TOLERANCE UNLESS OTHERWISE SPECIFIED								
TITLE	H3 SERIES MICRO SWITCH	≤3	1~3	3~10	10~30	30~100	100~200	ANGLE		
MODEL	H3-E1	±0.2	±0.3	±0.4	±0.6	±1.0	±1.5	±3.0°		
PART NO.	H3-E1-1B00W1-2-200									
DRAFTED BY	Bing Wang								DATE	2020-6-13
CHECKED BY	Hua Bai								DATE	2020-6-13
APPROVED BY	Hong Chen	DATE	2020-6-13	KINGHOR SWITCHES AND CONTROL EXPERT						

SCALE	UNIT
	mm
VERSION REV	A1