

LOW JITTER PIN CONFIGURABLE LVDS-CMOS DUAL OUTPUT ULTRA MINIATURE PURE SILICON™ CLOCK OSCILLATOR

ASEMDLC

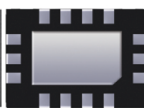

Life Size
3.2 x 2.5 x 0.85 mm

ASEMDLC



RoHS/RoHS II compliant

Moisture Sensitivity Level – MSL 1

FEATURES:

- Ultra Miniature Pure Silicon™ Clock Oscillator
- Pin Configurable LVDS-CMOS Dual output
- Low Jitter (Period Jitter RMS 2.5ps typical)
- Low Integrated Phase Jitter 2ps max
- Excellent Shock & Vibration Immunity

APPLICATIONS:

- Consumer Electronics
- Storage Area Networks
- SATA, SAS, Fibre Channel
- Passive Optical Networks
- EPON, 10G-EPON, GPON, 10G-PON
- Ethernet
- 1G, 10GBASE-T/KR/LR/SR, and FCoE
- PCI Express

Low Jitter
Pin Configurable
LVDS-CMOS Dual Output
3G MEMS

STANDARD SPECIFICATIONS:

Pre-programmed Output Frequency Configuration

Ordering Info	Freq (MHz)	Freq Select Bits [FS2, FS1, FS0] – Default is [111]							
		000	001	010	011	100	101	110	111
Frequency Configuration 1	f _{OUT1} (LVDS)	148.5	74.25	156.25	150	125	125	100	100
	f _{OUT2} (CMOS)	74.25	74.25	125	125	25	50	50	75
Custom Configuration	f _{OUT1}	Contact Abracon for customized configurations							
	f _{OUT2}								

Frequency select bits [FS2, FS1, FS0] are weakly tied high so if left floated, the default setting will be [111] and the device will output the associated frequency highlighted in Bold. If other frequency combinations are required, please contact Abracon for customized configuration. Please see the configurable frequency range in the section 2.0

Key Electrical Specifications

Parameters	Minimum	Typical	Maximum	Units	Notes	
Configurable frequency range	LVDS	2.3		460	MHz	Commercial, Industrial temp range
	CMOS	2.3		170		
Operating Temperature	-20		+70	°C	See options	
Storage Temperature	-55		+150	°C		
Overall Frequency Stability* ¹	-50		+50	ppm	See options	
Supply Voltage (V _{dd})	+2.25		+3.6	V		
Startup Time			5	ms		
Enable Time			20	ns		
Disable Time			5	ns		
Disable Current		21	23	mA		
Tri-state Function (Standby/Disable)	"1" (VIH ≥ 0.75*V _{dd}) or Open: Oscillation "0" (VIL < 0.25*V _{dd}) : Hi Z			V	40kΩ pull-up resistor embedded	
Aging	-5.0		+5.0	ppm	First year	
Supply Current (I _{dd})		49		mA	LVDS output: RL=100Ω, F01=125MHz CMOS output: CL=15pF, F02=75MHz	

*1. Frequency stability includes frequency variations due to initial tolerance, temp. and power supply voltage

ABRACON IS
ISO9001:2008
CERTIFIED



ABRACON
CORPORATION

Visit www.abracon.com for Terms & Conditions of Sale **Revised: 11.05.14**
30332 Esperanza, Rancho Santa Margarita, California 92688
tel 949-546-8000 | fax 949-546-8001 | www.abracon.com

LOW JITTER PIN CONFIGURABLE LVDS-CMOS DUAL OUTPUT ULTRA MINIATURE PURE SILICON™ CLOCK OSCILLATOR

ASEMDLC

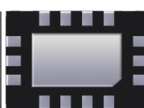

Life Size
3.2 x 2.5 x 0.85 mm

ASEMDLC

Pb RoHS/RoHS II compliant

Key Electrical Specifications (continued)

LVDS Output (Fout1)		Minimum	Typical	Maximum	Units	Notes
Output Offset Voltage		1.125		1.40	V	RL=100 Ω, Differential
Delta Offset Voltage				50	mV	
Peak to Peak Output Swing			350		mV	Single-Ended
Rise Time	Tr		200	350	ps	RL=50 Ω, CL=2pF
Fall Time	Tf		200	350	ps	20% to 80%
Duty Cycle		48		52	%	Differential
Period Jitter RMS (J _{PER})			2.5		ps	F01= 125MHz
Integrated Phase Jitter (J _{PH})			0.28	2	ps	200kHz ~ 20MHz, @156.25MHz
			0.40	2		100kHz ~ 20MHz, @156.25MHz
			1.70	2		12kHz ~ 20MHz, @156.25MHz

CMOS Output (Fout2)		Minimum	Typical	Maximum	Units	Notes
Output Logic Level	V _{OH}	0.9*V _{dd}			V	I=±6mA
	V _{OL}			0.1*V _{dd}		
Rise Time	Tr		1.1	2.0	ns	CL=15pF
Fall Time	Tf		1.3	2.0	ns	20% to 80%
Duty Cycle		45		55	%	
Period Jitter RMS (J _{PER})			3.0		ps	F01= 125MHz
Integrated Phase Jitter (J _{PH})			0.30	2	ps	200kHz ~ 20MHz, @125MHz
			0.38	2		100kHz ~ 20MHz, @125MHz
			1.70	2		12kHz ~ 20MHz, @125MHz

PHASE JITTER

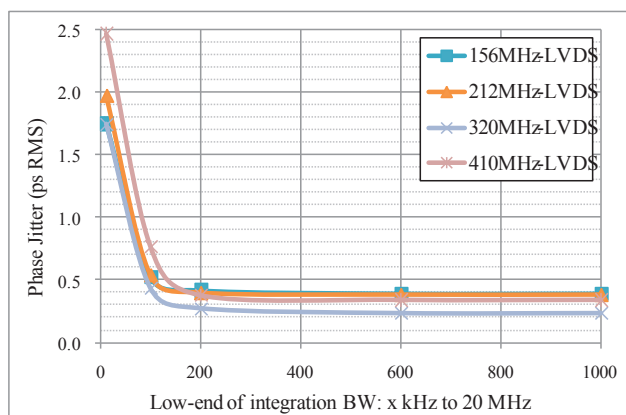

LVDS

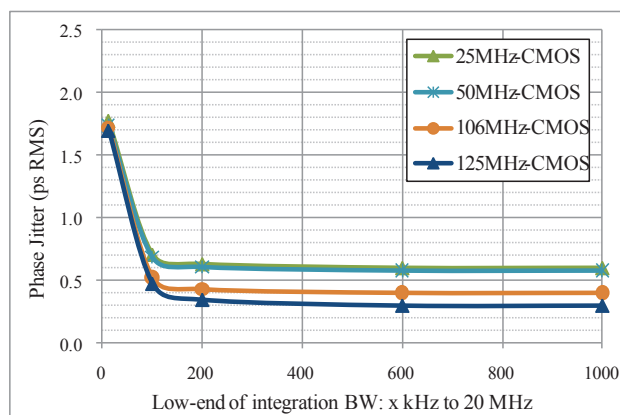

CMOS

ABRACON IS
ISO9001:2008
CERTIFIED



Visit www.abracon.com for Terms & Conditions of Sale **Revised: 11.05.14**
30332 Esperanza, Rancho Santa Margarita, California 92688
tel 949-546-8000 | fax 949-546-8001 | www.abracon.com

LOW JITTER PIN CONFIGURABLE LVDS-CMOS DUAL OUTPUT ULTRA MINIATURE PURE SILICON™ CLOCK OSCILLATOR

ASEMDLC

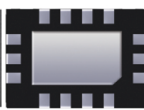

Life Size 3.2 x 2.5 x 0.85 mm

ASEMDLC



RoHS/RoHS II compliant

ABSOLUTE MAXIMUM RATINGS

Item	Minimum	Maximum	Unit	Condition
Supply Voltage	-0.3	+4.0	V	
Input Voltage	-0.3	V _{dd} +0.3	V	
Junction Temp.		+150	°C	
Storage Temp.	-55	+150	°C	
Soldering Temp.		+260	°C	40sec max
ESD			V	
HBM		4,000		
MM		400		
CDM		1,500		

OPTIONS AND PART IDENTIFICATION:

ASEMDLC - - -

Operating Temp.
Blank: -20°C ~ +70°C
L: -40°C ~ +85°C

Overall Freq. Stability
Blank: ±50ppm
R: ±25 ppm

Packaging
Blank*: Tube (110pcs / Tube)
T: Tape & Reel (1kpcs / reel)
T3: Tape & Reel (3kpcs / reel)
T5: Tape & Reel (5kpcs / reel)

* Due to the immediate availability of stock and the qty of the order, the parts may be delivered as BULK: Cut Tape, Loose parts in Antistatic Bag or in Tube(s). The MOQ per the series will still apply for Tube packaging.

Frequency Combination	Freq (MHz)	Freq Select Bits [FS2, FS1, FS0] – Default is [111]							
		000	001	010	011	100	101	110	111
Standard Configuration	f _{OUT1} (LVDS)	148.5	74.25	156.25	150	125	125	100	100
	f _{OUT2} (CMOS)	74.25	74.25	125	125	25	50	50	75
Custom Configuration	f _{OUT1}	Contact Abracon for customized configurations							
	f _{OUT2}								

Default condition: Frequency select bits [FS2, FS1, FS0] are all left floated. FS2, FS1, FS0 are pulled high [111]
Frequency combination and default frequency is customized upon request. Please contact Abracon for the frequency combinations.

CONFIGURABLE CMOS OUTPUT STRENGTH (TR/TF)

CMOS Output (Tr/Tf) are configurable by the control pins OS2, OS1 and OS0. The combinations are described in the table below.

	Output Drive Strength Bits [OS2, OS1, OS0] - Default [111]							
	000	001	010	011	100	101	110	111
Tr (ns)	2.1	1.7	1.6	1.4	1.3	1.3	1.2	1.1
Tf (ns)	2.5	2.4	2.4	2	1.8	1.6	1.3	1.3

ABRACON IS
ISO9001:2008
CERTIFIED



Visit www.abracon.com for Terms & Conditions of Sale **Revised: 11.05.14**
30332 Esperanza, Rancho Santa Margarita, California 92688
tel 949-546-8000 | fax 949-546-8001 | www.abracon.com

LOW JITTER PIN CONFIGURABLE LVDS-CMOS DUAL OUTPUT ULTRA MINIATURE PURE SILICON™ CLOCK OSCILLATOR

ASEMDLC

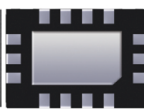

Life Size
3.2 x 2.5 x 0.85 mm

ASEMDLC

RoHS/RoHS II compliant

MECHANICAL DIMENSIONS

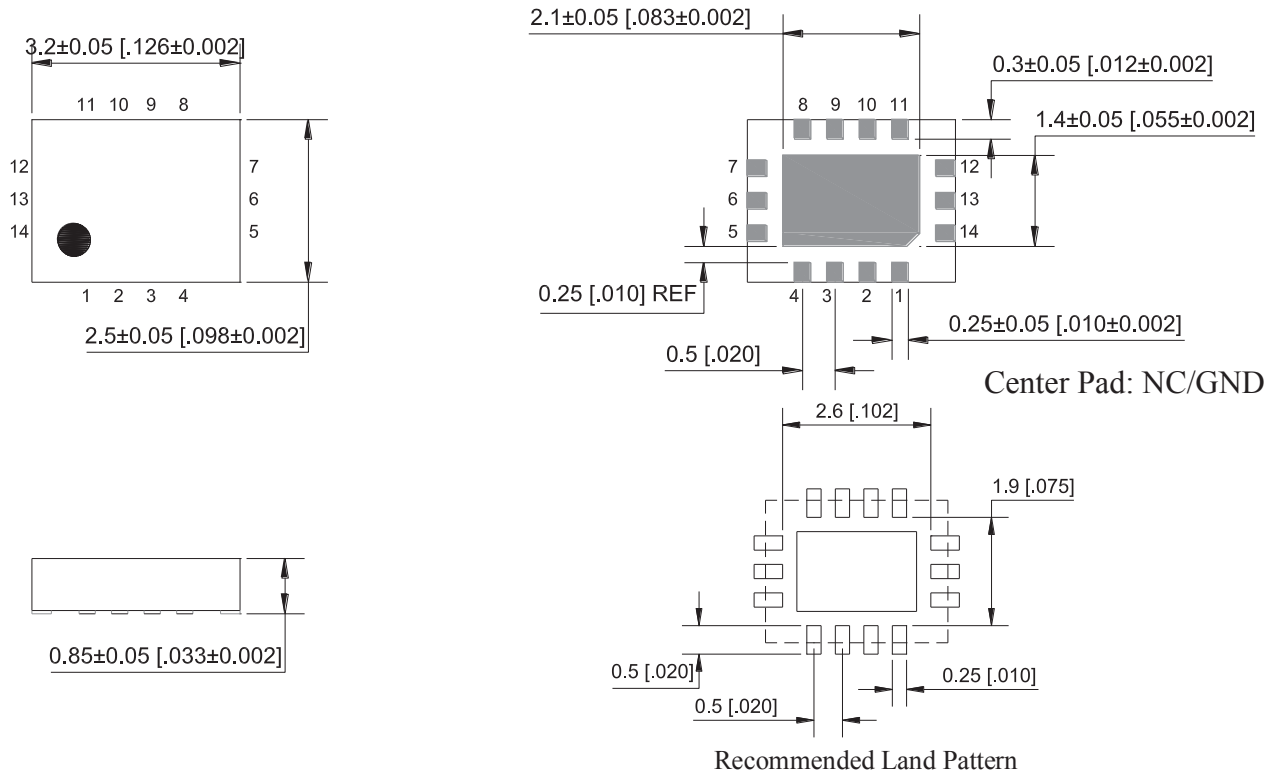

Pin No.	Pin Name	Pin Type	Description
1	Enable	I	Enables outputs when high and disables (tri-state) them when low
2	NC	NA	Leave unconnected or grounded
3	OS0	I	Least significant bit for output drive strength selection for CMOS
4	GND	Power	Ground
5	FS0	I	Least significant bit for frequency selection
6	FS1	I	Middle bit for frequency selection
7	FS2	I	Most significant bit for frequency selection
8	Output1+	O	Positive LVDS Output 1
9	Output1-	O	Negative LVDS Output 1
10	OS1	I	Middle bit for output drive strength selection for CMOS
11	Output 2	O	CMOS output
12	VDD2	Power	Power Supply 2 for CMOS Output
13	VDD	Power	Power Supply
14	OS2	I	Most significant bit for output drive strength selection for CMOS

Dimensions: mm (inches)

ABRACON IS
ISO9001:2008
CERTIFIED



Visit www.abracon.com for Terms & Conditions of Sale **Revised: 11.05.14**
 30332 Esperanza, Rancho Santa Margarita, California 92688
 tel 949-546-8000 | fax 949-546-8001 | www.abracon.com

LOW JITTER PIN CONFIGURABLE LVDS-CMOS DUAL OUTPUT ULTRA MINIATURE PURE SILICON™ CLOCK OSCILLATOR

ASEMDLC

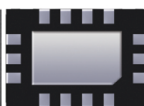

Life Size
3.2 x 2.5 x 0.85 mm

ASEMDLC



RoHS/RoHS II compliant

REFLOW PROFILE

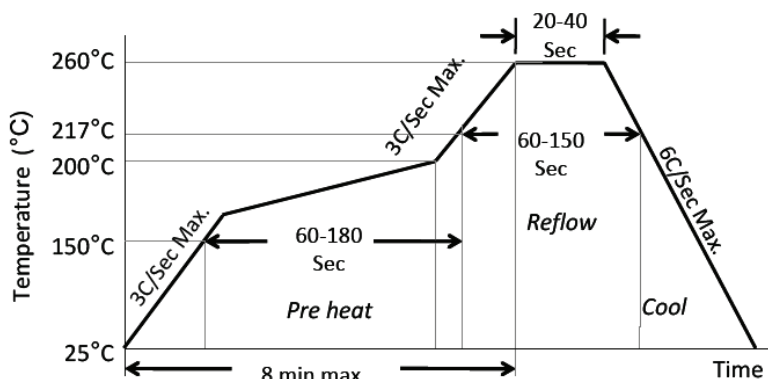

Ramp-Up Rate (200°C to Peak Temp)	3°C/Sec Max.
Preheat Time 150°C to 200°C	60-180 Sec
Time maintained above 217°C	60-150 Sec
Peak Temperature	255-260°C
Time within 5°C of actual Peak	20-40 Sec
Ramp-Down Rate	6°C/Sec Max.
Time 25°C to Peak Temperature	8 min Max.

REFLOW PROFILE

T= 1,000pcs/reel (D=180mm)
T3= 3,000pcs/reel (D=180mm)
T5= 5,000pcs/reel (D=330mm)

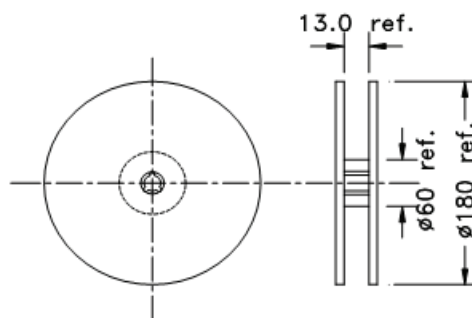
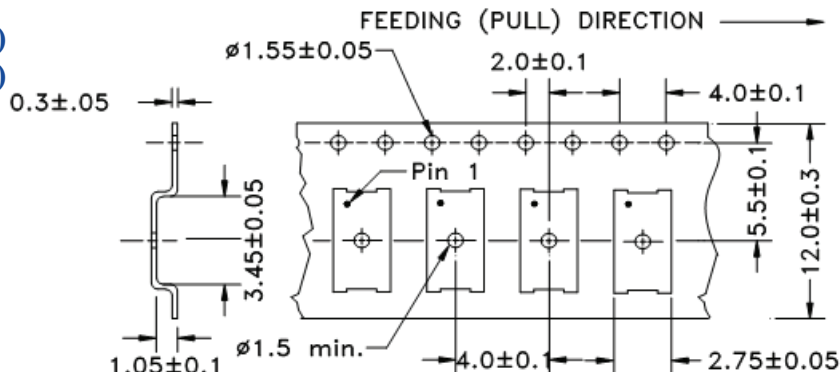

Unit orientation in tube:



Tube: 110 pcs/tube

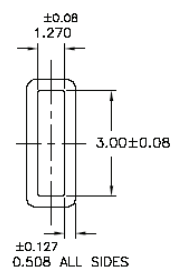
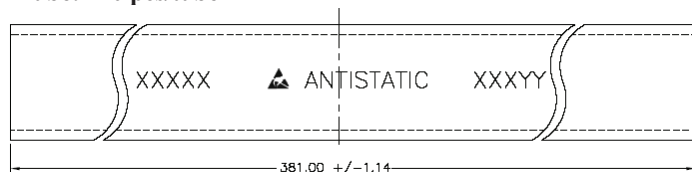

Dimensions: mm

ATTENTION: Abracon Corporation's products are COTS – Commercial-Off-The-Shelf products; suitable for Commercial, Industrial and, where designated, Automotive Applications. Abracon's products are not specifically designed for Military, Aviation, Aerospace, Life-dependant Medical applications or any application requiring high reliability where component failure could result in loss of life and/or property. For applications requiring high reliability and/or presenting an extreme operating environment, written consent and authorization from Abracon Corporation is required. Please contact Abracon Corporation for more information.

ABRACON IS
ISO9001:2008
CERTIFIED

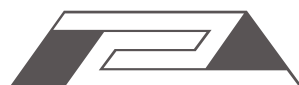

**ABRACON
CORPORATION**

Visit www.abracon.com for Terms & Conditions of Sale **Revised: 11.05.14**
30332 Esperanza, Rancho Santa Margarita, California 92688
tel 949-546-8000 | fax 949-546-8001 | www.abracon.com