

MAPX	MODIFICATION	DATE

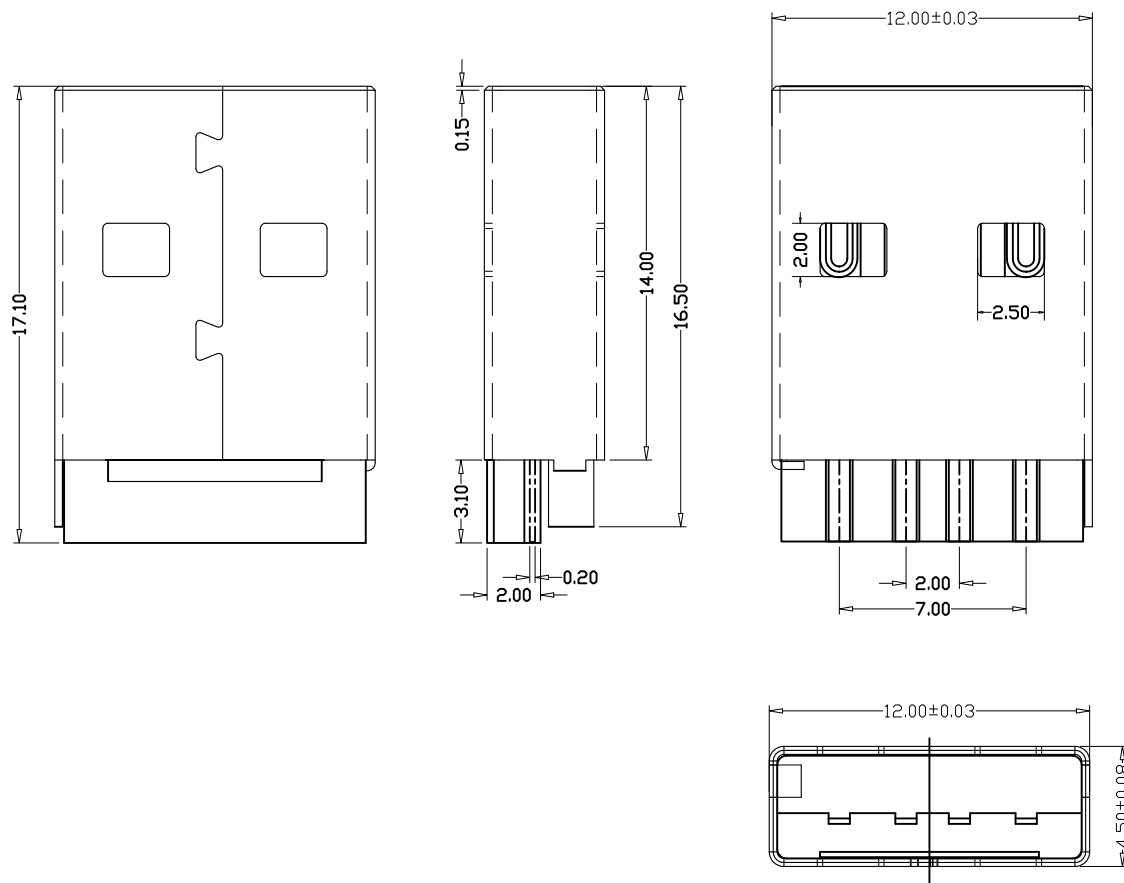

NOTES:  
Housing: Thermoplastics  
Contact: Copper Alloy  
Shell: Copper Alloy/Steel  
Voltage Current Rating:1.5 AMP. 30V AC  
Insulation Resistance:1000MΩ Min.  
Contact Resistance:30 MΩ Max.  
Dielectric Withstanding Voltage:500W AC  
Temperature Range:-55° C to +85° C  
Insulator color: Black/White  
Plastic material:PBT/LCP  
Shell finish:Nickel plated/Tin-Lead plated  
Contact finish:  
01:Selective Gold Flash  
02:Selective Gold 3U''  
03:Selective Gold 5U''  
04:Selective Gold 15U''  
05:Selective Gold 30U''

产品图 PRODUCT CHART DWG				深圳市精拓金电子有限公司						
公差一览表 TOLERANCE UNLESS OTHERWISE				单位 UNITS	MM	制图 DRAWING	Z-Y-B	制图料号 PRODUCT PART NO.	917-421A101YA10200	
X.	±0.15	X.	±5°	比例 SCALE	1:1	审核 CHKD		产品名称 PRODUCT NO.	AM5代S款白胶1U亮面焊线压一边短脚	
.X	±0.10	.X	±2°	日期 DATE	2013.1.15	核准 APPD		角法 VIEW	版本 VER	AO
.XX	±0.05	.XX	±1°							
.XXX	±0.03	.XXX	±0.5°							