

RoHS

MAPX

MODIFICATION

DRW

DATE

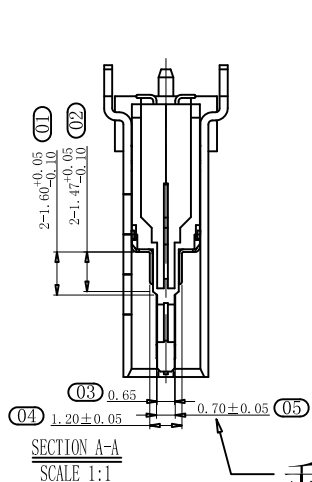

舌片厚度

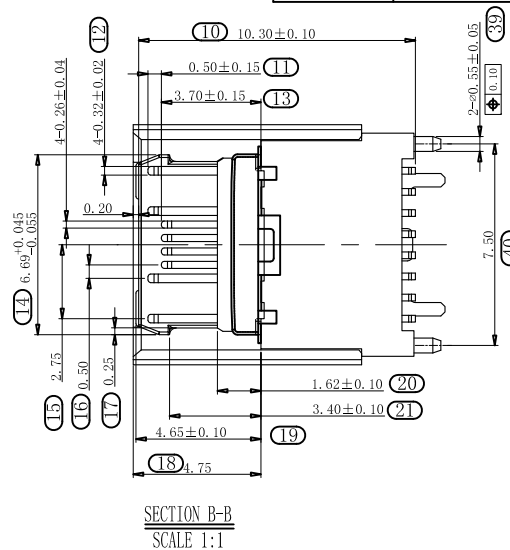
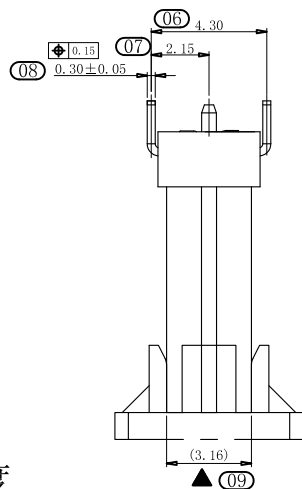

备注:

- 1, 材质: 外壳: SUS304 1/2H T=0.30±0.01mm;
护套: SUS316L 140~160 T=0.10±0.01mm;
端子: C7025 T=0.12±0.01mm;
胶芯: 热塑性塑胶LCP, 黑色;
中夹片: SUS304 H T=0.15±0.01mm;
- 2, 电镀: 外壳: 全表面镀镍100u" Min.
端子: 镍底80~100u", 镀雾锡100~120u" Min.
- 3, 外观不允许有压伤, 脏污, 模痕, 错位等现象;
- 4, 盐雾测试需过24H以上;
- 5, 连接逢错位0.03mmMax, 不能有变形;
- 6, 有"CPK"标志的需做制程稳定控制;
- 7, 有" "标志的尺寸为QIP检验尺寸;
- 8, 有" "标志的尺寸为FAI检验尺寸;
- 9, 产品符合USB 协会标准;

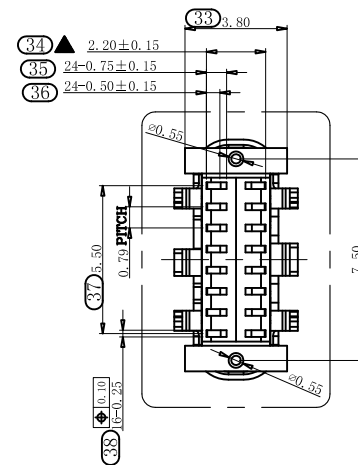
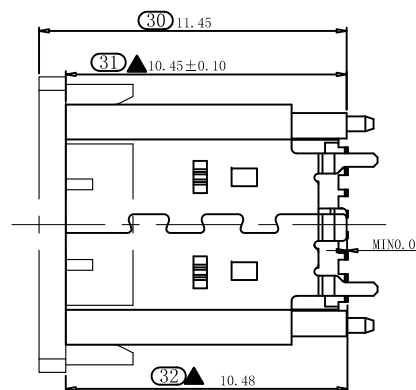
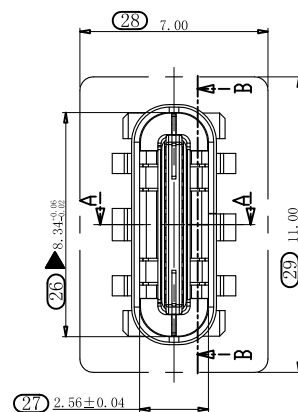
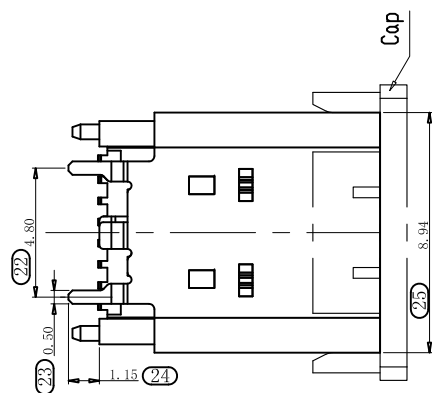

产品图

PRODUCT CHART DWG

公差一览表

TOLERANCE UNLESS OTHERWISE			
X.	±0.35	X.	±5.°
.X	±0.25	.X	±2.°
.XX	±0.20	.XX	±1.°
.XXX	±0.10	.XXX	±0.5°

深圳市精拓金电子有限公司
Shenzhen Jing Tuo Jin Electronics Co., Ltd.

单位 UNITS	MM	制图 DRAWING	尹先华	制图料号 PRODUCT PART NO.	918-418K2022Y40009
比例 SCALE	1:1	审核 CHKD	郭治富	产品名称 PRODUCT NAME	TYPE-C3.1母座直立式四脚有柱双排贴片 10.5 LCP黑胶 16PIN
日期 DATE	2021-04-15	核准 APPD	黄国荣	角法 VIEW	版本 VER
					A0

RoHS

MAPX

MODIFICATION

DRW

DATE

USB TYPE-C FULL-FEATURED RECEPTACLE INTERFACE PIN ASSIGNMENTS

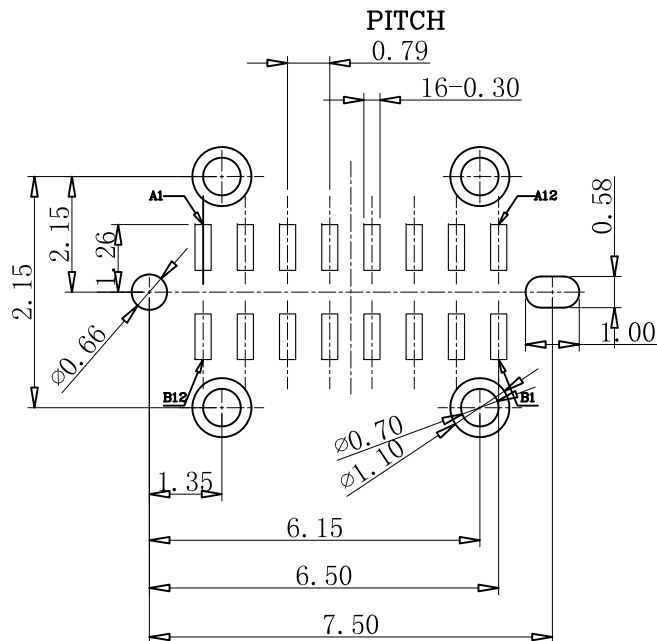

PIN	Signal Name	Description	PIN	Signal Name	Description
A1	GND	Ground return	B12	GND	Ground return
A4	VBUS	Bus Power	B9	VBUS	Bus Power
A5	CC1	Configuration Channel	B8	SBU2	Sideband Use (SBU)
A6	Dp1	Positive half of the USB 2.0 differential pair-Position 1	B7	Dn2	Negative half of the USB 2.0 differential pair-Position 2
A7	Dn1	Negative half of the USB 2.0 differential pair-Position 1	B6	Dp2	Positive half of the USB 2.0 differential pair-Position 2
A8	SBU1	Sideband Use (SBU)	B5	CC2	Configuraation Channel
A9	VBUS	Bus Power	B4	VBUS	Bus Power
A12	GND	Ground return	B1	GND	Ground return

RECOMMENDED P. C. B. LAYOUT (T:1.00mm)

TOLERANCE UNSPECIFIED $\pm 0.05\text{mm}$

SCALE: 1:1

产品图

PRODUCT CHART DWG

公差一览表

TOLERANCE UNLESS OTHERWISE

X.	± 0.35	X.	$\pm 5^\circ$
.X	± 0.25	.X	$\pm 2^\circ$
.XX	± 0.20	.XX	$\pm 1^\circ$
.XXX	± 0.10	.XXX	$\pm 0.5^\circ$

深圳市精拓金电子有限公司
Shenzhen Jing Tuo Jin Electronics Co., Ltd.

单位 UNITS	MM	制图 DRAWING	尹先华	制图料号 PRODUCT PART NO.	918-418K2022Y40009
比例 SCALE	1:1	审核 CHKD	郭治富	产品名称 PRODUCT NO.	TYPE-C3.1母座直立式四脚有柱双排贴片 10.5 LCP黑胶 16PIN
日期 DATE	2021-04-15	核准 APPD	黄国荣	角法 VIEW	版本 VER
					A0

RoHS

MAPX

MODIFICATION

DRW

DATE

NOTES

1. 帶子引導長度
LEAD TAPE LENGTH
出料方向
PULL OUT DIRECTEON

2. 出貨運輸過程中一定注意：
THIS REQUIREMENT SHOULD BE APPLIED AT SHIPMENT：
卷帶在運輸過程中不能散開
PEELING OFF SHOULD NOT BE ALLOWED DURING TRANSPORTATION

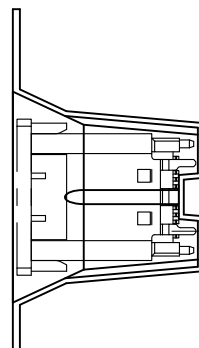
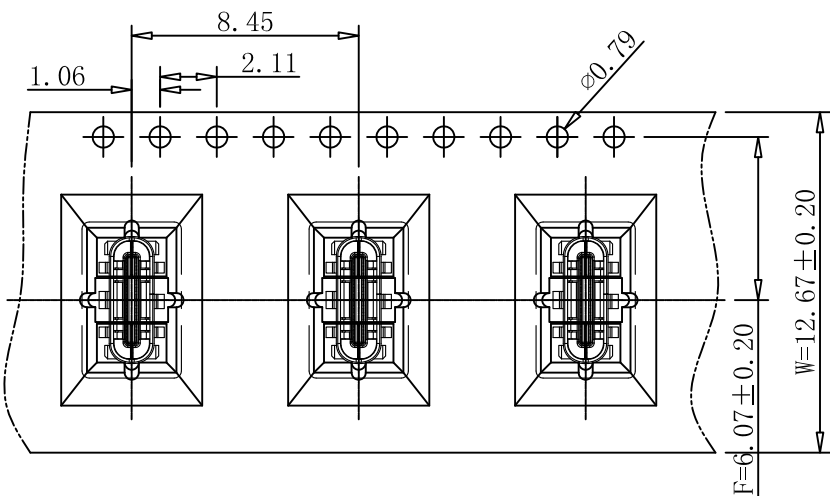
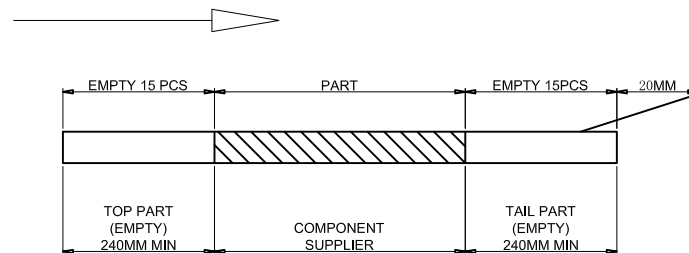
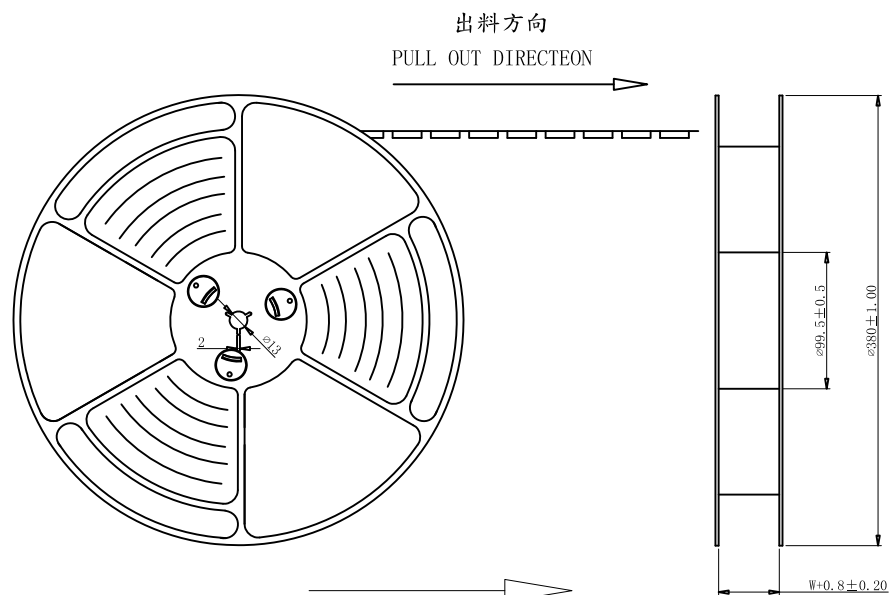

<p>产品图 PRODUCT CHART DWG</p>				<p>深圳市精拓金电子有限公司 Shenzhen Jing Tuo Jin Electronics Co., Ltd.</p>						
<p>公差一览表 TOLERANCE UNLESS OTHERWISE</p>				单位 UNITS	MM	制图 DRAWING	尹先华	制图料号 PRODUCT PART NO.	918-418K2022Y40009	
X.	±0.35	X.	±5°	比例 SCALE	1:1	审核 CHKD	郭治富	产品名称 PRODUCT NO.	TYPE-C3.1母座直立式四脚有柱双排贴片 10.5 LCP黑胶 16PIN	
.X	±0.25	.X	±2°	日期 DATE	2021-04-15	核准 APPD	黄国荣	角法 VIEW	版本 VER	A0
.XX	±0.20	.XX	±1°							
.XXX	±0.10	.XXX	±0.5°							

RoHS

MAPX

MODIFICATION

DRW

DATE

at small positioning hole of the carrier tape side).
 標籤黏貼處 (朝捲裝包材的小定位孔一側)

Location of label sticking (label

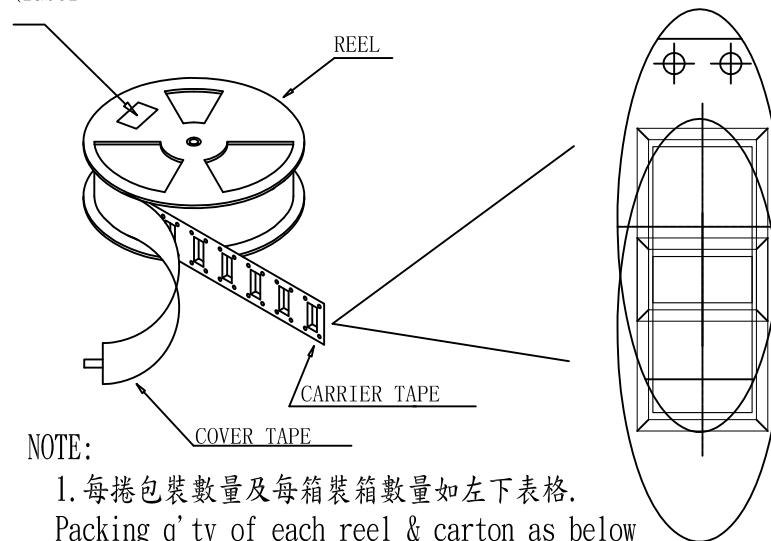
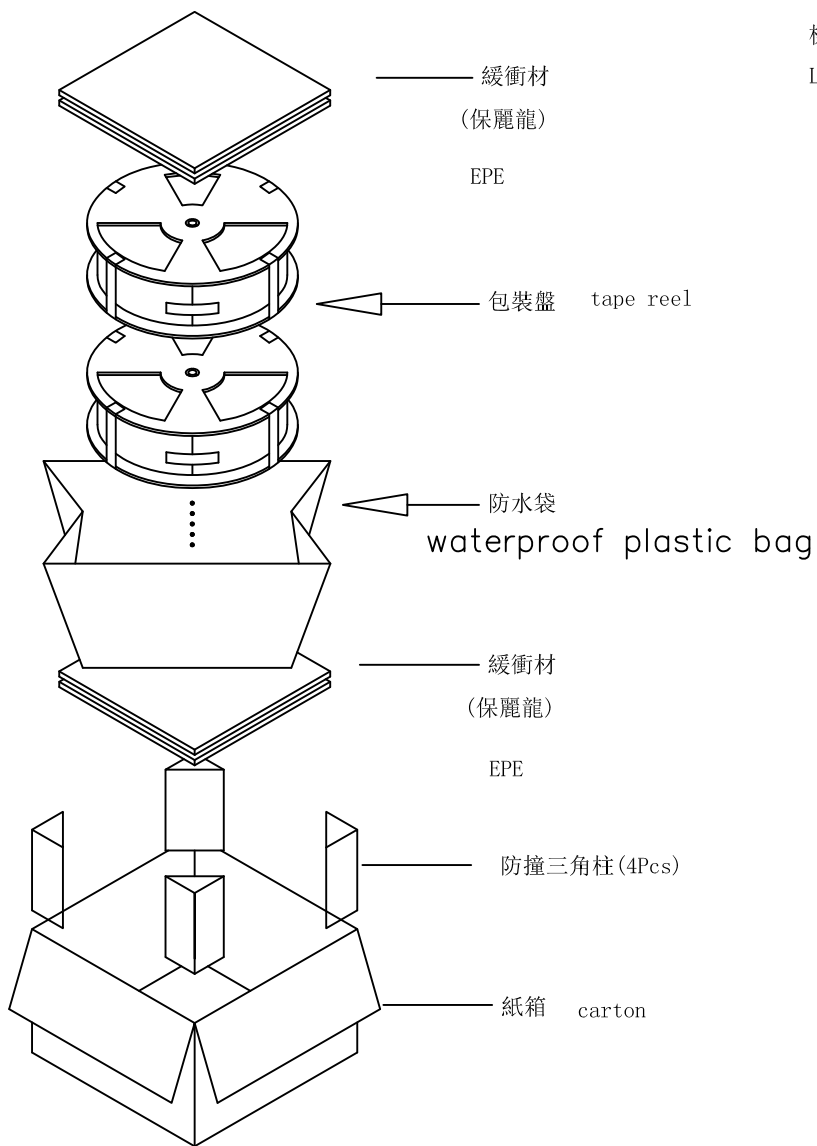

NOTE:

1. 每捲包裝數量及每箱裝箱數量如左下表格。
Packing q'ty of each reel & carton as below table shown.
2. 以上膠帶覆蓋下包裝帶經包裝機熱熔包裝
Use cover tape to cover and hot melt machine to seal up.
3. 每個紙箱放2個珍珠棉
Every carton use 2pcs EPE.
4. 將裝滿產品的卷盤放入紙箱并以膠帶封口
Put reels in the carton and use adhesive tape to seal up.

产品图 PRODUCT CHART DWG				深圳市精拓金电子有限公司 Shenzhen Jing Tuo Jin Electronics Co., Ltd.						
公差一览表 TOLERANCE UNLESS OTHERWISE				单位 UNITS	MM	制图 DRAWING	尹先华	制图料号 PRODUCT PART NO.	918-418K2022Y40009	
X.	±0.35	X.	±5°	比例 SCALE	1:1	审核 CHKD	郭治富	产品名称 PRODUCT NO.	TYPE-C3.1母座直立式四脚有柱双排贴片 10.5 LCP黑胶 16PIN	
.X	±0.25	.X	±2°	日期 DATE	2021-04-15	核准 APPD	黄国荣	角法 VIEW		版本 VER
.XX	±0.20	.XX	±1°							A0
.XXX	±0.10	.XXX	±0.5°							