

MAPX	MODIFICATION	DATE
------	--------------	------

NOTES:

- 1.MATERIAL:
 1.1 HOUSING: HIGH TEMPERATURE THERAL PLASTIC.
 1.2 SPRING CONTACT: COPPER ALLOY.
 1.3 FLAT CONTACT;COPPER ALLOY
 1.4 SHELL :COPPER ALLOY OR IRON.
 1.5 COVER:HIGH TEMPERATURE THERAL PLASTIC.
- 2.FINISH:
 2.1 CONTACT: (SEE P/N.),[50μ"] MIN. NICKEL UNDERPLATING OVER ALL.
 2.2 SHELL: [50μ"] MIN.SOLDERABLITY NICKEL UNDERPLATING OVER ALL.
- 3.PART NUMBER DESCRIPTION :

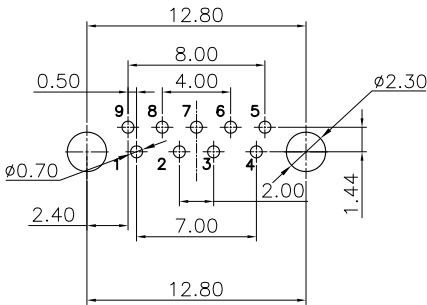

TOLERANCE: ±0.05,
 RECOMMENDED PCB LAYOUT

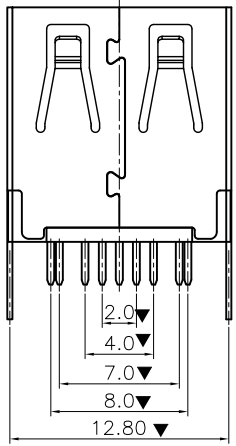
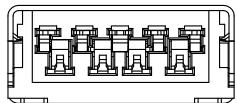
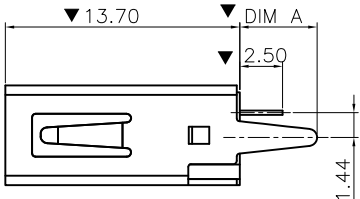
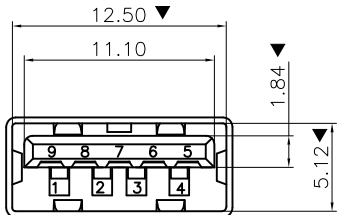
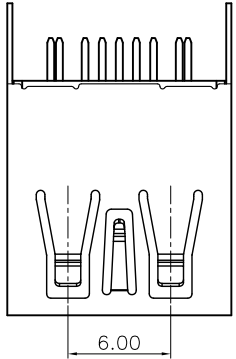

PIN NO.	PIN 1	PIN 2	PIN 3	PIN 4
SLGNL NAME	V BUS	D-	D+	GND
REMARK	USB 2.0 CONTACT PINS			

PIN NO.	PIN 5	PIN 6	PIN 7	PIN 8	PIN 9
SLGNL NAME	STDA_SSRX-	STDA_SSRX+	GND_DRAIN	STDA_SSTX-	STDA_SSTX+
REMARK	USB 3.0 CONTACT PINS				

产品图 PRODUCT CHART DWG		深圳市精拓金电子有限公司							
公差一览表 TOLERANCE UNLESS OTHERWISE		单位	MM	制图	尹先华	制图料号	916-262A2051Y30200		
X.	±0.30	X.	±5°	比例	1:1	审核	郭治富	产品名称	USB AF 3.0 180度13.7直脚无边铜LCP蓝胶
.X	±0.25	.X	±2°	日期	2021-04-14	核准	黄国荣	角法	
.XX	±0.15	.XX	±1°	版本		APPD		VER	AD
.XXX	±0.10	.XXX	±0.5°						